



Thornton Close, Winsford CW7 3RR

welcome to

Thornton Close, Winsford

A well-presented three-bedroom semi-detached home in Winsford, offering generous living space, excellent parking and a good-sized enclosed rear garden, ideal for families or first-time buyers.



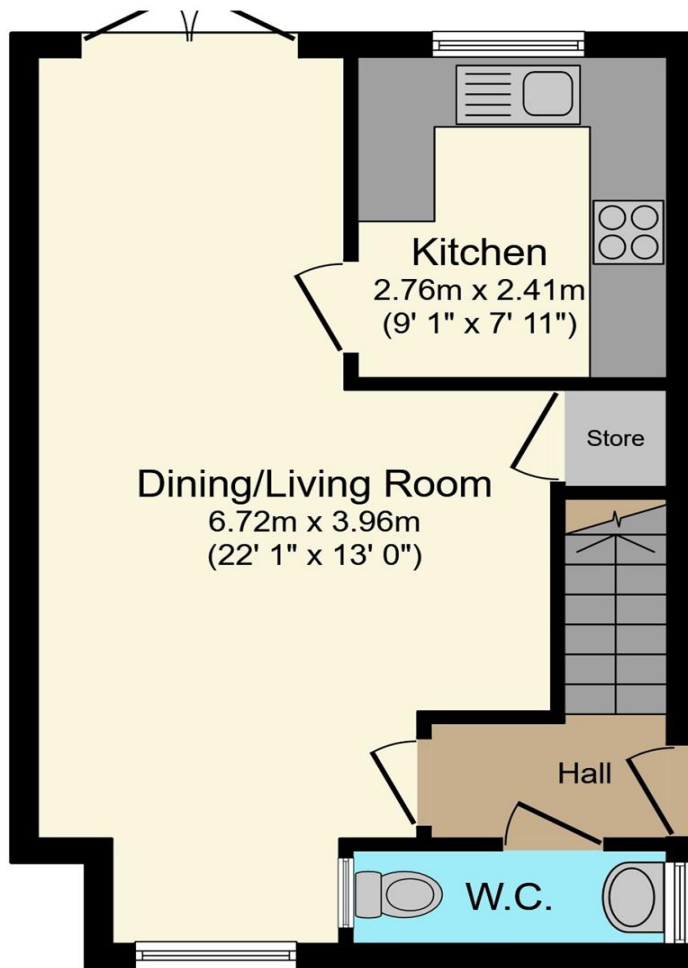

Ground Floor

Floor area 36.8 m² (397 sq.ft.) approx

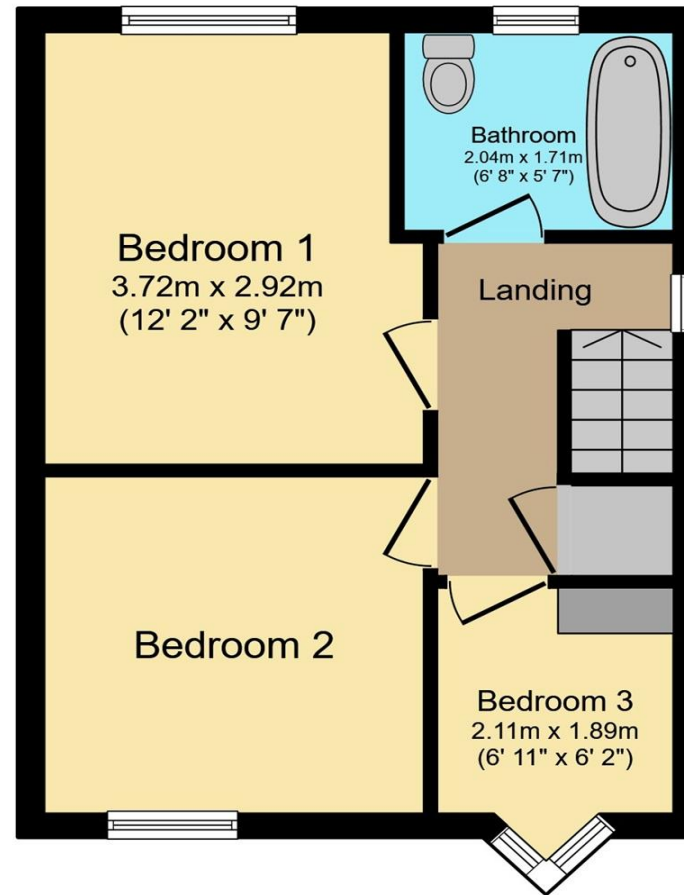

First Floor

Floor area 33.1 m² (356 sq.ft.) approx

Hall

Dining/Living Room

22' 1" x 13' (6.73m x 3.96m)

Kitchen

9' 1" x 7' 11" (2.77m x 2.41m)

W.C.

First Floor

Primary Bedroom

12' 2" x 9' 7" (3.71m x 2.92m)

Bedroom Two

9' 5" x 9' 4" (2.87m x 2.84m)

Bedroom Three

6' 11" x 6' 2" (2.11m x 1.88m)

Family Bathroom

External

Enclosed rear garden is a particularly attractive space, offering a good level of privacy and plenty of room for children to play, pets to roam or for hosting outdoor gatherings. The garden also includes a stylish aluminium pergola, creating a sheltered seating area that can be enjoyed throughout much of the year and adding a contemporary touch to the outdoor space. To the side of the property, there is parking for up to three cars.

Total floor area 69.9 m² (753 sq.ft.) approx

This plan is for illustration purposes only and may not be representative of the property. Plan not to scale.

welcome to

Thornton Close, Winsford

- Three-bedroom semi-detached home
- Ground-floor W.C.
- Well-proportioned kitchen
- Off road parking
- Rear garden

Tenure: Freehold EPC Rating: C
Council Tax Band: B

offers over
£220,000



Please note the marker reflects the
postcode not the actual property

view this property online [swetenhams.co.uk/Property/WSF108865](https://www.swetenhams.co.uk/Property/WSF108865)



Property Ref:
WSF108865 - 0007

1. MONEY LAUNDERING REGULATIONS Intending purchasers will be asked to produce identification documentation at a later stage and we would ask for your co-operation in order that there is no delay in agreeing the sale. 2. These particulars do not constitute part or all of an offer or contract. 3. The measurements indicated are supplied for guidance only and as such must be considered incorrect. Potential buyers are advised to recheck measurements before committing to any expense. 4. We have not tested any apparatus, equipment, fixtures or services and it is in the buyers interest to check the working condition of any appliances. 5. Where an EPC, or a Home Report (Scotland only) is held for this property, it is available for inspection at the branch by appointment. If you require a printed version of a Home Report, you will need to pay a reasonable production charge reflecting printing and other costs. 6. We are not able to offer an opinion either written or verbal on the content of these reports and this must be obtained from your legal representative. 7. Whilst we take care in preparing these reports, a buyer should ensure that his/her legal representative confirms as soon as possible all matters relating to title including the extent and boundaries of the property and other important matters before exchange of contracts.

Swetenhams is a trading name of Sequence (UK) Limited which is registered in England and Wales under company number 4268443, Registered Office is Cumbria House, 16-20 Hockliffe Street, Leighton Buzzard, Bedfordshire, LU7 1GN. VAT Registration Number is 500 2481 05.

swetenhams



01606 593344



Winsford@swetenhams.co.uk



12 Dingle Walk, Winsford Cross Shopping
Centre, WINSFORD, Cheshire, CW7 1BA



[swetenhams.co.uk](https://www.swetenhams.co.uk)