



## Red Anchor Close, SW3

£1,250,000

A wonderful freehold house, available to the market for the first time in nearly 30 years. This property offers two bedrooms, a large reception room and could be extended subject to the usual consents.

Red Anchor Close is private, gated cul-de-sac which contains just seven residential properties built in circa 1950. The King's Road and Chelsea Embankment are both within easy walking distance.

### Features

- Freehold
- Gated Development
- Two Bedrooms
- Private Garden
- Quiet Location
- South Facing Reception

# Red Anchor Close, London, SW3

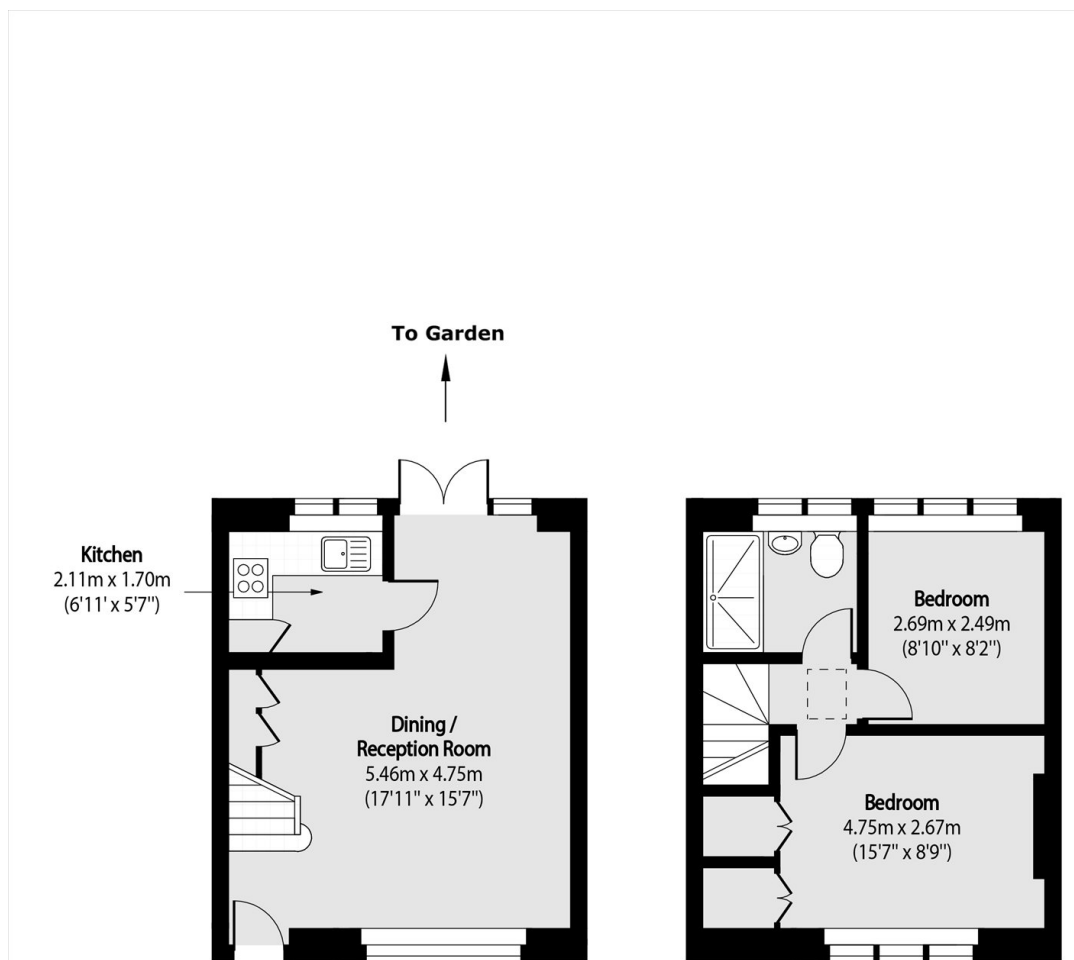

**Ground Floor**

**First Floor**

Total area (approx): 52.49 sq m (565 sq. ft)

Patio total area (approx): 15.88 sq m (171 sq. ft)