



## 42 Barnes Wallis Close

Bowerhill, Melksham, SN12 6UJ

**Guide Price £210,000**

Blueleaf Property is delighted to offer this two bedroom terraced home located on Bowerhill close to local amenities.

The ground floor accommodation comprises of entrance porch, lounge and kitchen dining room with door onto the rear garden. The first floor accommodation comprises two double bedrooms and a family bathroom with bath and shower.

The property further benefits from gas central heating, upvc double glazing, parking, open front garden and an enclosed rear garden.

All room measurements are approx.:

Lounge: 4.3m x 3.9m

Kitchen Dining Room: 3.9m x 3m

Bedroom One: 2.44m x 3.9m

Bedroom Two: 2.58m x 3.9m

Bathroom: 2.12m x 2.06m

- Chain Free
- Two bed terrace
- Enclosed rear garden
- Parking for two cars

### Viewing

Please contact our Blueleaf Property Office on 01225 839050 if you wish to arrange a viewing appointment for this property or require further information.



## Floor Plan

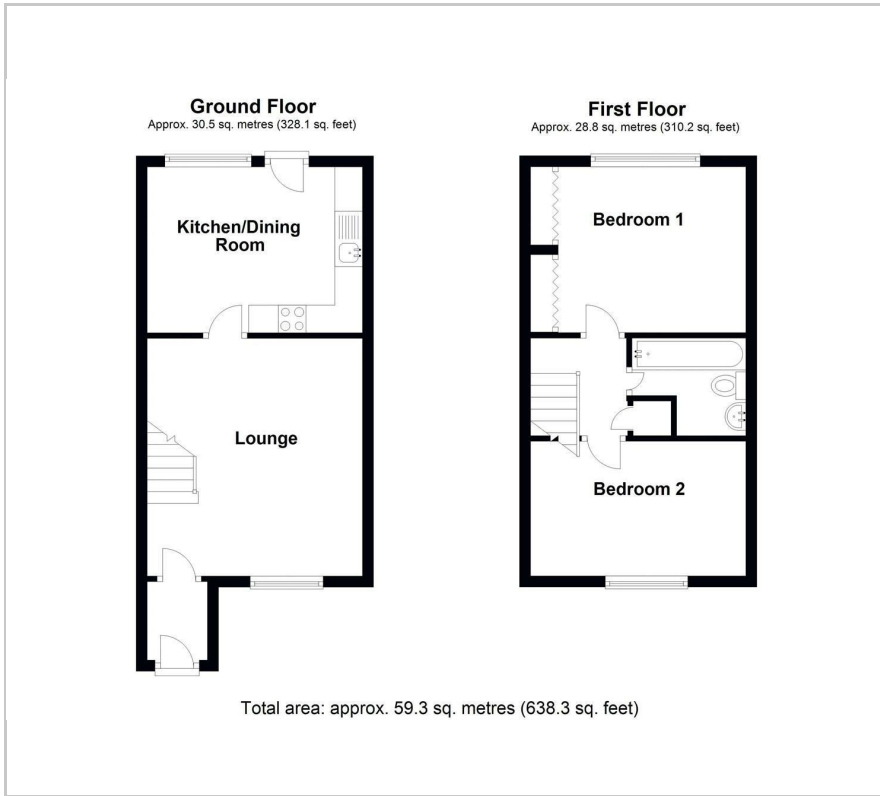

## Area Map



## Energy Efficiency Graph

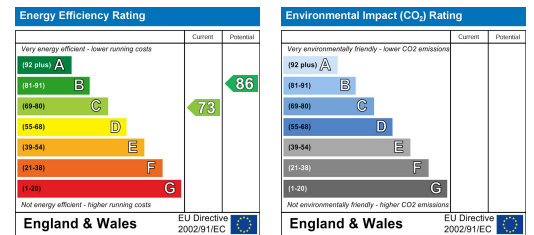

These particulars, whilst believed to be accurate are set out as a general outline only for guidance and do not constitute any part of an offer or contract. Intending purchasers should not rely on them as statements of representation of fact, but must satisfy themselves by inspection or otherwise as to their accuracy. No person in this firm's employment has the authority to make or give any representation or warranty in respect of the property.

Office 4 Stockley Farm, Stockley, Wiltshire, SN11 0NT

Tel: 01225 839050 Email: [hello@blueleafproperty.co.uk](mailto:hello@blueleafproperty.co.uk) <https://www.blueleafproperty.co.uk>