

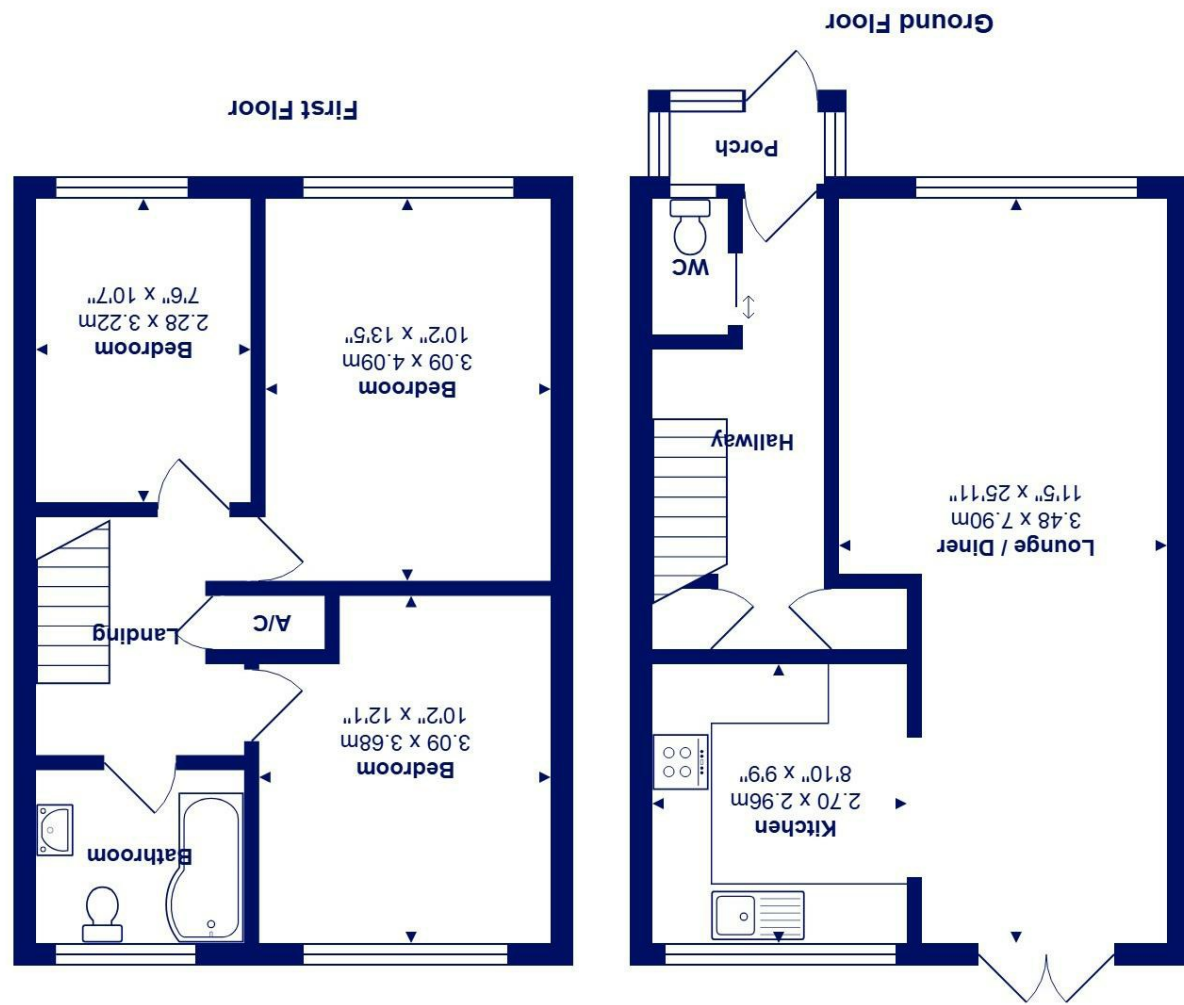

Total Area: 87.8 m<sup>2</sup> ... 945 ft<sup>2</sup>  
All measurements are approximate and for display purposes only



11 Leyside, Christchurch, BH23 3RE

£365,000

**Mitchells**  
1963 — TODAY

A spacious mid-terrace house of approximately 950 sq. ft., featuring three generous bedrooms, first floor family bathroom, downstairs w/c and open plan living accommodation.

The house is situated in this quiet, convenient position with private gardens to the rear and is within easy reach of the local shops, schools and bus routes.

- Mid-terrace house of approximately 950 sq. ft
- Three generous bedrooms
- Refitted first floor family bathroom
- Entrance hall with downstairs w/c
- Spacious lounge diner with patio doors onto the garden
- Modern open plan kitchen
- Driveway parking
- Private rear garden with storage shed
- Convenient position close to local amenities
- uPVC double glazing and Gas fired central heating

EPC Rating Band: C  
Council Tax Band: C  
Freehold

