



 3

Bedrooms

 1

Bathroom



- Town Centre Cottage
- Lounge With Inglenook Fireplace
- Kitchen
- Three Bedrooms
- Bathroom
- Private Roof Terrace
- Small Courtyard
- Gas Central Heating
- New Roof

Wilkinson SLM are delighted to offer for sale a beautifully presented alley cottage located in the heart of Tewkesbury Town Centre with a NEW ROOF and having a wealth of EXPOSED BEAMS and ROOF TERRACE!

From the alleyway the front door opens to the light and bright kitchen with a large window that lets in plenty of natural light. There is a built in oven and hob and space for a fridge freezer, dishwasher and a washing machine. The worksurface is also Silestone! There is also a door at the rear leading to the courtyard which has a small shed at the end. A further door from the kitchen leads to the lounge/dining room. This lovely spacious room has an inglenook fireplace, which would be the perfect back drop to those Christmas settings! Stairs to the first floor are also located off the lounge.

On the first floor is the main bedroom with built in cupboards and a walk through door that leads out to the recently replaced private roof terrace. This is a peaceful and quiet space allowing for great summertime outside entertaining. The bathroom is also on the first floor.

Occupying the second floor are bedrooms two and three with bedroom two having two built in half height wardrobes and bedroom three having a storage cupboard where the boiler is located. Bedroom three is also big enough for a double bed.

Stephens Alley is located in an historic alleyway, just minutes away from shops, pubs and restaurants and beautiful Riverside walks. This home is a much loved property and is a must see to appreciate just what it has to offer!

Lounge/Dining Room 16' 2" x 13' 10" (4.93m x 4.22m)
maximum measurements

Kitchen 16' 4" x 7' 8" (4.98m x 2.34m)

Bedroom One 14' 8" x 8' 11" (4.47m x 2.72m)
To Wardrobes

Roof Terrace 16' 5" x 7' 11" (5.00m x 2.41m)

Bathroom 6' 11" x 5' 4" (2.11m x 1.63m)

Bedroom Two 15' 0" x 8' 8" (4.57m x 2.64m)

Bedroom Three 8' 7" x 7' 0" (2.62m x 2.13m)

First Floor

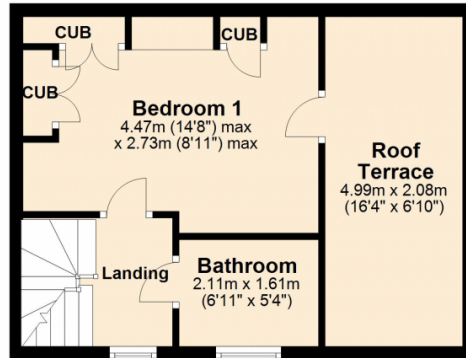

Ground Floor

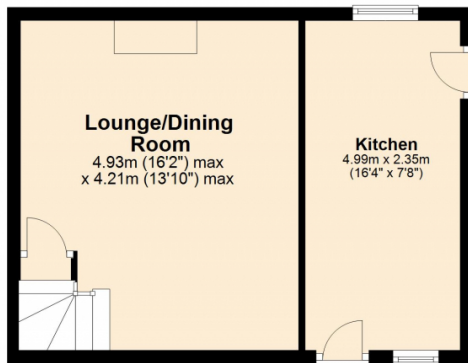

Second Floor

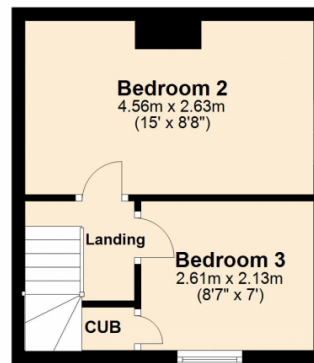

This plan is not to scale and is for guidance only. Produced by PlanUp.
Plan produced using PlanUp.

Energy Efficiency Rating		Current	Potential
Very energy efficient - lower running costs			
(92+)	A		
(81-91)	B		88
(69-80)	C		
(55-68)	D	63	
(39-54)	E		
(21-38)	F		
(1-20)	G		
Not energy efficient - higher running costs			
England, Scotland & Wales		EU Directive 2002/91/EC	

Address: Stephens Alley, Tewkesbury, GL20

