

## Millbrooke Court, SW15

Approx. gross internal area 512 Sq Ft. / 47.6 Sq M

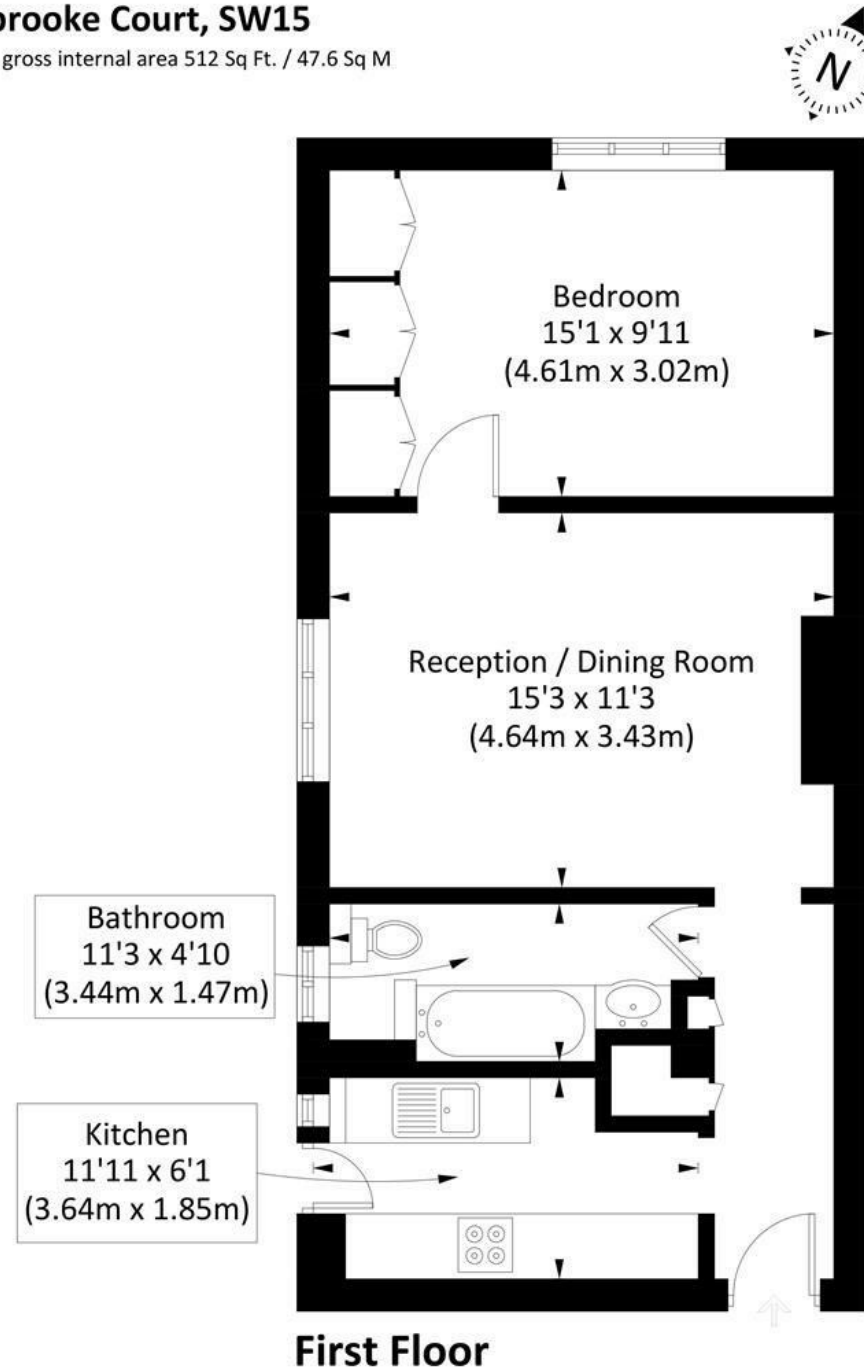

Illustration for identification purposes only, measurements are approximate, not to scale. Fourlabs.co © 2026 (ID1307241)

**DISCLAIMER**•These particulars are intended to give a fair and substantially correct overall description for the guidance of intending purchasers and do not constitute an offer or part of a contract. Prospective purchasers and/or lessees ought to seek their own professional advice.  
 •All descriptions, dimensions, areas, references to condition and necessary permissions for use and occupation and other details are given in good faith and are believed to be correct, but any intending purchasers should not rely on them as statements or representations of fact, but must satisfy themselves by inspection or otherwise as to the correctness of each of them.  
 •All measurements are approximate.



## Millbrooke Court, Putney, SW15

This spacious one double bedroom apartment is situated within a popular Mansion Block, superbly located for East Putney Tube. The furnished accommodation comprises, entrance hall, galley style kitchen, bathroom with shower over bath, spacious living room and large double bedroom with excellent closet space, neutral decor and well presented throughout. The property also benefits from a lovely communal garden area and is just minutes from the Tube and local shops and a short walk to the High Street and River. The property also benefits from the hot water and some of the heating being included in the rent. Available now.



- ONE BEDROOM MANSION FLAT
- FITTED KITCHEN
- SMART BATHROOM
- CLOSE TO HIGH STREET
- EPC E
- RECEPTION
- DOUBLE BEDROOM
- SECONDS FROM TUBE STATION
- HOT WATER INCLUDED
- COUNCIL TAX BAND D

Per Calendar Month  
**£1,850 Per Calendar Month**

