



## Sandringham Road, NW2

### Leasehold - £299,950

CASH BUYERS ONLY – SHORT LEASE SALE. A bright and spacious two double bedroom purpose built maisonette with its own private section of garden. These maisonettes are double fronted which offers great light and lateral layout.

Offering good proportioned rooms throughout, a reception room, large kitchen diner which opens out onto the garden, two good size bedrooms, a family bathroom and a good 23ft private garden.

Located on Sandringham Road, Willesden Green offering an excellent array of social and transport amenities to include 94 acre Gladstone Park, with its outdoor gym, tennis courts and café, Walm Lane offers some lovely bars and restaurants along with Willesden Green (Jubilee zone 2) and Dollis Hill (Jubilee zone 2). There is a main Sainsburys on Willesden High Road and an excellent 24 hour bus service in to Central London.

- 2 bedroom purpose built maisonette
- Cash buyers only- short lease
- Close to excellent transport links
- COUNCIL: Brent (C)

020 7328 2828

[enquiries@cameronsstiff.co.uk](mailto:enquiries@cameronsstiff.co.uk)

[cameronsstiff.co.uk](http://cameronsstiff.co.uk)



## Sandringham Road, London, NW2

Approximate Area = 669 sq ft / 62.2 sq m (Exclude store)

Limited Use Area(s) = 10 sq ft / 0.9 sq m

Total = 679 sq ft / 63.1 sq m

For identification only - Not to scale

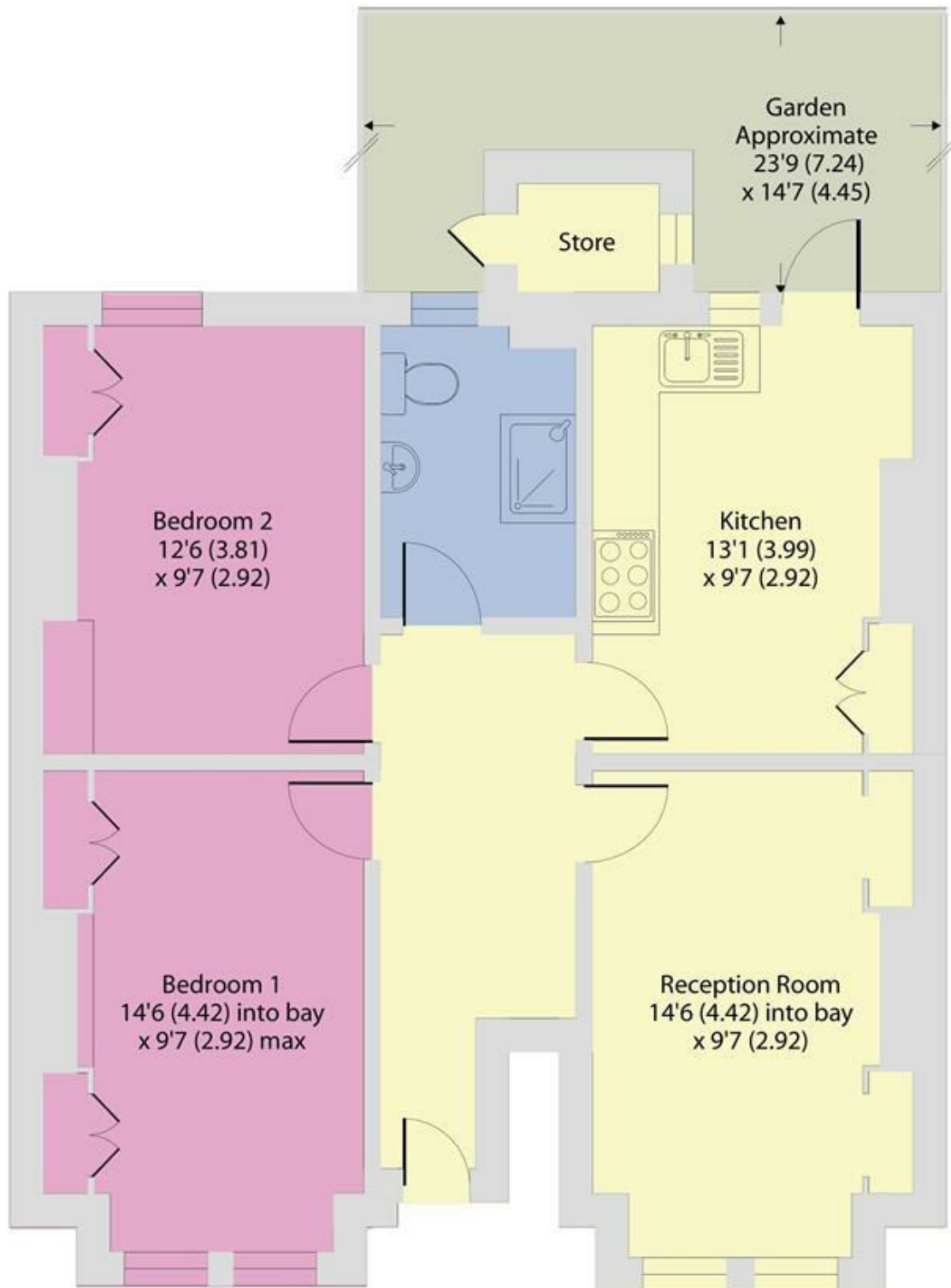

GROUND FLOOR

EPC: D

Ref: 19233141



Floor plan produced in accordance with RICS Property Measurement 2nd Edition, Incorporating International Property Measurement Standards (IPMS2 Residential). © nichecom 2025. Produced for Camerons Stiff & Co. REF: 1305494

