



# Holywell Gutter Lane, Tupsley, Hereford

Guide Price £775,000

4 3 3



- Spacious Detached Executive Home
- Open Plan Kitchen, Dining & Family Room
- Backing Onto Playing Fields
- Sought-After Tupsley Location
- 4 Double Bedrooms; 2 Ensuites
- Over 2,500 sq.ft Living Space
- Nestled at the End of Quiet Cul-De-Sac
- Beautifully Presented Throughout



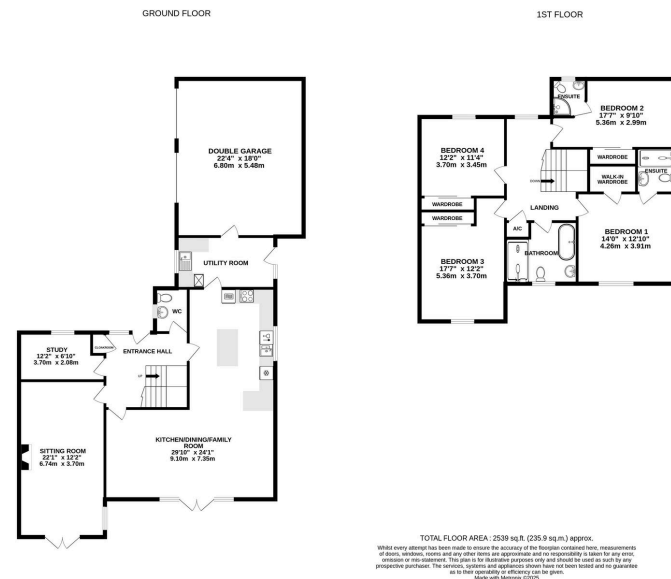

A Spacious, Imposing 4 Double Bedroom Detached Home, in a private position at the end of Holywell Gutter Lane, in Tupsley, Hereford. Offering over 2,500 sq.ft of family living with a large driveway, double garage, and gardens backing onto playing fields.

Tucked away at the end of Holywell Gutter Lane in a peaceful cul-de-sac, this modern executive home offers over 2,500 sq. ft of beautifully presented living space. At its heart is an impressive open plan kitchen, dining and family room, complemented by two further reception rooms that provide versatility for everyday living or entertaining.

