



## Belsize Road, NW6

£750,000

An exceptional two bedroom garden flat set within an attractive Victorian conversion, benefiting from its own private entrance and an abundance of character throughout.

Superbly positioned in South Hampstead, Belsize Road is within easy reach of Swiss Cottage, West Hampstead and St John's Wood, all offering an excellent selection of cafés, restaurants and local amenities. The area is exceptionally well connected, with South Hampstead Overground alongside nearby Jubilee, Metropolitan and Thameslink services. Primrose Hill, Regent's Park and Hampstead Heath are also all within close proximity.

### Features

- Two Double Bedrooms
- Own Entrance
- Victorian Conversion
- Two Bathrooms
- Open Plan
- Private Garden



## Belsize Road, NW6

The property features a stunning open plan kitchen and reception room, creating a great sociable living space with doors opening directly onto a private garden perfect for entertaining and indoor outdoor living. The German kitchen is finished to a high specification and includes integrated appliances and a wine fridge.

Both bedrooms are generously proportioned and served by two contemporary bathrooms, each with luxurious underfloor heating, combining modern comfort with elegant design.



# Belsize Road, London, NW6

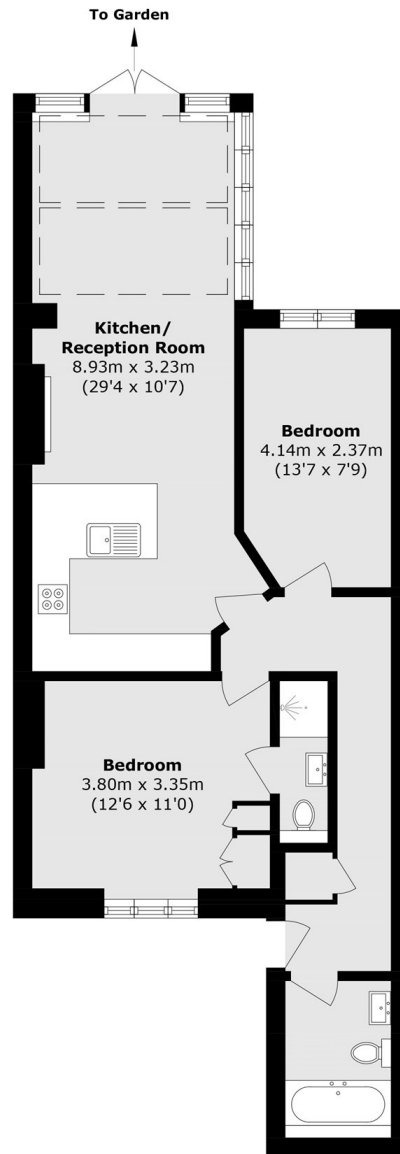

Total area (approx.): 69.2 sq. m (744.9 sq. ft)