

All measurements are approximate and for display purposes only.

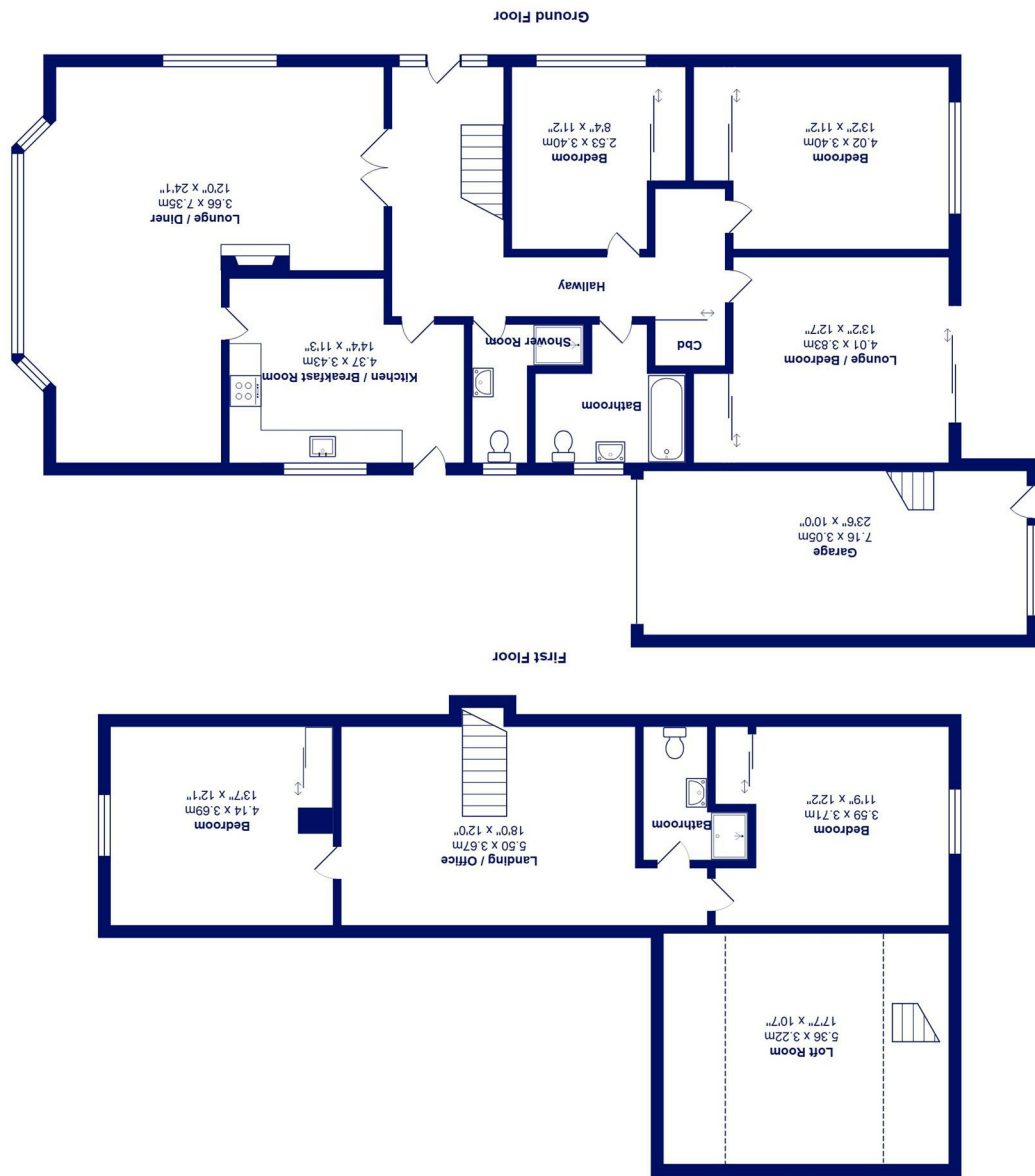

10 Waterford Gardens, Highcliffe On Sea, BH23 5DP

£875,000

Mitchells
1963 — TODAY

A superbly located chalet style home of about 2000 sq ft, on the south side of the Lymington Road and betwixt the bustling village centre and the beach. Presented in excellent order and with far more accommodation than you would envisage from the outside, the property is bright and airy with large room sizes, perfect for either family or retirement living.

Often chalet style homes feel restricted upstairs but here, there is a fantastic large landing with large skylight windows with both bedrooms being very roomy with excellent head height and useable floor area. The ground floor features a brilliant L shaped lounge/dining room with an outlook to the front whilst one of the ground floor bedrooms is being used as a sitting room leading onto the garden.

- Quality detached chalet in a prestigious location right by the cliff top and beach with the shops a short stroll away
- Up to five double bedrooms with two modern bath/shower rooms
- Very nicely fitted kitchen/breakfast room with some integrated appliances
- Lots of off road parking with generous garaging and private rear garden
- Potential for further conversion of the remaining loft area (subject to planning)
- Gas fired central heating and UPVC double glazing, neutral decor throughout and very well maintained
- Quiet, tucked away position in a no through road within sight and sound of the sea
- Wonderful coastal walks on your doorstep with easy access to the beach below and all the local amenities on the High Street close to hand

EPC Rating Band: C
Council Tax Band: E
Freehold

Successful buyers will be required to complete online identity checks provided by Lifetime Legal. The cost of these checks is £45 inc. VAT per purchase which is paid in advance, directly to Lifetime Legal. This check verifies your identity in line with our obligations as stipulated by our regulatory body, HMRC

