



2 Bed
Flat
located in

£1,475



TAYLOR
MICHAEL

Chesham Street, Brighton, BN2 1NA

Approximate Gross Internal Area = 67.2 sq m / 723 sq ft



DIRECTIONS

CONTACT

62 Church Road
Hove
East Sussex
BN3 2FP

E: lettings@taylormichael.agency
T: 01273 600100
<https://taylormichael.agency/>

TAYLOR
MICHAEL

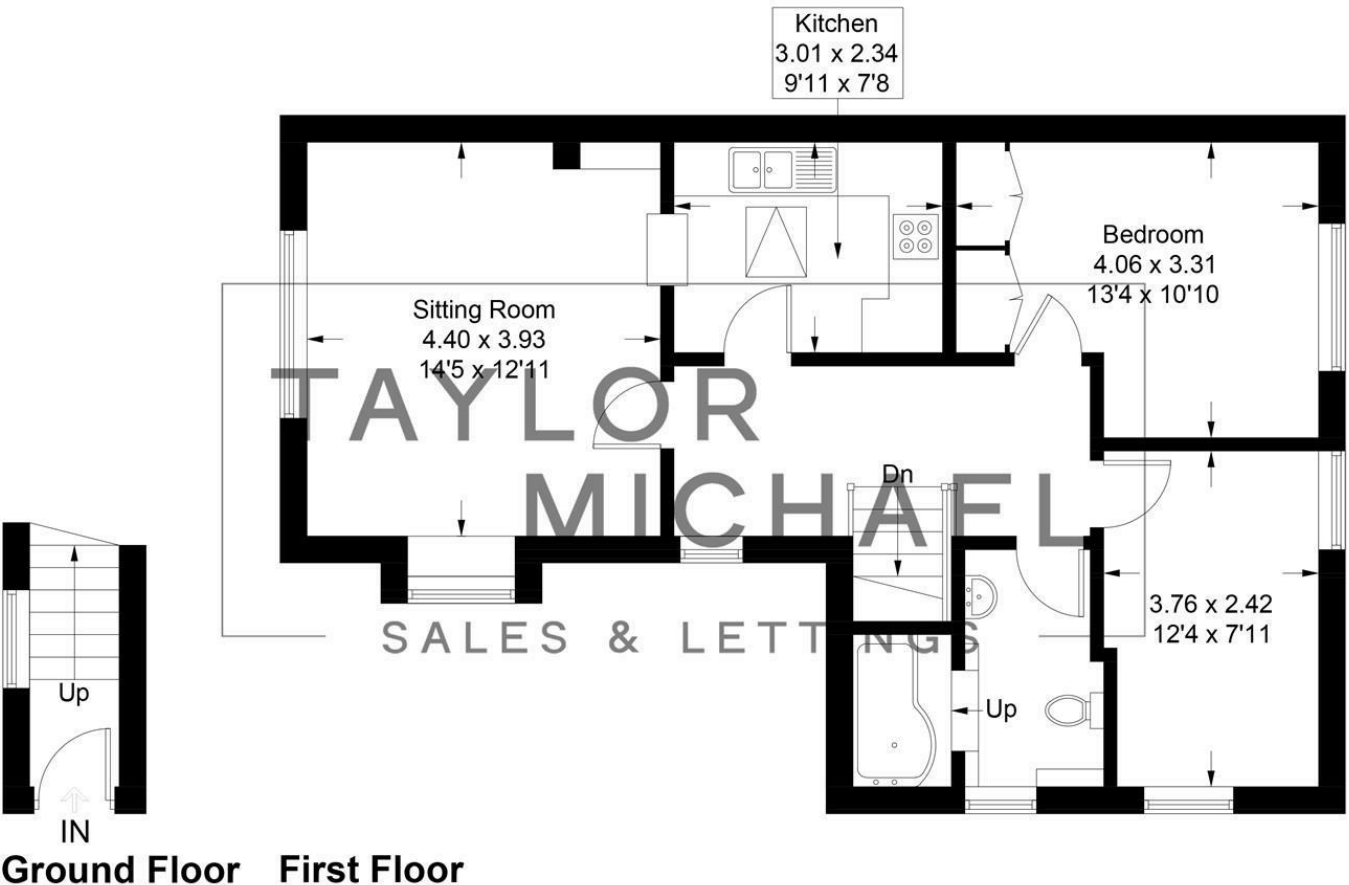

Illustration for identification purposes only, measurements are approximate, not to scale.
Imageplansurveys @ 2026

