



19 Boythorpe Avenue, Boythorpe, Chesterfield, S40 2QE

Offers In The Region Of £190,000

- Off street parking
- Low maintenance garden area
- New electric consumer unit fitted 2023
- Hot and cold tap in the garden
- 3 Double bedrooms
- New roof fitted 2023
- Great location close to Chesterfield town centre and Queens park
- Kitchen diner
- New combi boiler fitted 2024
- Ideal for young couples/downizers



**19 Boythorpe Ave,
Chesterfield, ENG, S40
2QE, GB**

CREATED ON
2025-08-01

LOCATION
19 Boythorpe Avenue
S40 2QE Chesterfield
England
GB

DETAILS
Total area: 93.08 m²
Living area: 91.85 m²
Floors: 3
Rooms: 9

Square Box Media
info@squareboxmedia.com
www.squareboxmedia.com

THIS FLOORPLAN IS PROVIDED WITHOUT WARRANTY OF ANY KIND. SQUAREBOX MEDIA DISCLAIMS ANY WARRANTY INCLUDING, WITHOUT LIMITATION, SATISFACTORY QUALITY OR ACCURACY OF DIMENSIONS.

0.0 0.5 1.0 1.5 2.0m
1:59

▼ **Ground Floor**

TOTAL AREA: 34.38 m² · LIVING AREA: 33.15 m² · ROOMS: 2

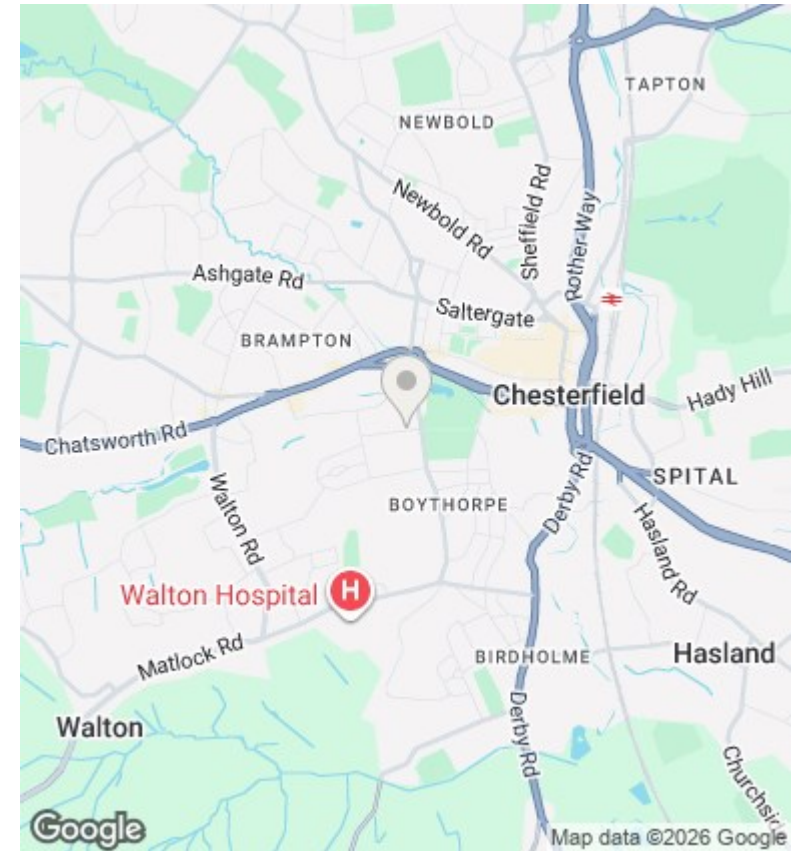
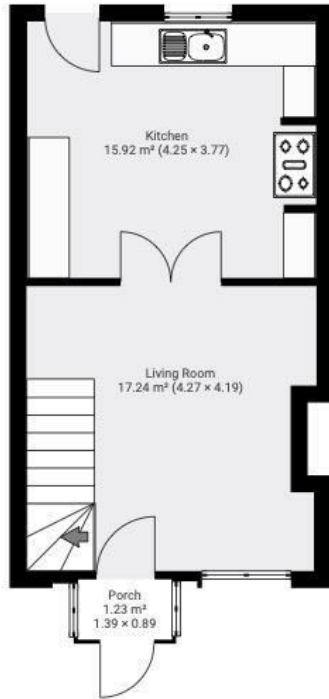

Directions

Viewings

Viewings by arrangement only. Call 01246 276 276 to make an appointment.

Council Tax Band

C

EPC Rating:

D

Energy Efficiency Rating		Current	Potential
<i>Very energy efficient - lower running costs</i>			
(92 plus) A			
(81-91) B			
(69-80) C			77
(55-68) D		62	
(39-54) E			
(21-38) F			
(1-20) G			
<i>Not energy efficient - higher running costs</i>			
England & Wales		EU Directive 2002/91/EC	