

Findon Road, Wisewood, Sheffield, S6 4WP

Offers In Region Of £260,000

3 1 1



Occupying a generous plot within the ever-popular Wisewood area of Sheffield is this beautifully presented three bedroom semi-detached home, offering spacious accommodation, plenty of off road parking and excellent outdoor space.

Sales | Lettings | New Homes

VAT Reg Number: 191 3588 84
 Company Reg Number: 05610489
 Company Reg Address: 67 Middlewood
 Road, Hillsborough, Sheffield, S6 4GX.

The MorfittSmith Building
 67 Middlewood Road
 Hillsborough
 Sheffield
 S6 4GX

Get in touch - arrange an appointment



0114 232 1764



sales@morfittsmith.co.uk
 lettings@morfittsmith.co.uk
 newhomes@morfittsmith.co.uk



www.morfittsmith.co.uk



@MorfittSmith



@MorfittSmith



MorfittSmith
 Estate & Letting Agent

Key Features

-
-
-
-
-
-

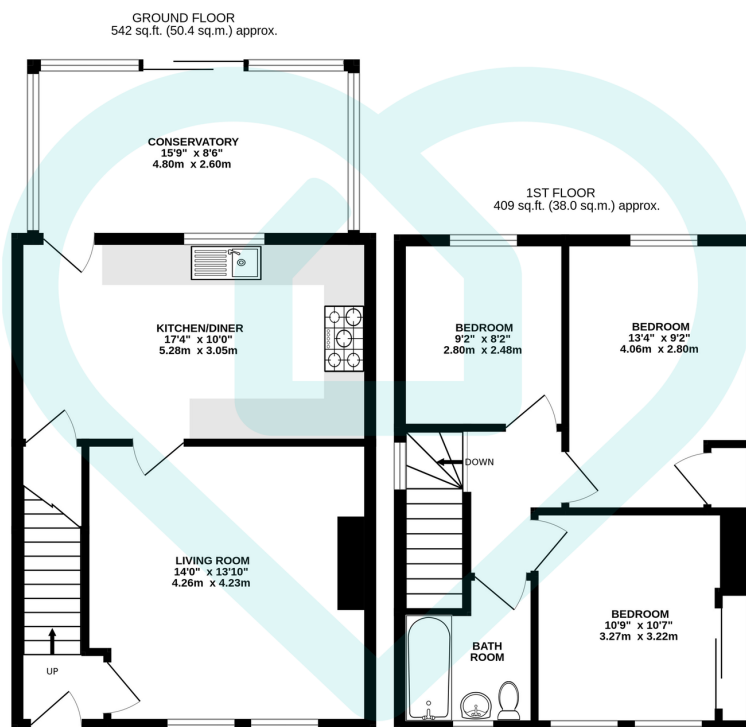

TOTAL FLOOR AREA : 951 sq.ft. (88.3 sq.m.) approx.

This floor plan is for illustrative purposes only. All measurements and layouts are approximations and do not necessarily capture the precise specifications of the property. No responsibility is taken for any error, omission, or misstatement. We always recommend viewing in person to confirm the exact floor plan of a property. Made with Metropix.



Sales | Lettings | New Homes

VAT Reg Number: 191 3588 84
Company Reg Number: 05610489
Company Reg Address: 67 Middlewood Road, Hillsborough, Sheffield, S6 4GX.

The MorfitSmith Building
67 Middlewood Road
Hillsborough
Sheffield
S6 4GX

Get in touch - arrange an appointment

0114 232 1764
sales@morfitSmith.co.uk
lettings@morfitSmith.co.uk
newhomes@morfitSmith.co.uk
www.morfitSmith.co.uk

@MorfitSmith
@MorfitSmith
MorfitSmith
Estate & Letting Agent