

HS HAIR & SON



London Road , Leigh-on-Sea SS9 2QP

- FIRST FLOOR FLAT
 - LOUNGE
 - BATHROOM WITH SHOWER OVER BATH
- GAS CENTRAL HEATING AND DOUBLE GLAZING THROUGHOUT
- ALL APPLICANTS MUST BE IN FULL TIME EMPLOYMENT WITH A HOMEOWNING GUARANTOR
- TWO DOUBLE BEDROOMS
- KITCHEN WITH OVEN AND HOB
 - NO PARKING
- NO PETS AND NO SHARERS
- CALL TO VIEW NOW!

£1,100 PCM



Local Authority **Southend on Sea Borough Council**
Council Tax Band **B**
EPC Rating

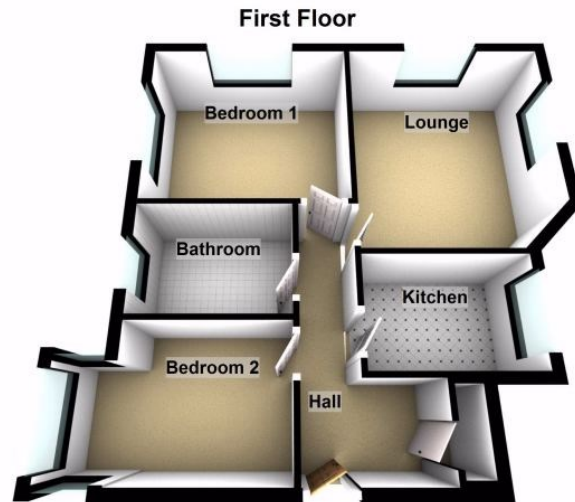

Lettings Office

190 London Road, Southend-On-Sea,
Essex, SS1 1PJ

Contact

01702 34 11 77
lettings@hairandson.co.uk
<https://hairandson.co.uk/>

Agents Note: Whilst every care has been taken to prepare these particulars, they are for guidance purposes only. All measurements are approximate and for general guidance purposes only and whilst every care has been taken to ensure accuracy, they should not be relied upon and potential buyers/tenants are advised to recheck the measurements.