

KAREN PARKS
SALES & LETTINGS



4 The Gowery Church Road

Formby, Liverpool, L37 8BG

£990



4 The Gowery Church Road

Formby, Liverpool, L37 8BG

£990





Road Map



Hybrid Map



Terrain Map



Floor Plan

The Gowery, Formby Total Approx. Floor Area 672 Sq.ft. (62.47 Sq.M.)

Surveyed and drawn by Lens Media for illustrative purposes only. Not to scale. Whilst every attempt was made to ensure the accuracy of the floor plan, all measurements are approximate and no responsibility is taken for any error.

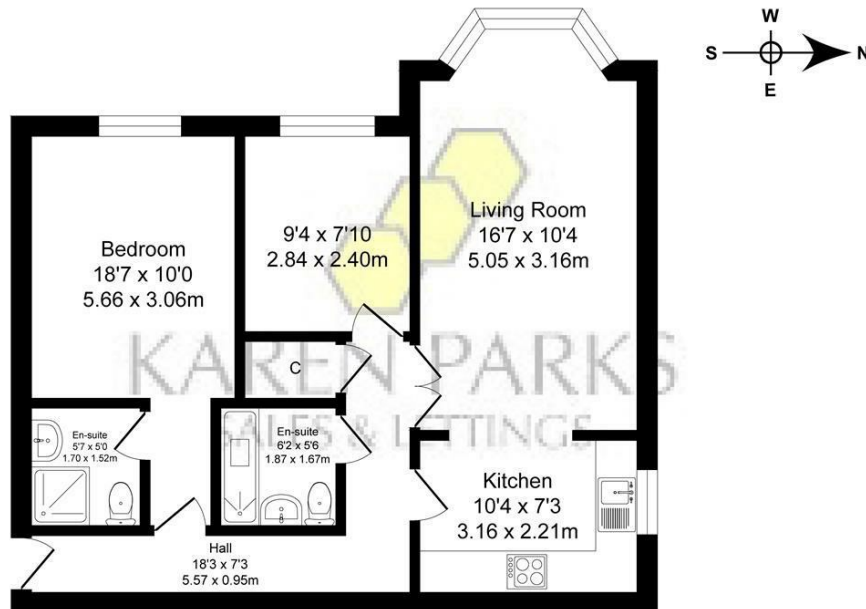

Ground Floor
Approx. Floor
Area 672 Sq.Ft
(62.4 Sq.M.)

Viewing

Please contact our Formby Office on 01704 835780 if you wish to arrange a viewing appointment for this property or require further information.

Energy Efficiency Graph

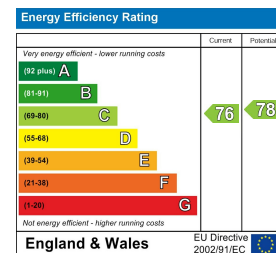

These particulars, whilst believed to be accurate are set out as a general outline only for guidance and do not constitute any part of an offer or contract. Intending purchasers should not rely on them as statements of representation of fact, but must satisfy themselves by inspection or otherwise as to their accuracy. No person in this firm's employment has the authority to make or give any representation or warranty in respect of the property.