



Colmore House

Frazer Nash Close, Isleworth, TW7
£300,000

Situated in the popular Frazer Nash Close development, this well presented one bedroom first floor apartment with private terrace is offered to the market with no forward chain.

Council Tax band: C

Tenure: Leasehold

EPC Energy Efficiency Rating: B

EPC Environmental Impact Rating: B

- No Forward Chain
- Well Presented
- Ample Internal Storage
- Long Lease
- Close to Train Station
- Spacious Private Terrace

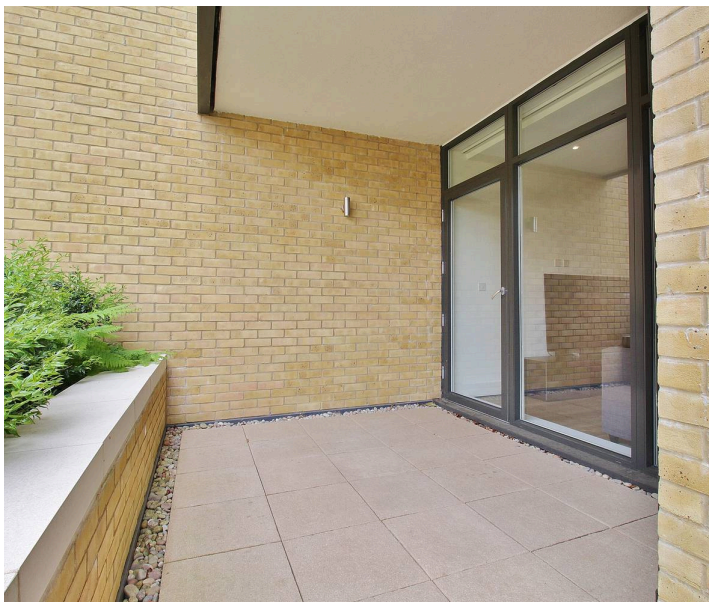

SCAN HERE
FOR
PROPERTY
DETAILS



539 sq.ft. (50.1 sq.m.) approx.

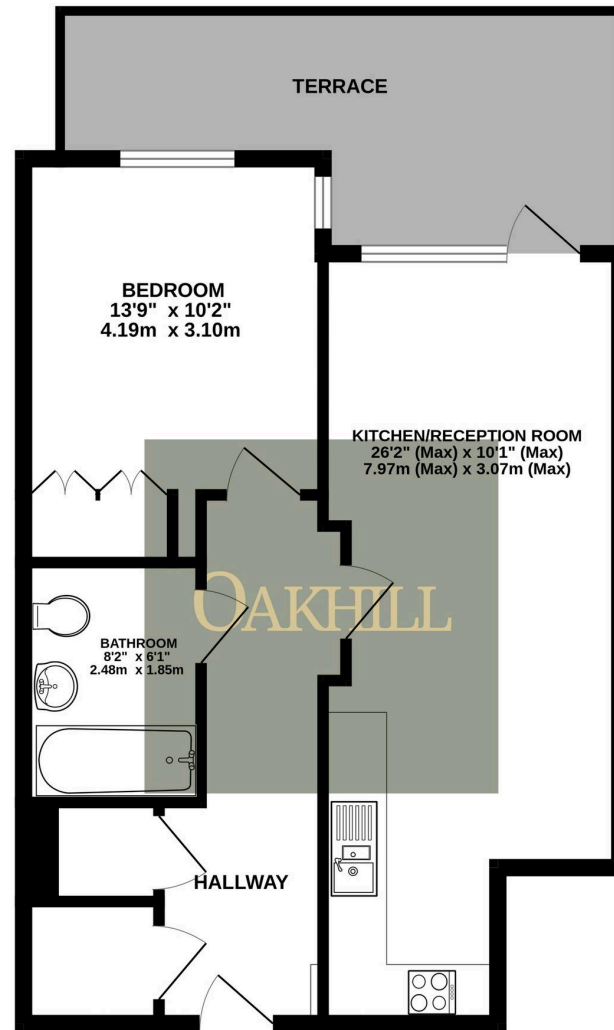

TOTAL FLOOR AREA : 539 sq.ft. (50.1 sq.m.) approx.

Whilst every attempt has been made to ensure the accuracy of the floorplan contained here, measurements of doors, windows, rooms and any other items are approximate and no responsibility is taken for any error, omission or mis-statement. This plan is for illustrative purposes only and should be used as such by any prospective purchaser. The services, systems and appliances shown have not been tested and no guarantee as to their operability or efficiency can be given.
Made with Metropix ©2025