



ST. JAMES'S DRIVE, SW17

£425,000

- One bedroom
- Private garden
- Share of freehold
- Chain free
- Central location
- Energy rating: D





ABOUT THE HOME

A one bedroom garden flat located just by Wandsworth Common. The property is sold with a share of the freehold and is available with no onward chain.

St. James' Drive is located just off Bellevue Road and Wandsworth Common providing residents with easy access to the parade of shops, bars and restaurants overlooking the Common. There are a number of transport links within close proximity including the Northern Line via Balham and Tooting Underground as well as the Southern Railway via Wandsworth Common.





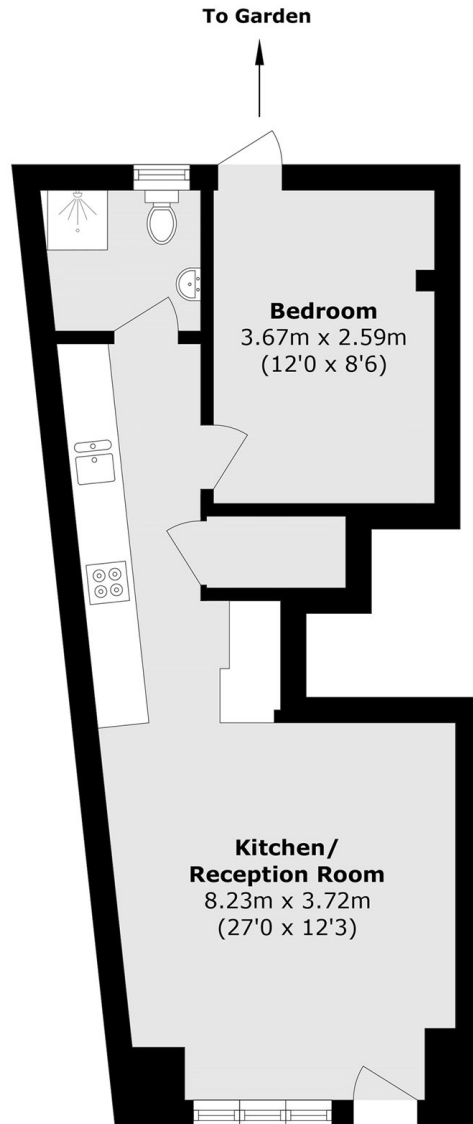

Total area (approx.): 40.3 sq. m (433.7 sq. ft)

JACKSONS BALHAM

8-11 Balham Station Road,
London, SW12 9SG
Sales: 020 8675 6555
Lettings: 020 8675 6565

Energy Rating: We aim to make our particulars both accurate and reliable. However they are not guaranteed; nor do they form part of an offer or contract. If you require clarification on any points then please contact us, especially if you're traveling some distance to view. Please note that appliances and heating systems have not been tested and therefore no warranties can be given as to their good working order.