

ARDEN & WAY

BLOCK MANAGEMENT & LETTINGS



51 St. Leonards Avenue

, Hayling Island, PO11 9BN

£2,500 Per month

Available To Rent – Stunning Four Double-Bedroom Detached Home, Hayling Island

This beautifully presented four double-bedroom detached home offers spacious and modern family living in the heart of Hayling Island, just a short walk from Mengham's excellent range of amenities including shops, a pharmacy, doctors surgery, dentist, and well-regarded schools.

The property is approached via a generous shingle driveway providing ample off-road parking for several vehicles. Inside, a welcoming entrance hall leads to a bright sitting room featuring a bay window and electric fireplace. The impressive open-plan kitchen/dining room is fitted with integrated Miele appliances, a central island, and extensive storage, creating a fantastic space for everyday living and entertaining. This flows seamlessly into a sunroom with a large skylight and French doors opening onto the garden.

The ground floor also benefits from a separate office/study room, and an additional storage room with external access.

Upstairs are four generously sized double bedrooms. The principal bedroom features built-in wardrobes and a stylish en-suite shower room, while the contemporary family bathroom includes both a bath and separate corner shower.

Outside, the west-facing rear garden enjoys afternoon and evening sunshine and offers a patio area ideal for dining.

Viewing

Please contact our Arden & Way Office on 02392 460 899 if you wish to arrange a viewing appointment for this property or require further information.



Floor Plan

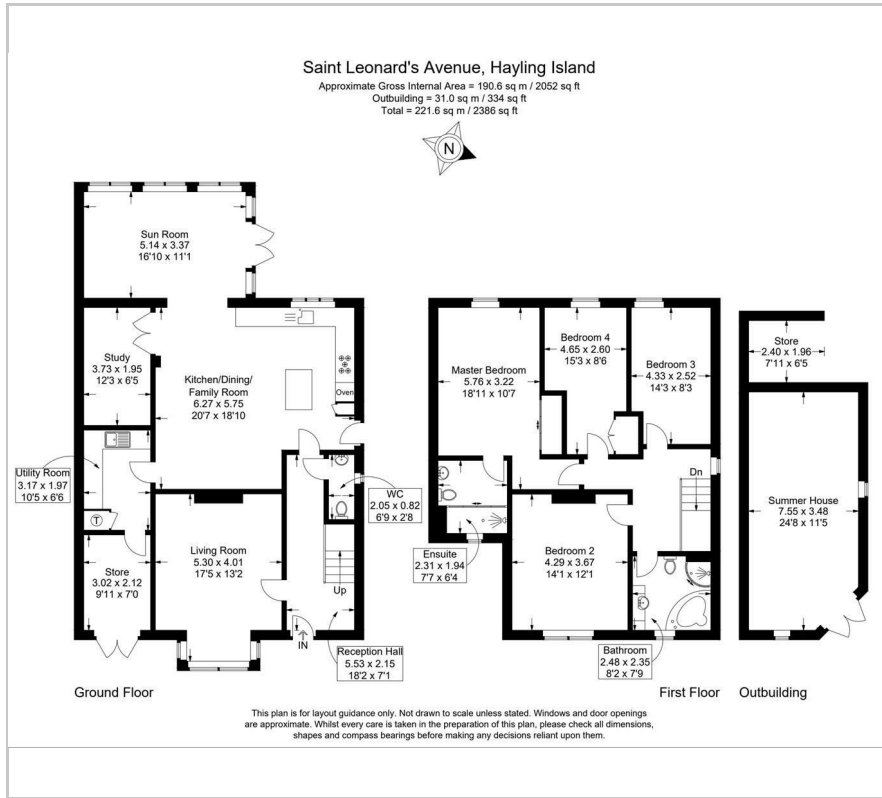

Area Map



Energy Efficiency Graph



These particulars, whilst believed to be accurate are set out as a general outline only for guidance and do not constitute any part of an offer or contract. Intending purchasers should not rely on them as statements of representation of fact, but must satisfy themselves by inspection or otherwise as to their accuracy. No person in this firm's employment has the authority to make or give any representation or warranty in respect of the property.

120 Elm Grove, Hayling Island, Hampshire, PO11 9EH

Tel: 02392 460 899

Email: info@ardenway.co.uk

www.ardenway.co.uk