

linkagency



Dempster Avenue, Goole, Goole
£149,000



52 Dempster Avenue

DN14 5RZ, Goole

- Recently modernised
- No onward chain
- Quiet location with many families nearby
- Rural surroundings
- On the outskirts of the Port & Town of Goole
- No onwards chain
- Easy access for the M62 at junction 36
- Downstairs w.c cloakroom

On Dempster Avenue, Old Goole, this charming post-war terraced house offers a delightful blend of modern living and classic comfort. Offering 899 square feet of floor space, the property features three bedrooms.

With a bright and inviting lounge to the front, perfect for relaxation or entertaining guests. The modern decor throughout the home enhances its appeal, creating a warm and stylish atmosphere. The contemporary kitchen is equipped with modern appliances. The bathroom has also been tastefully recently updated.

With enclosed gardens both at the front and rear, offering a pleasant outdoor retreat for gardening enthusiasts or a safe play area for children. The quiet location in Old Goole is particularly appealing, as it is surrounded by other well-cared-for properties, fostering a sense of community and peace.

This terraced house is not only in good condition but also represents a wonderful opportunity to own a home in a family friendly area. With its modern amenities and charming character, this property is sure to attract those looking for a comfortable and stylish living space. Do not miss the chance to make this lovely house your new home.



Location and EPC Graph



Energy Efficiency Rating

	Current	Potential
Very energy efficient - lower running costs		
(92 plus) A		
(81-91) B		
(69-80) C		
(55-68) D		
(39-54) E		
(21-38) F		
(1-20) G		
Not energy efficient - higher running costs		
England & Wales	EU Directive 2002/91/EC 	



Extra Info

Council tax band: A

To arrange a viewing please register your interest on our website via the tenancy application.

For additional information please contact our office on 01405 768401 or email: enquiries@linkagency.co.uk

Floorplan

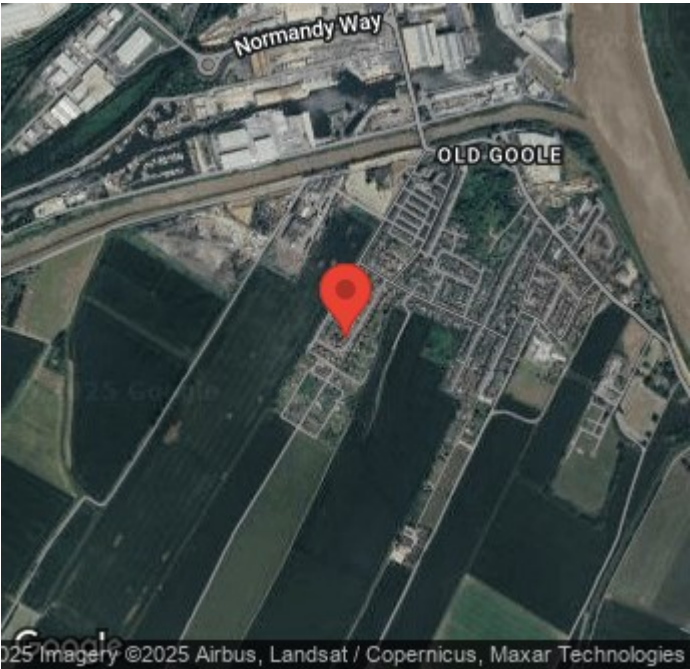

Ground Floor

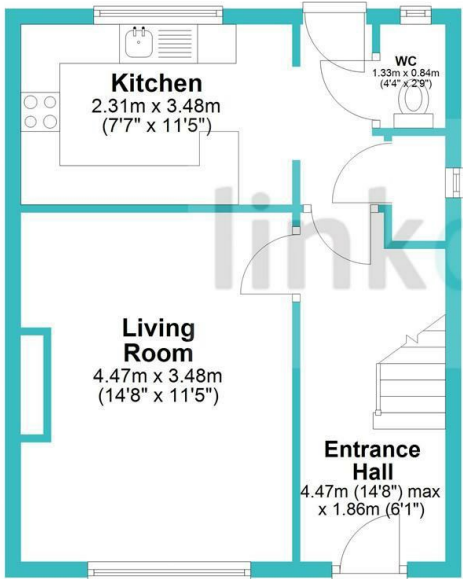

First Floor

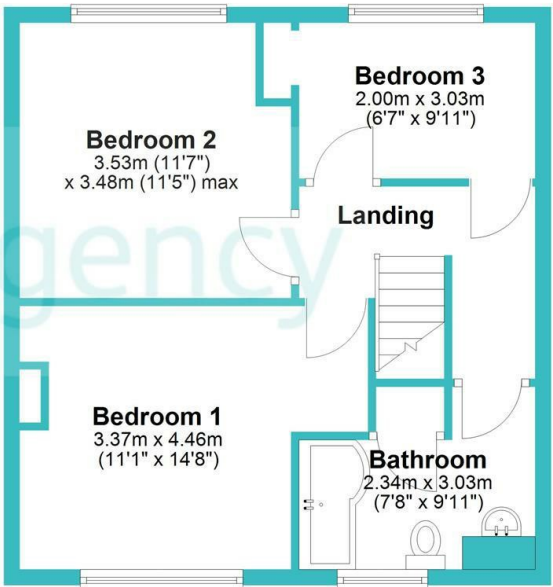

Total area: approx. 83.6 sq. metres (899.5 sq. feet)