

2  
BED

# Cottage Style Semi Detached Bungalow

56, Cairo Avenue, Peacehaven, BN10 7PX



Price £279,950

Freehold

**phillipmann**  
we do more

[www.phillipmann.com](http://www.phillipmann.com)



Approximate Gross Internal Area 657 sq ft – 61 sq m

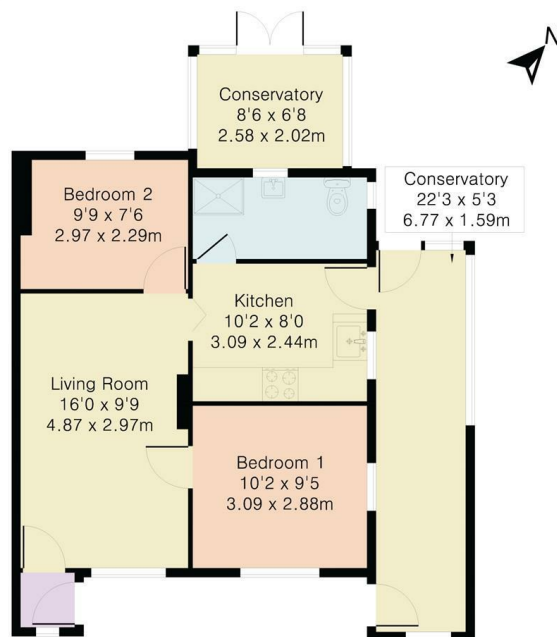

Ground Floor

## inbrief...

We are delighted to offer for sale this 2 bedroom semi bungalow situated in a popular, central residential area of Peacehaven within a short walk to local amenities, schools and main bus routes to Brighton/Eastbourne.

As you approach the property, benefits include an enclosed low maintenance block paved area with distant angled sea views and sheltered veranda. An inner porch opens into the lounge which features; original cast iron fireplace, space for soft furnishings with window to front.

Bedroom one is a double room to the front of the property and bedroom two is a smaller double / dining room overlooking the rear garden. The shower room comprises; enclosed shower tray cubicle, vanity wash basin, w/c and frosted window to side.

The kitchen is fitted with a variety of wall and base units and complementing working surface. Features include; inset sink drainer with window to side, space for cooker with overhead filter, wall mounted combination boiler, hatch to loft space and door to side porch which runs the length of the property with dual access and space for white goods.

The west facing rear garden is a lovely size and features; decked area, further base for shed / seating area, external garden room and lawn covering.

NO CHAIN



Council Tax - B

EPC - D

moreinfo...



Phillip Mann Peacehaven Office  
226-230 South Coast Road, Peacehaven, BN10 8JR  
01273 586622

To see more details on this & all our homes go to  
[www.phillipmann.com](http://www.phillipmann.com)