



Highbury Stadium Square, N5

£403 Per calendar month

A modern one bedroom apartment situated in a quiet courtyard of Highbury Stadium Square. The property has an open plan living and kitchen area, a private garden to the rear and balcony to the front.

Highbury Stadium Square is under half a mile from Arsenal tube station on the Piccadilly line and Drayton Park Station connecting to The City. It is close to the restaurants and independent cafes and shops of Highbury Barn and Highbury Park.

Features

- One Bedroom
- Private Garden
- Open Plan Living
- Communal Gardens
- 24 Hour Concierge
- On-site Gym

Highbury Stadium Square, London, N5

Ground Floor

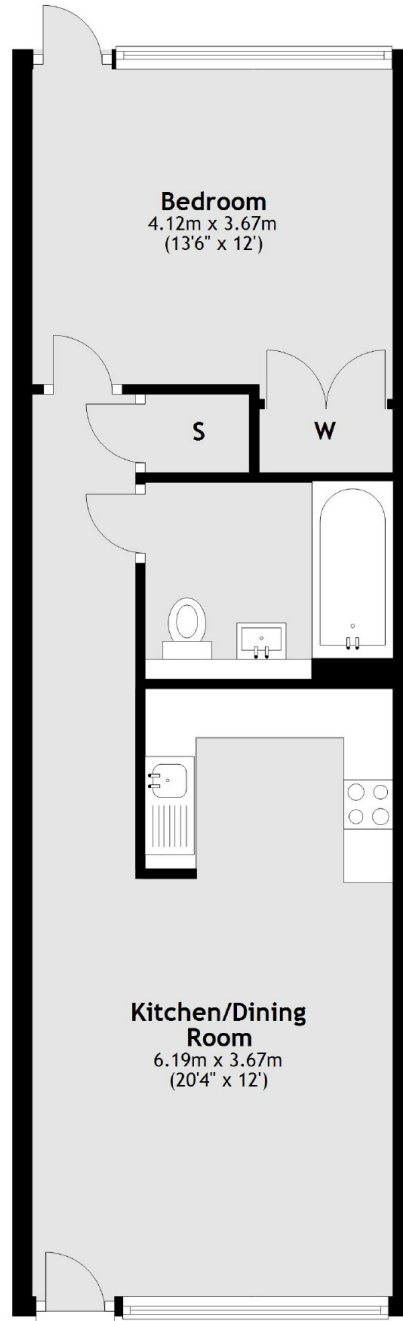

Total area: approx. 45.9 sq. metres (493.8 sq. feet)