



Bath New Road

Radstock, BA3 3ED

£425,000

A well proportioned family home set on the edge of Radstock and within easy commuting distance back into Bath. With four generous sized rooms and four reception rooms this home is perfectly set up to home a growing family, which it has been for many years.

- Extended accommodation
- Four generously sized bedrooms
- Separate study
- Large kitchen/diner
- Two bathrooms
- Spacious plot

Viewing

Please contact our Bath Stone Property (MSN) Office on 01761 360144 if you wish to arrange a viewing appointment for this property or require further information.



4



2



3



4

Floor Plan

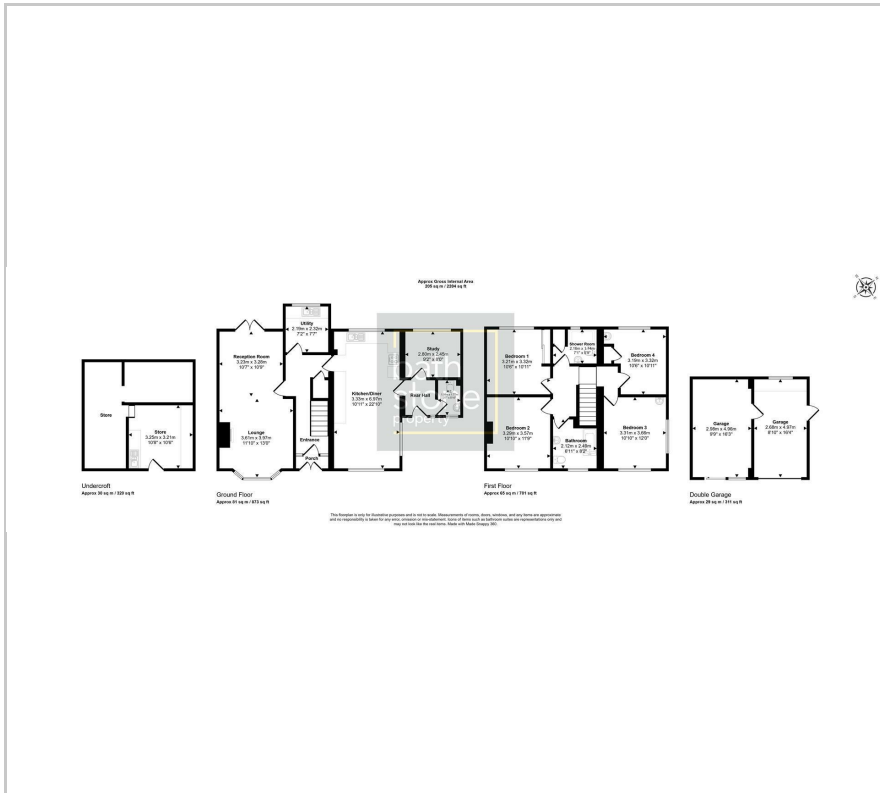

Area Map

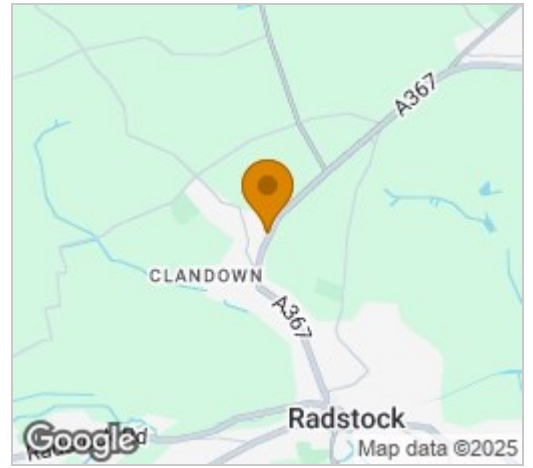

Energy Efficiency Graph

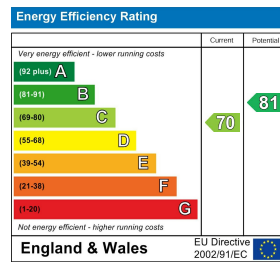

These particulars, whilst believed to be accurate are set out as a general outline only for guidance and do not constitute any part of an offer or contract. Intending purchasers should not rely on them as statements of representation of fact, but must satisfy themselves by inspection or otherwise as to their accuracy. No person in this firm's employment has the authority to make or give any representation or warranty in respect of the property.