



**MILES ESTATE AGENTS**

**8 Mount Street Taunton TA1 3QB £250,000**



An utterly charming, recently upgraded and extended 2 double bedroom Grade II Listed end terrace cottage with lovely courtyard garden in this prime location close to the town centre and Vivary Park. Perfect lock up and leave or lifestyle purchase - no parking but within minutes walk of all Taunton's amenities and immediately available with NO ONWARD CHAIN. Early viewing highly recommended. Freehold Council Tax band B EPC : Exempt.





## Features:

- Cosy sitting room
- Recently refitted kitchen with extensive units, wooden counter tops & range cooker
- Useful conservatory
- Refitted cloakroom
- First floor double bedroom
- Refitted shower room
- Second floor further double bedroom
- Good size courtyard garden with bar!
- NO ONWARD CHAIN
- Freehold
- Council Tax Band B
- EPC : Exempt



Floorplan

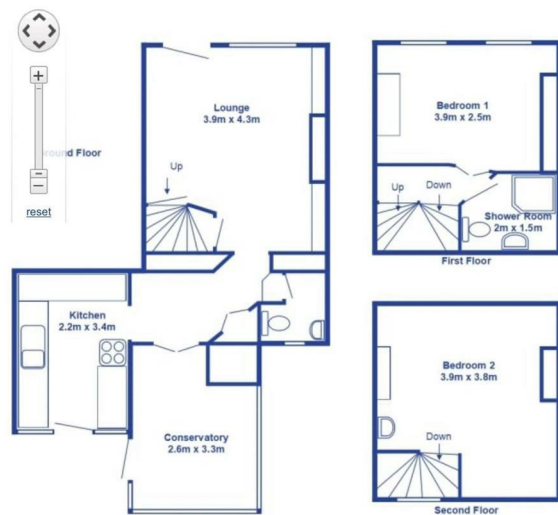

Viewings strictly through the selling agents:

**Miles Estate Agents**

2 Piffin Lane, Bishops Lydeard, Taunton,  
Somerset, TA4 3AS

**Tel: 01823 470 500**

[lydeard@milesestateagents.co.uk](mailto:lydeard@milesestateagents.co.uk)

[www.milesestateagents.co.uk](http://www.milesestateagents.co.uk)



**rightmove** 

**OnTheMarket.com**

**MILES ESTATE AGENTS**



**BEST**

ESTATE AGENT GUIDE  
2019 : EXCEPTIONAL

**SALES**