



*jordan fishwick*

ALTRINCHAM  
Clay Lane



# Clay Lane, Altrincham, WA15 8PJ

Asking Price £695,000



## The Property

A beautifully extended and fully modernised traditional five-bedroom semi-detached home, offering warm and versatile family accommodation. The property features open-plan living spaces, exceptional natural light, and stunning views across rural farmland to the front. It also falls within the catchment area for highly regarded schools, including Well Green Primary School.

Internally, the home is accessed via a spacious entrance hall leading to both the bay-fronted lounge and the impressive open-plan kitchen and living space. This exceptional area incorporates a lounge zone, dining area, and bi-fold doors opening onto the composite decking of the rear garden. Velux windows and the wide bi-folds together create an abundance of natural light throughout the space.

The contemporary kitchen is fully integrated and features quartz worktops, a breakfast island, and a downdraft cooker hood. From the kitchen, there is access to the utility room and the storage/garage.

The first floor offers four bedrooms, including three generous doubles. The principal bedroom is bay-fronted and enjoys attractive views over farmland. A modern four-piece family bathroom serves this level, complete with a freestanding oval bath and a separate walk-in shower.

The second floor provides a spacious double bedroom with an en-suite shower room, as well as extensive eaves storage.

Externally, the landscaped rear garden features a composite decked area, established flowerbeds and shrubs, and a lawned section. The garden is fully enclosed and offers side access to the front.

## Directions

WA15 8PJ



- Stunning Five Bedroom Semi Detached
- Extended and Fully Modernised Throughout
- Open Plan Kitchen Living Area
- Leasehold - 999 Year Lease
- Solar Panels
- Excellent Location Overlooking Farmland
- Offroad Parking
- Four Double Bedrooms
- Utility Room and Separate Downstairs WC
- Within Catchment of Well Green Primary School and Other Highly Regarded Schools

Postcode - WA15 8PJ

EPC Rating - C

Floor Area - 1720.00 sq ft

Local Authority - Trafford

Council Tax - E



# Clay Lane, Hale

Total Approx. Floor Area 1720 Sq.ft. (159.8 Sq.M.)

Surveyed and drawn by Lens Media for illustrative purposes only. Not to scale. Whilst every attempt was made to ensure the accuracy of the floor plan, all measurements are approximate and no responsibility is taken for any error.

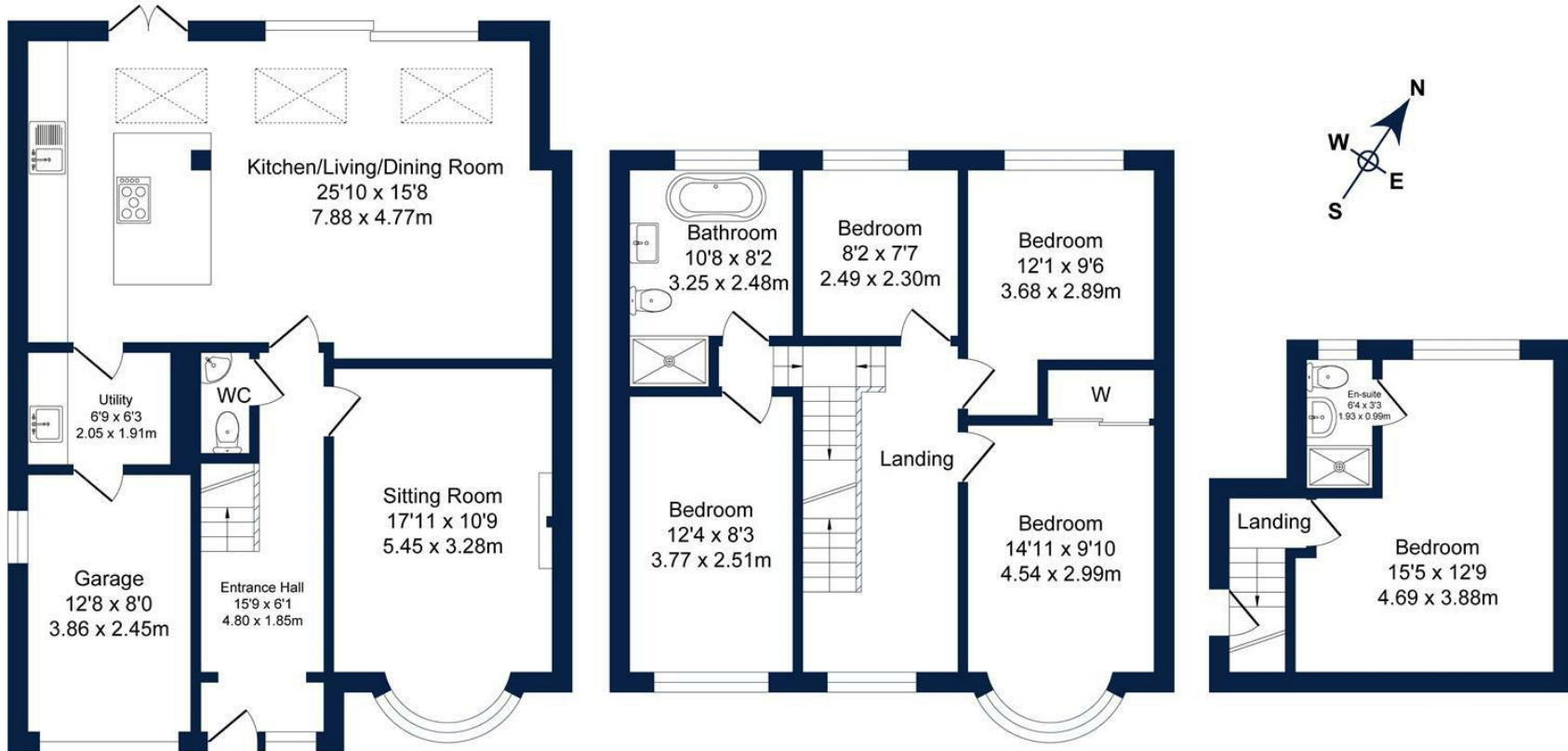

Ground Floor

Approx. Floor Area 850 Sq.Ft (79.0 Sq.M.)

First Floor

Approx. Floor Area 650 Sq.Ft (60.4 Sq.M.)

Second Floor

Approx. Floor Area 220 Sq.Ft (20.4 Sq.M.)



These particulars are believed to be accurate but they are not guaranteed and do not form a contract. Neither Jordan Fishwick nor the vendor or lessor accept any responsibility in respect of these particulars, which are not intended to be statements or representations of fact and any intending purchaser or lessee must satisfy himself by inspection or otherwise as to the correctness of each of the statements contained in these particulars. Any floorplans on this brochure are for illustrative purposes only and are not necessarily to scale.

Offices at: Chorlton, Didsbury, Disley, Hale, Glossop, Macclesfield, Manchester Deansgate, Manchester Whitworth Street, New Mills, Sale, Wilmslow and Withington

0161 929 9797

hale@jordanfishwick.co.uk  
www.jordanfishwick.co.uk