



Fiador Apartments, 21 Telegraph Avenue, Greenwich SE10 0TH



Fiador Apartments, Greenwich SE10

Leasehold (987 years remaining)

Offering views over the River Thames from every room, this stunning apartment on the 1st floor apartment comes to market with a secure underground parking space in the ever popular Enderby Wharf development.

Key Features

- 2 Double bedrooms, 2 Bathrooms
- 2 riverfront facing balconies
- Excellent storage cupboards
- Council Tax: **D**
- Service Charge: **£3,002 P/A**
- Ground: Rent: **£613.95 P/A**
- Excellent transport links
- EPC: **B**

The accommodation comprises; a large entrance hallway with ample storage cupboards and a utility cupboard. The reception room / kitchen is a generous size at (24'7 x 14'5) with a kitchen which has been thoughtfully arranged with an array of eye and base level units and integrated appliances and finished with high-quality worksurfaces. From the reception room is the large balcony, offering unparalleled views over the River Thames, Canary Wharf & The City, perfect for sitting out with friends, enjoying a drink in the evenings together with a second smaller balcony which you can also access from the reception room.. Both bedrooms are also situated at the front of the property, meaning all rooms share the same impressive views. The main bedroom is a large double room benefitting from a built-in wardrobe and en-suite shower room. A beautiful family bathroom finishes off the property.

One of the standout features of Enderby Wharf is its excellent transport links. You'll find several transportation options nearby, making it easy to navigate around the city. The development is within walking distance of North Greenwich Underground Station, which provides access to the Jubilee Line.









Fiador apartments, SE10

Approximate Gross Internal Area = 80.3 sq m / 864 sq ft

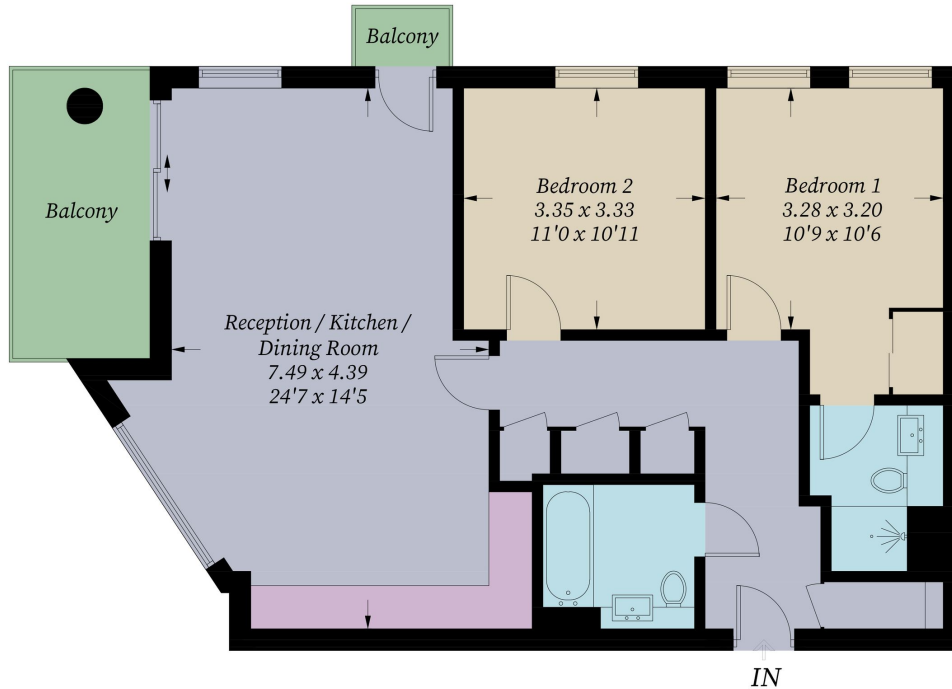

Illustration for identification purposes only, measurements are approximate, not to scale. Fourlabs.co © (ID1300863)