

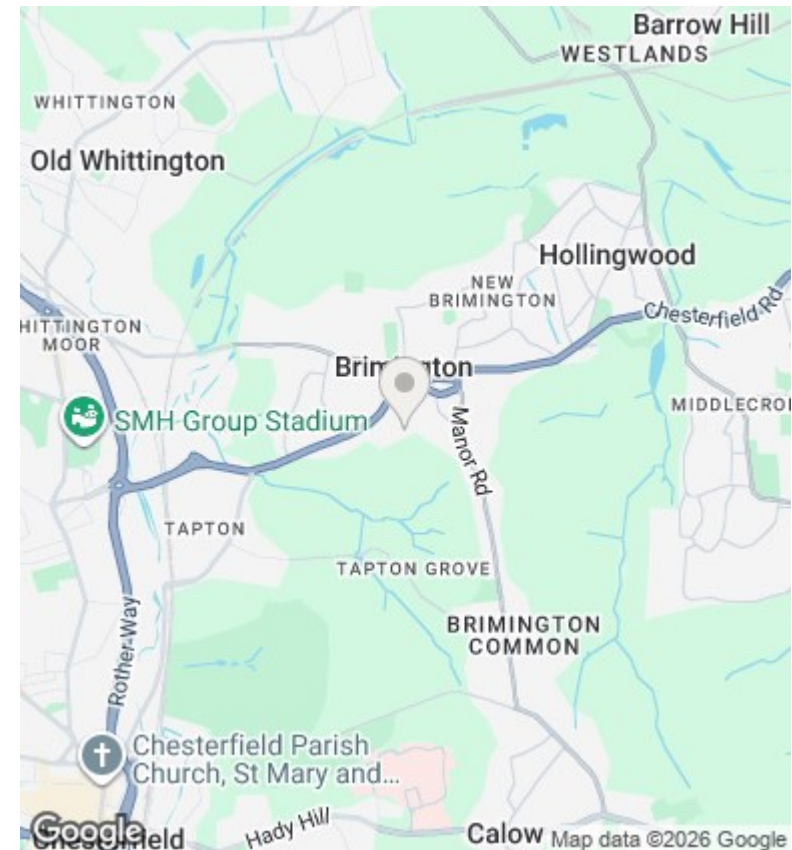

9 Skylark Road, Brimington, Chesterfield, S43 1FG

Price Guide £450,000

- 5 double bedrooms
- Guide price £450,000 - £460,000
- A further double bedroom with ensuite shower room
- Ideal family home still under builders warrantee
- Large kitchen diner
- Utility room and Wc
- Off street parking a garage
- Office/playroom
- Master bedroom with ensuite shower room and built in wardrobes
- Indian pavers, decked seating area and lawn

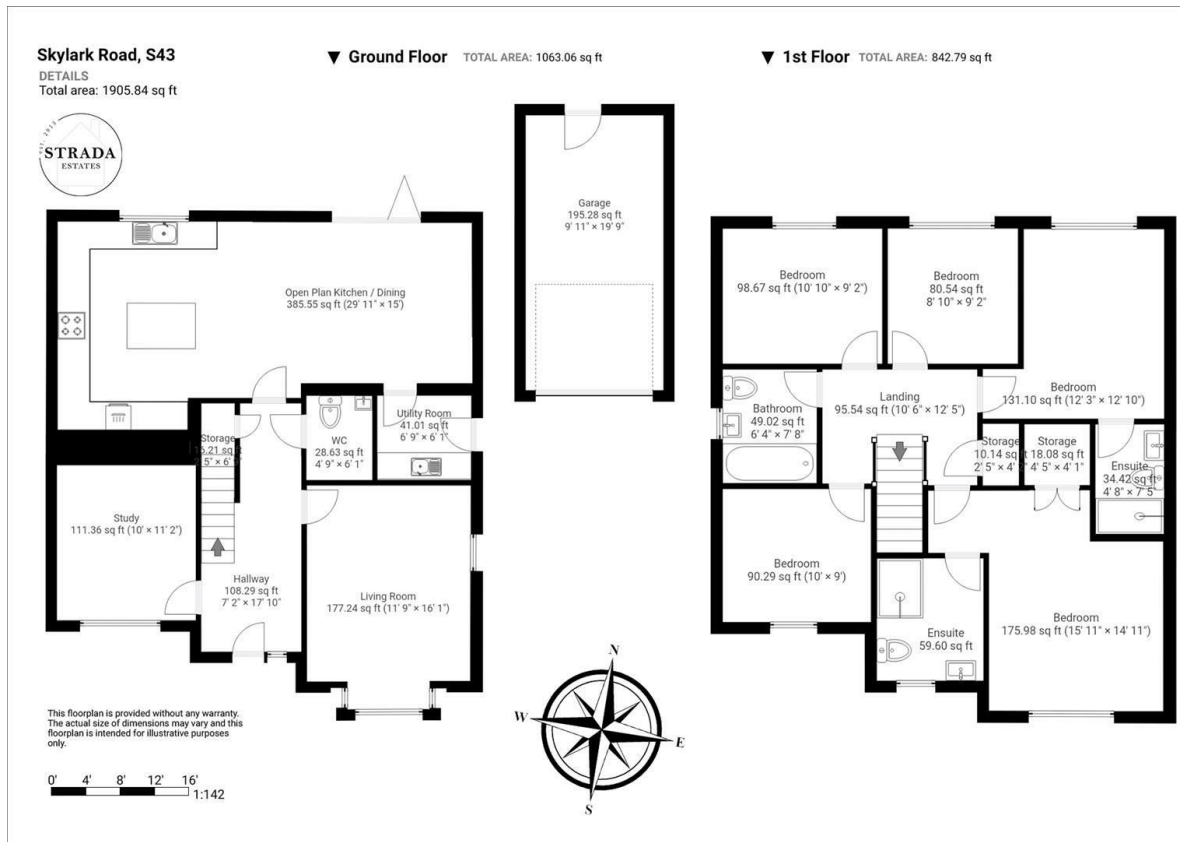

Directions

Viewings

Viewings by arrangement only. Call 01246 276 276 to make an appointment.

Council Tax Band

A

EPC Rating:

B

Energy Efficiency Rating		
	Current	Potential
Very energy efficient - lower running costs		
(92 plus) A		93
(81-91) B	85	
(69-80) C		
(55-68) D		
(39-54) E		
(21-38) F		
(1-20) G		
Not energy efficient - higher running costs		
England & Wales	EU Directive 2002/91/EC	