



ASPIRE

— TO MOVE —



Mulberry Park, Combe Down, Bath, BA2

A modern two bedroom apartment located in the Mulberry Park development in Combe Down, Bath. Available 31st July.

Mulberry Park is an award winning development situated in Combe Down. Amenities include a primary school, children`s nursery and state-of-the-art leisure facilities, There is also an onsite community Hub offering yoga and pilates classes alongside a cafe.

£1,600 PCM

Mulberry Park, Combe Down, Bath, BA2

- Two double bedroom
- Allocated parking space
- Council tax band C
- Unfurnished
- Modern apartment
- Assured Periodic Tenancy
- Available 31st July
- Holding deposit: £369
- Bin and bike store

A modern two bedroom apartment located in the Mulberry Park development in Combe Down, Bath. Available 31st July.

Mulberry Park is an award winning development situated in Combe Down. Amenities include a primary school, children`s nursery and state-of-the-art leisure facilities, There is also an onsite community Hub offering yoga and pilates classes alongside a cafe.

You enter the property into a well proportioned L-shaped entrance hall with double doors to a utility cupboard with countertop and a washing machine. This utility cupboard also houses a Fibre To The Premises (FTTP) broadband router offering up to 1Gbps of broadband speed.

The living space is open plan and benefits from a dual aspect with five windows allowing in natural light and pleasant views of the green opposite. The kitchen area has base and wall units, oven, grill, hob and integrated fridge/freezer and dishwasher. The master bedroom includes both a double wardrobe and an en-suite shower room with shower, WC and sink. The second bedroom is also a double and there is a modern bathroom with shower over bath, WC and sink.

Externally, there is a car park where you will find an allocated off road parking space, a communal bike lock up area and a refuse/recycling store.

The property is available from the 31st July and would best suit a single professional or couple. Please note the landlord is not looking to accept students.

Council tax band C: £2066.91





FIRST FLOOR
717 sq.ft. (66.6 sq.m.) approx.

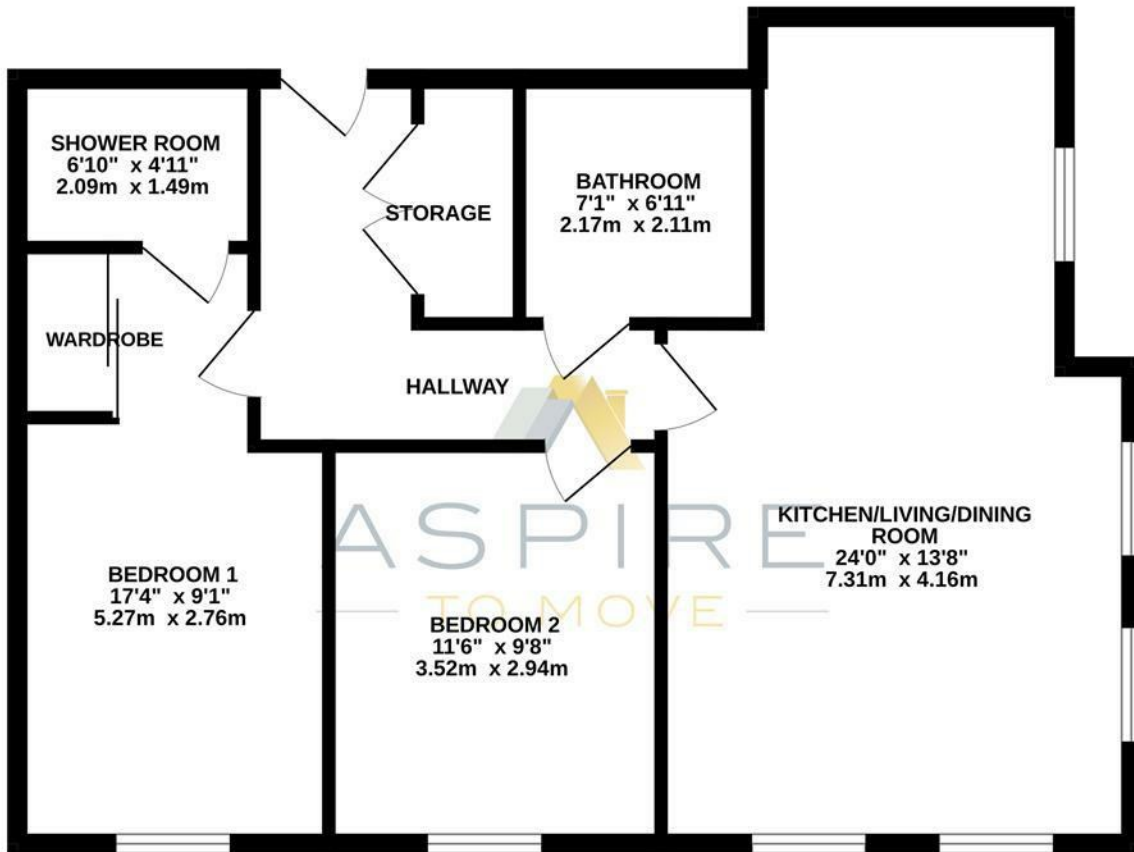

MULBERRY WAY, BATH, BA2

TOTAL FLOOR AREA: 717 sq.ft. (66.6 sq.m.) approx.

Whilst every attempt has been made to ensure the accuracy of the floorplan contained here, measurements of doors, windows, rooms and any other items are approximate and no responsibility is taken for any error, omission or mis-statement. This plan is for illustrative purposes only and should be used as such by any prospective purchaser. The services, systems and appliances shown have not been tested and no guarantee as to their operability or efficiency can be given.
Made with Metropix ©2024

These particulars, whilst believed to be accurate are set out as a general outline only for guidance and do not constitute any part of an offer or contract. Intending purchasers should not rely on them as statements of representation of fact, but must satisfy themselves by inspection or otherwise as to their accuracy. No person in this firm's employment has the authority to make or give any representation or warranty in respect of the property.

