



## Flat 6 Golden Mews, 15 Howard Road

London, SE20 8HQ

**Asking Price £325,000**

A charming 1930s conversion, this well-presented two double bedroom flat offers a fantastic blend of period character and modern comfort. Situated in a peaceful mews setting, the property boasts a spacious layout, a modern fitted kitchen and bathroom, and double-glazed windows complemented by gas central heating. With a long lease in place, this home is an ideal choice for first-time buyers, professionals, or investors alike.

Residents of Golden Mews also benefit from a well-maintained communal garden, perfect for relaxation and social gatherings.

Penge is a vibrant and sought-after area in South East London, known for its excellent transport links and abundance of green spaces. Howard Road is ideally positioned within easy reach of Penge East Station, which offers direct services to London Victoria in around 18 minutes, and Penge West Station, providing Overground and National Rail connections to London Bridge and beyond. There are also multiple bus routes offering swift access to Crystal Palace, Beckenham, and Central London.

Council: Bromley (Band C)  
Tenure: Leasehold  
Lease Length: 963 years remaining  
Service Charge: £1,742.00 p/a

### Viewing

Please contact our Galloways Penge Office on 020 8778 1120 if you wish to arrange a viewing appointment for this property or require further information.

- TWO DOUBLE BEDROOMS
- COMMUNAL GARDEN
- DOUBLE GLAZED WINDOWS
- CENTRAL HEATING
- MODERN FITTED KITCHEN
- CONTEMPORARY BATHROOM SUITE
- 14 MINUTE WALK TO PENGE EAST STATION
- 16 MINUTE WALK TO PENGE WEST STATION
- 16 MINUTE WALK TO CRYSTAL PALACE PARK
- (WALKING TIMES ESTIMATED BY GOOGLE MAPS)



## Floor Plan

Howard Road, SE20  
2 Bedroom Flat

APPROXIMATE GROSS INTERNAL AREA: 602 SQ FT / 56 SQ M

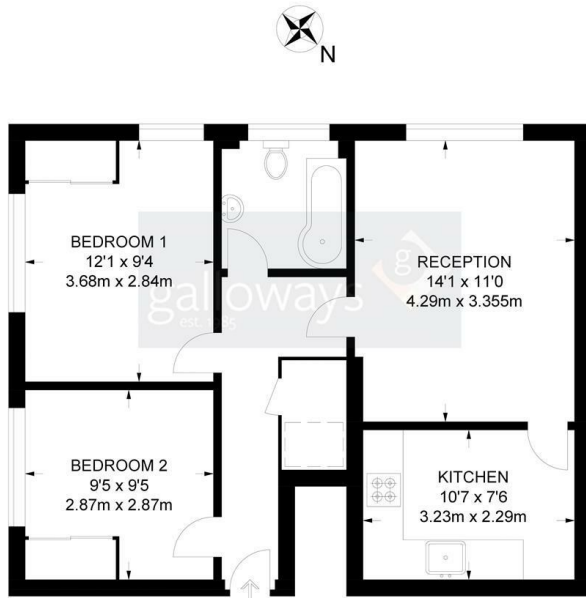

GROUND FLOOR

## Area Map



## Energy Efficiency Graph

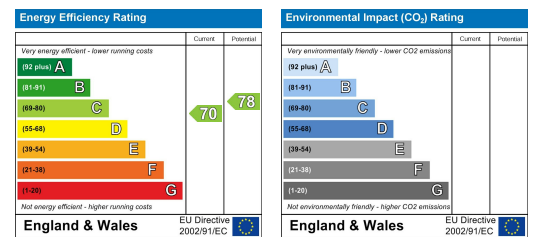

These particulars, whilst believed to be accurate are set out as a general outline only for guidance and do not constitute any part of an offer or contract. Intending purchasers should not rely on them as statements of representation of fact, but must satisfy themselves by inspection or otherwise as to their accuracy. No person in this firm's employment has the authority to make or give any representation or warranty in respect of the property.