



## Lakeside Drive, NW10

£275,000

A modern one-bedroom apartment offering stunning picturesque views over the lake, perfectly positioned and perched on the first floor. With open plan living, ensuring practical yet elegant living space. The property has a private balcony and is sold with no onward chain.

Viscount House is perfect for buyers seeking low-maintenance living with strong transport links in and out of London.

Located within a five minute walk from Park Royal station (Piccadilly Line) and just over ten minutes from Hanger Lane station (Central Line). In addition, on your door step you have a Co-Op, Barbers, Dental practise and Nursery as well as being conveniently located within a ten minute walk from Royal Leisure Park which has a multitude of amenities including Pure Gym, Asda Superstore, Odeon Luxe Cinema and Tempin Bowling.

### Features

- One Double Bedroom
- First Floor
- Lake Views
- Private Balcony
- 580 Square Feet
- No Onward Chain

# Lakeside Drive, London, NW10

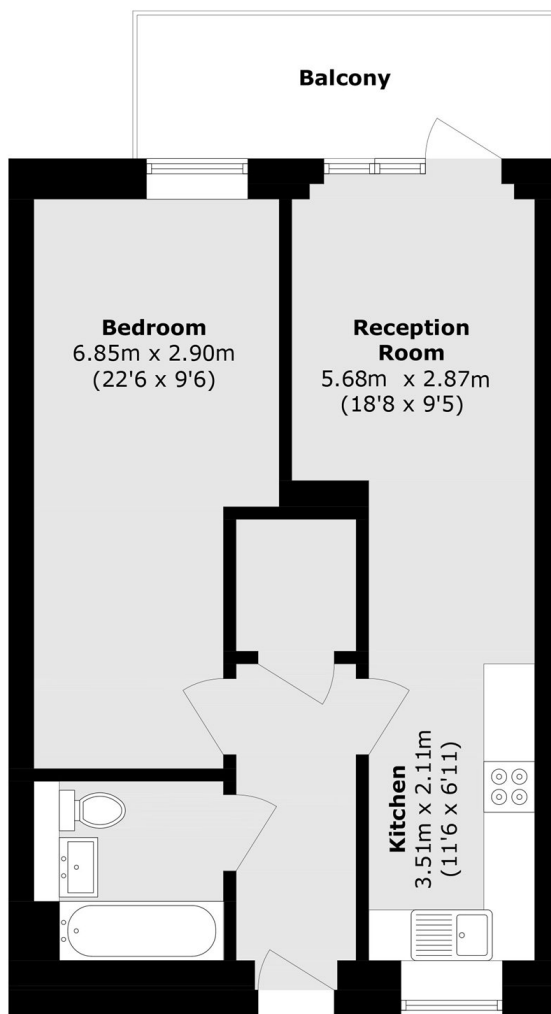

**Second Floor**

Total area (approx.): 53.8 sq. m (579.1 sq. ft)

Balcony area (approx.) 8.42 sq. m (90.6 sq. ft)