



Cleveland Street, London W1T

Price £590 per week - Furnished







Description

The apartment comprises an open-plan reception room and kitchen, a large bedroom and a modern bathroom. It also has plenty of natural light and is offered furnished. The apartment is located in an excellent central location with restaurants and retailers only a stroll away.

The Cleveland Residences are ideally located in one of London's most central residential districts: Fitzrovia. Renowned for its impressive, classic London architecture, leafy squares and of course, its sophistication and charm.

Council tax band: C. Rent is payable on a monthly basis and you may be required to pay more than a month's rent in advance, depending on your circumstances. You will be required to pay a 1 week holding deposit following a successful offer. Tenancies with annual rents up to £50,000 will require a 5 weeks' security deposit, while those exceeding this threshold will require a 6 weeks' deposit. Utility bills, council tax, telephone line and broadband are not included in the rent. As well as paying the rent, you may also be required to make some additional permitted payments. If your tenancy does not qualify as an AST, additional fees may apply. Please visit jll.co.uk/fees for details of fees that may be payable when renting a property. To check broadband and mobile phone coverage please visit Ofcom here ofcom.org.uk/phones-telecoms-and-internet/advice-for-consumers/advice/ofcom-checker

- Modern Apartment
- Lots of Natural Light
- Fitted Open-Plan Kitchen
- Wooden Flooring
- Furnished
- Bath and Shower
- Professionally Managed
- Central Fitzrovia
- Council Tax Band: C
- Deposit amount: £2,950 (estimate) and an initial holding deposit of 1 week's rent is pa

Floorplan

389 sq ft | 36 sq m

Cleveland Residences, Cleveland Street, W1T

Approximate Gross Internal Area
36.10 sq m / 389 sq ft
(CH = Ceiling Heights)

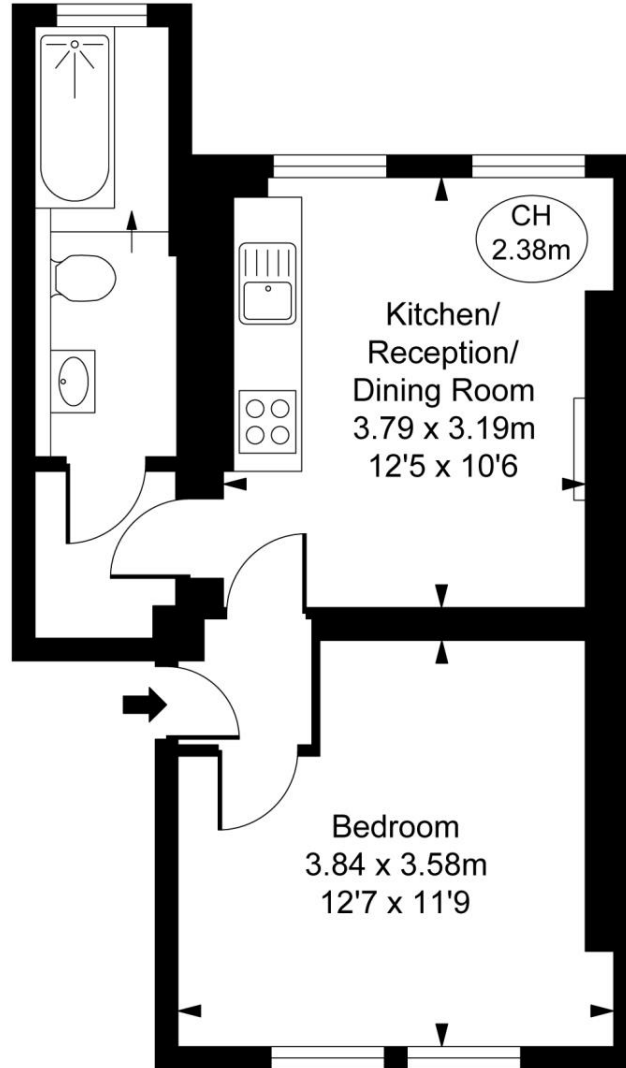

Third Floor

This plan is not to scale. It is for guidance and not for valuation purposes.
All measurements and areas are approximate only, and have been prepared in accordance with the current edition of the RICS Code of Measuring Practice.
© Fulham Performance

Mayfair and Marylebone
St George Street,
London W1S 2FQ
+44 207 399 5550
mayfair@jll.com

Urban living, your way.

jll.co.uk/residential

© 2019 Jones Lang LaSalle IP, Inc. All rights reserved. All information contained herein is from sources deemed reliable; however, no representation or warranty is made to the accuracy thereof.

