

JOHN BRAY & SONS

1 Sackville Terrace Sackville Road
Bexhill-On-Sea, TN39 3FX

£1,300 Per Calendar Month

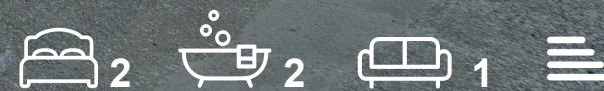

1 Sackville Terrace Sackville

Bexhill-On-Sea, TN39 3FX

The property: The two bedroom mews house has been newly refurbished to a high standard throughout and provides two ground floor double bedrooms one with en-suite shower room, family bathroom, large first floor open plan kitchen, dining and lounge with two Juliet balconies and small balcony overlooking entrance to mews. The property additionally benefits from electric central heating, double glazing and on street permit parking.

The Location: Situated in the heart of Bexhill town centre with easy access to amenities and the beautiful seafront. The property is also a short distance to Bexhill Main Line Train Station which offers direct links to London.

Entrance hallway

Bedroom One
10'2" x 9'10" (3.10m x 3.02m)

Ensuite shower room

Bedroom Two
10'2" x 9'10" (3.10m x 3.02m)

Bathroom

First floor

Living room with open plan kitchen
38'1" x 10'5" (11.63m x 3.18m)





Floor Plan

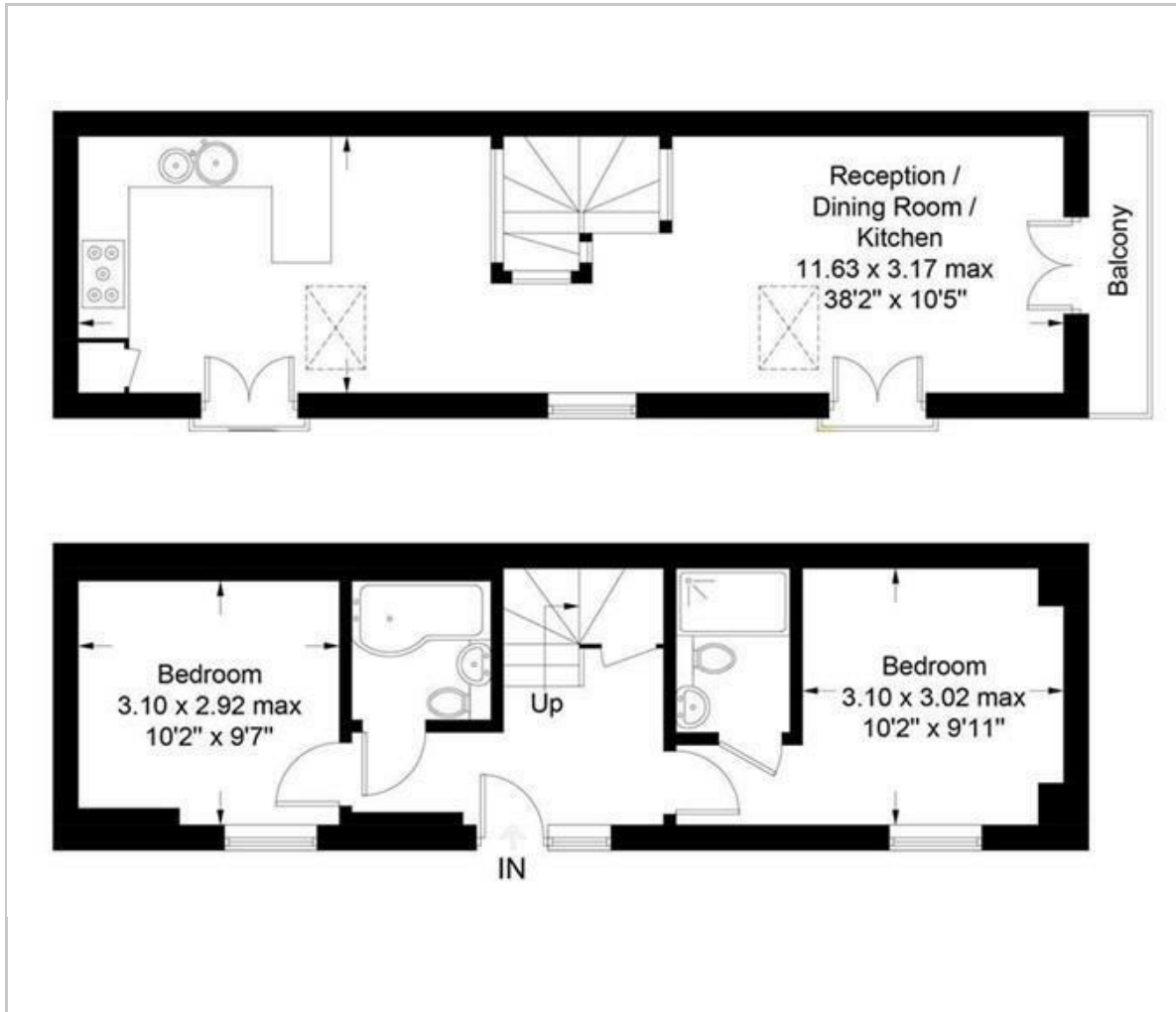

Viewing

Please contact our John Bray Hastings Lettings Office on 01424 421544 if you wish to arrange a viewing appointment for this property or require further information.

These particulars, whilst believed to be accurate are set out as a general outline only for guidance and do not constitute any part of an offer or contract. Intending purchasers should not rely on them as statements of representation of fact, but must satisfy themselves by inspection or otherwise as to their accuracy. No person in this firm's employment has the authority to make or give any representation or warranty in respect of the property.

72 High Street, Hastings, East Sussex, TN34 3EL
 Tel: 01424 421544 Email: enquiries@johnbrayandsons.com www.johnbrayandsons.com

Area Map

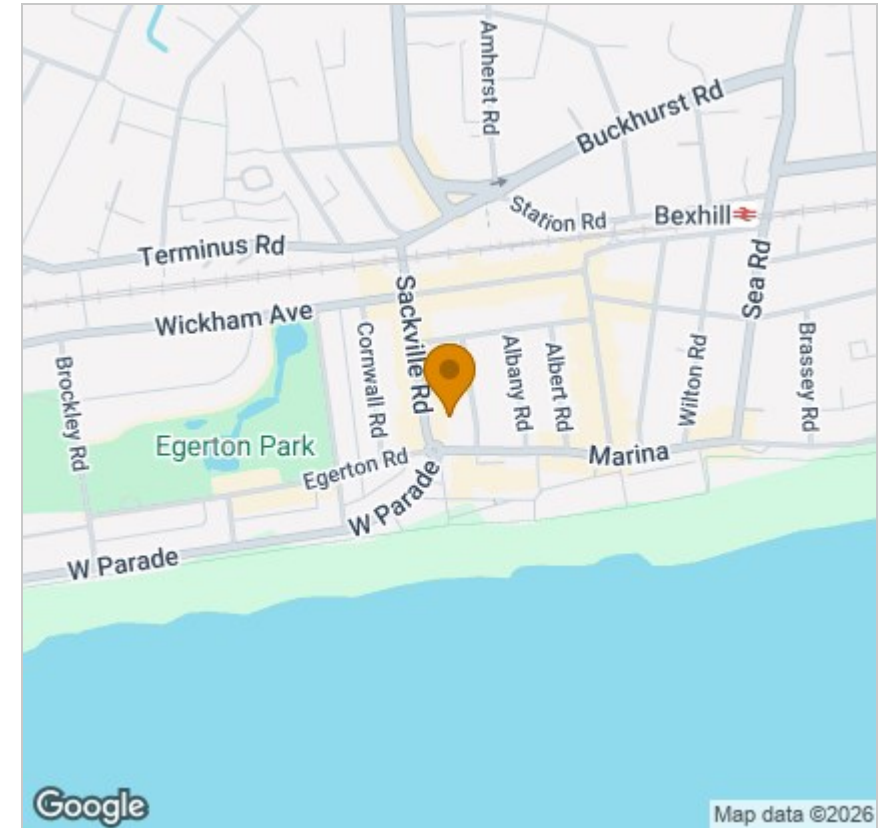

Energy Efficiency Graph

