



9 Queens Road, Knaresborough

£195,000 Guide Price



**YOUR AWARD
WINNING AGENT**

#DARINGTOBEDIFFERENT



A beautifully presented two-bedroom mid-terrace home with driveway parking, ideally situated in this popular and convenient residential location.

Externally, the property benefits from an enclosed front garden with gated access. To the rear is a low-maintenance gravelled courtyard providing valuable off-street parking with an EV charging point, while also offering space for outdoor seating if desired.

Queens Road is a highly regarded residential location, just a short distance from Knaresborough's historic town centre and market square. The property is well placed for a range of local amenities, well-regarded schools, and excellent transport links, including bus and rail services. Convenient access to the A59 and A1(M) provides straightforward commuting to Harrogate, York, Leeds and beyond.

Council Tax band: B

Tenure: Freehold

EPC Energy Efficiency Rating: D



The property offers well-balanced accommodation throughout, beginning with a bright and welcoming sitting room. To the rear, a newly fitted contemporary kitchen features a stylish range of wall and base units, quality worktops and attractive tiled splashbacks, with direct access to the enclosed rear garden. To the first floor are two well-proportioned bedrooms, including a generous principal bedroom and a versatile second bedroom, ideal as a guest room, nursery or home office. The accommodation is completed by a newly fitted, contemporary house bathroom, finished with modern tiling and quality fittings, including a shower over the bath.



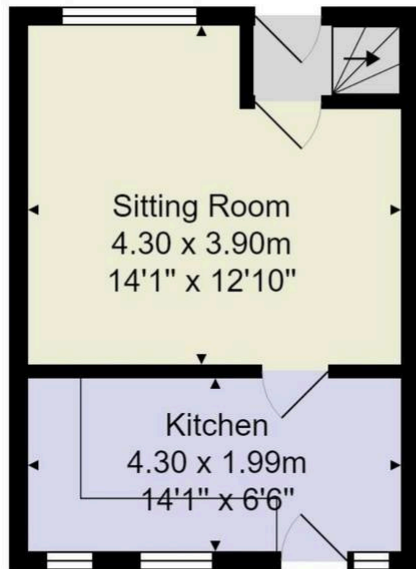

Ground Floor

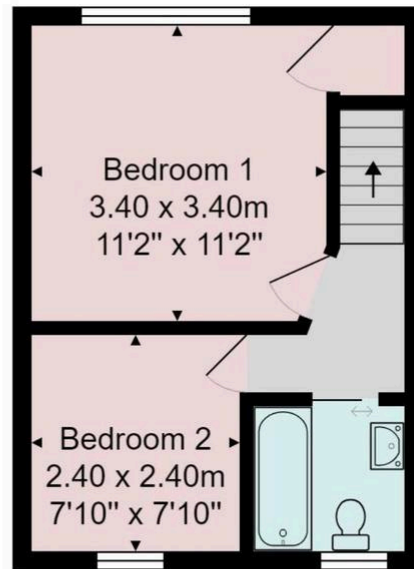

First Floor

Total Area: 52.0 m² ... 560 ft²

All measurements are approximate and for display purposes only.

No liability is accepted by either the agency or Box Property Solutions Ltd as to the exact measurements of the rooms.

Box Property Solutions Ltd retains the copyright on this plan and allows agents to use it with agreed permission.

