

# *Callaghans*

Independent Estate Agents, Surveyors, Valuers and Mortgage Brokers

## **44 Halstead Grove, Gatley, SK8 4HL**



**£375,000**

**Spacious Semi Detached  
Three Bedrooms  
Large Gardens  
Detached Garage  
Two Receptions  
Able to Add Value**

Callaghans Estate Agents  
46 Church Road, Gatley, SK8 4NQ  
Telephone: 0161 491 4000, Fax: 0161 491 55 44  
Website: [www.callaghansltd.com](http://www.callaghansltd.com) Email: [admin@callaghansltd.com](mailto:admin@callaghansltd.com)

Callaghans are pleased to offer for sale this spacious, chain-free semi-detached property, featuring a long landscaped rear garden and a detached garage. Located in Gatley, just a short stroll from excellent schools, shops, and transport links, this home presents a wonderful opportunity for families seeking both space and convenience.

A convenient porch welcomes you into this delightful property. The welcoming hallway, complete with a feature, stained glass window and provides access to all ground-floor rooms and immediately hints at the character within. To the front, the dining room is filled with natural light from a bay window, creating an inviting space for meals or entertaining. At the rear, a spacious lounge features patio doors that open onto the long garden, making it a special place to gather with family and friends. The kitchen is fitted with cream gloss units and integrated appliances, offering a practical and stylish workspace.

Upstairs, three generous bedrooms provide ample space for the whole family to relax. The tiled family bathroom includes a walk-in shower, complemented by a separate toilet room for added convenience.

Externally, the property benefits from a small front garden and a long driveway that leads to a brick garage at the rear. The rear garden is a particular highlight, thoughtfully landscaped with mature plants and offering a peaceful and private outdoor retreat.

This chain-free property combines a superb location with genuine potential to create your own ideal family home. Contact Callaghans today to arrange your viewing and discover all that this lovely home has to offer.

**Hallway** 6' 0" x 12' 10" (1.84m x 3.9m)

**Dining Room** 12' 2" x 9' 6" (3.7m x 2.9m)

**Lounge** 10' 10" x 13' 1" (3.31m x 4m)

**Kitchen** 7' 2" x 9' 10" (2.18m x 3m)

**Family Bathroom** 7' 1" x 5' 6" (2.17m x 1.68m)

**Toilet** 2' 11" x 4' 8" (0.9m x 1.42m)

**Bedroom One** 11' 4" x 10' 11" (3.45m x 3.33m)

**Bedroom Two** 11' 4" x 10' 11" (3.46m x 3.34m)

**Bedroom Three** 7' 8" x 7' 3" (2.33m x 2.21m)

**Callaghans Estate Agents**  
46 Church Road, Gatley, SK8 4NQ  
Telephone: 0161 491 4000, Fax: 0161 491 55 44  
Website: [www.callaghansltd.com](http://www.callaghansltd.com) Email: [admin@callaghansltd.com](mailto:admin@callaghansltd.com)

GROUND FLOOR  
441 sq.ft. (41.0 sq.m.) approx.



1ST FLOOR  
417 sq.ft. (38.8 sq.m.) approx.

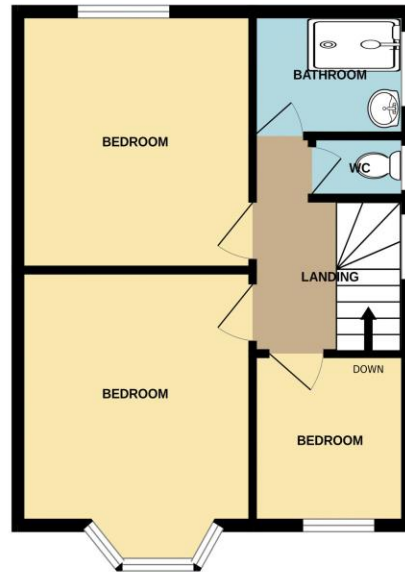

TOTAL FLOOR AREA: 858 sq.ft. (79.7 sq.m.) approx.

Whilst every attempt has been made to ensure the accuracy of the floorplan contained here, measurements of doors, windows, rooms and any other items are approximate and no responsibility is taken for any error, omission or mis-statement. This plan is for illustrative purposes only and should be used as such by any prospective purchaser. The services, systems and appliances shown have not been tested and no guarantee as to their operability or efficiency can be given.

Made with Metropix ©2026

**Disclaimer:**

These particulars, whilst believed to be accurate are set out as a general guideline only or guidance and do not constitute any part of an offer or contract. Intending purchasers should not rely on them as statements of representation or fact, but must satisfy themselves by inspection or otherwise as to their accuracy. Please note that we have not tested any apparatus, equipment, fixtures, fittings or services, including gas central heating and so cannot verify they are in working order or fit for their purpose. Further more solicitors should confirm movable items described in the sales particulars are, in fact included in the sale since circumstances do change during marketing or negotiations. Although we try to ensure accuracy, measurements used in this brochure may be approximate. Therefore if intending purchasers need accurate measurements to order carpeting or to ensure existing furniture will fit, they should take such measurements themselves. **YOUR HOME IS AT RISK IF YOU DO NOT KEEP UP REPAYMENTS ON A MORTGAGE OR OTHER LOAN SECURED ON IT**