



**Severn Crescent, North Wingfield Chesterfield S42 5NY**

**welcome to**

## **Severn Crescent, North Wingfield Chesterfield**

A well kept two-bed home offering bright living space, a full-depth lounge/diner, a practical kitchen and two comfortable bedrooms. With a modern bathroom, private rear garden and driveway to the front, it's an ideal low-maintenance home for easy, everyday living.

### **Front Yard**

The property is approached via a neat front garden that creates an immediate sense of welcome. A stretch of lawn sits alongside a private driveway, offering off-road parking and a clear, practical arrival point.

### **Hall**

A welcoming entrance hall that sets the tone for the home, offering space to hang coats and kick off shoes before stepping through to the main living areas and stairs rise to the first floor.

### **Lounge/Dining Room**

A bright, open-plan lounge and dining space stretching the full depth of the property, creating an easy, sociable flow. There's ample room for both a comfortable seating area and a family dining table. It's the kind of room that adapts effortlessly from relaxed evenings to weekend entertaining.

### **Kitchen**

A well arranged kitchen offering good workspace and practical storage, designed to make everyday cooking straightforward. Its layout keeps everything within easy reach, with room for appliances and a clear view toward the rear of the home. Access to the rear garden is reached via the kitchen, providing great indoor / outdoor living.

### **Landing**

A neat first floor landing connecting the bedrooms and bathroom, with a sense of space and light that keeps the upper floor feeling open.

### **Bedroom One**

A generous double bedroom with room for wardrobes and additional furniture, offering a calm, restful atmosphere. Positioned to enjoy good natural light, it's an inviting main bedroom that feels instantly comfortable. This bedroom has a built-in wardrobe as well as space for additional wardrobes and cupboards.

### **Bedroom Two**

A well-proportioned second bedroom ideal as a child's room, guest room or dedicated home office. Its layout makes it easy to furnish, and the window brings in a pleasant brightness throughout the day.

### **Bathroom**

A modern family bathroom serving the first floor, fitted with a three-piece suite and finished in a clean, neutral style. It provides everything needed for busy mornings and relaxed evening routines.

### **Rear Garden**

A private rear garden offering a blend of lawn and patio, perfect for outdoor dining, children's play or simply unwinding in the fresh air. Enclosed by fencing for privacy, it's a manageable, low-maintenance space with plenty of potential to personalise.





***view this property online*** [williamhbrown.co.uk/Property/CSF105139](http://williamhbrown.co.uk/Property/CSF105139)



welcome to

## Severn Crescent, North Wingfield Chesterfield

- Council Tax Band - B
- Driveway
- Modern Kitchen
- Two Comfortable Bedrooms
- Spacious Rear Garden

Tenure: Freehold EPC Rating: C

Council Tax Band: B

# £155,000

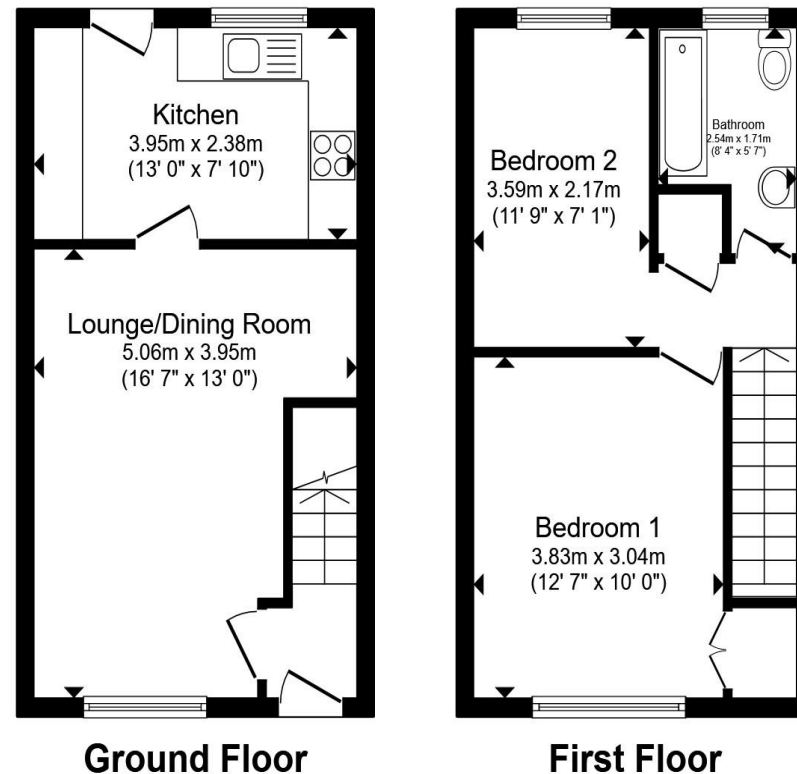

Ground Floor

First Floor

Total floor area 59.9 m<sup>2</sup> (644 sq.ft.) approx

This floor plan is for illustrative purposes only. It is not drawn to scale. Any measurements, floor areas (including any total floor area), openings and orientation are approximate. No details are guaranteed, they cannot be relied upon for any purpose and they do not form part of any agreement. No liability is taken for any error, omission or misstatement. A party must rely upon its own inspection(s). Powered by [www.propertybox.io](http://www.propertybox.io)



view this property online [williamhbrown.co.uk/Property/CSF105139](http://williamhbrown.co.uk/Property/CSF105139)



Property Ref:  
CSF105139 - 0006

1. MONEY LAUNDERING REGULATIONS Intending purchasers will be asked to produce identification documentation at a later stage and we would ask for your co-operation in order that there is no delay in agreeing the sale. 2. These particulars do not constitute part or all of an offer or contract. 3. The measurements indicated are supplied for guidance only and as such must be considered incorrect. Potential buyers are advised to recheck measurements before committing to any expense. 4. We have not tested any apparatus, equipment, fixtures or services and it is in the buyers interest to check the working condition of any appliances. 5. Where an EPC, or a Home Report (Scotland only) is held for this property, it is available for inspection at the branch by appointment. If you require a printed version of a Home Report, you will need to pay a reasonable production charge reflecting printing and other costs. 6. We are not able to offer an opinion either written or verbal on the content of these reports and this must be obtained from your legal representative. 7. Whilst we take care in preparing these reports, a buyer should ensure that his/her legal representative confirms as soon as possible all matters relating to title including the extent and boundaries of the property and other important matters before exchange of contracts.

William H Brown is a trading name of Sequence (UK) Limited which is registered in England and Wales under company number 4268443, Registered Office is Cumbria House, 16-20 Hockliffe Street, Leighton Buzzard, Bedfordshire, LU7 1GN. VAT Registration Number is 500 2481 05.

william h brown



01246 204492



[chesterfield@williamhbrown.co.uk](mailto:chesterfield@williamhbrown.co.uk)



6 Glumangate, CHESTERFIELD, Derbyshire, S40 1TP



[williamhbrown.co.uk](http://williamhbrown.co.uk)