



**Bilton Road, UB6**

**£658 pw (£2,850 pcm)**

This four bedroom, two bathroom terraced house offers a generous living space. The ground floor features a large reception room that opens onto a garden with a large shed at the rear provides excellent storage space, a separate kitchen and a bathroom downstairs.

Bilton Road is situated near to Perivale (Central Line) and Alperton (Piccadilly line) stations.

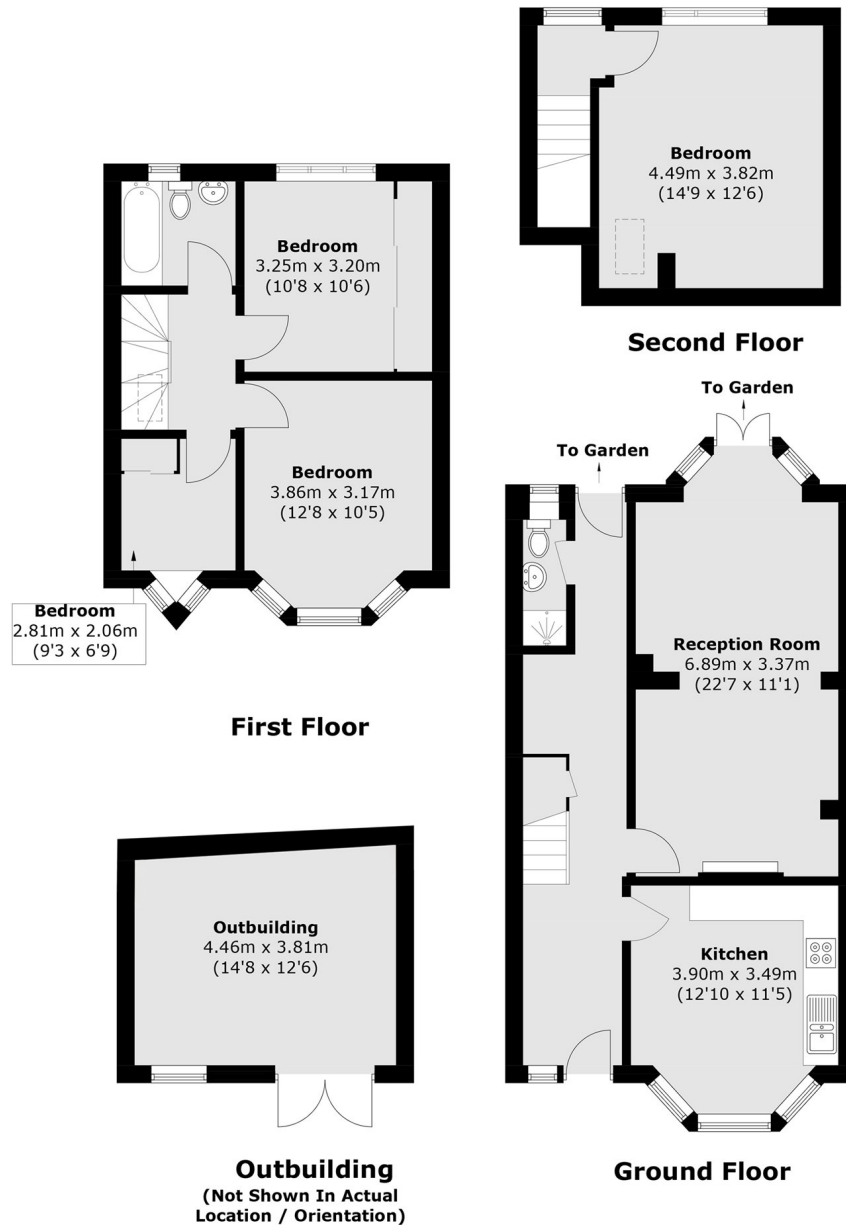

Total area (approx.): 111.5 sq. m (1,200.0 sq. ft)  
Outbuilding area (approx.): 17.2 sq. m (185.1 sq. ft)

Robertson Smith & Kempson Ealing Lettings  
1 The Broadway,  
London, W5 2NT  
020 8840 7885  
ealinglettings@robertsonsmithandkempson.co.uk

Energy Rating: . We aim to make our particulars both accurate and reliable. However they are not guaranteed; nor do they form part of an offer or contract. If you require clarification on any points then please contact us, especially if you're traveling some distance to view. Please note that appliances and heating systems have not been tested and therefore no warranties can be given as to their good working order.