

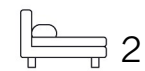

Living
made
better

Pirie Street
Silvertown, E16 2BL



Asking Price £400,000

Pirie Street, Silvertown, E16 2BL

Madison Brook

Property Summary

Offered to the market chain free, this two-bedroom freehold house situates in a convenient East London location, the property benefits from off-street parking, a substantial rear garden and close proximity to local transport links. The accommodation comprises a spacious reception room, separate fitted kitchen, two well-proportioned double bedrooms and a family bathroom. Externally, the property boasts a sizeable rear garden extending to approximately 59ft, together with a useful garden shed and a private driveway providing off-street parking.

Ideally located within easy reach of West Silvertown DLR station. Please note works to the bathroom have been completed; however, the remainder of the property would benefit from refurbishment and modernisation.

Floorplan

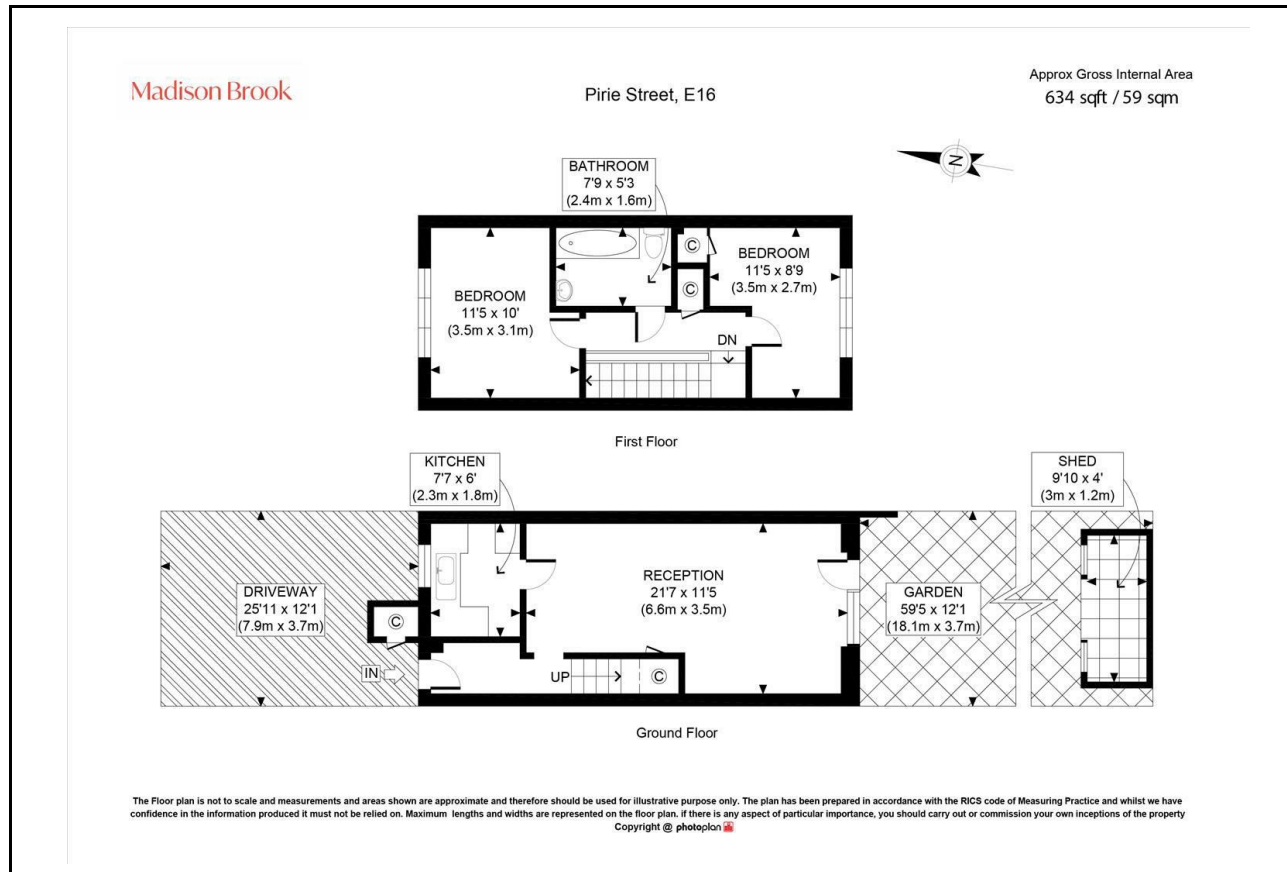

Area Map

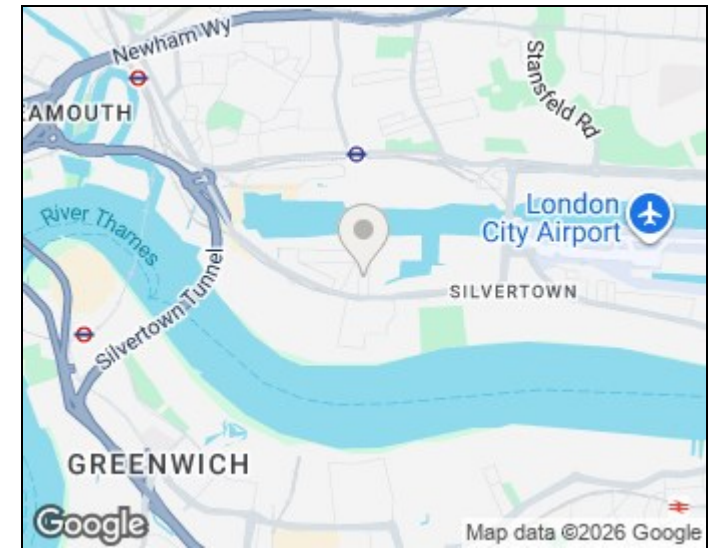

Energy Efficiency Graph

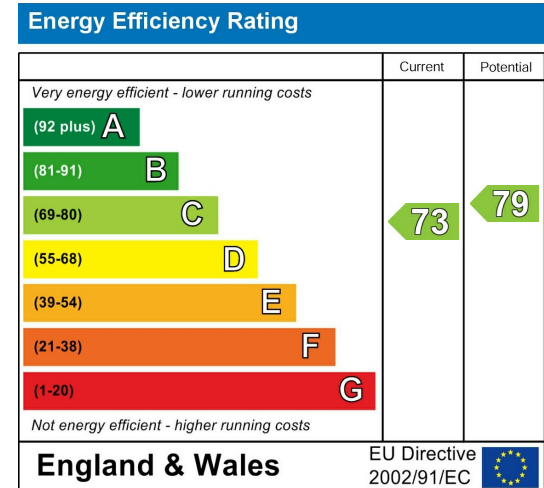

These particulars, whilst believed to be accurate are set out as a general outline only for guidance and do not constitute any part of an offer or contract. Intending purchasers should not rely on them as statements of representation of fact, but must satisfy themselves by inspection or otherwise as to their accuracy. No person in this firm's employment has the authority to make or give any representation or warranty in respect of the property.

Unit B 20 Western Gateway, Royal Victoria
Dock, London, E16 1BS
Tel: 020 3946 6000 Email:
docklands@madisonbrook.com
<https://madisonbrook.com/>