



5 Dale Crescent  
Kettering, NN15 6WT



**Simpson & Partners**

Nestled in the charming area of Dale Crescent, Barton Seagrave, Kettering, this delightful two-bedroom end terrace house presents an excellent opportunity for both first-time buyers and those seeking a comfortable rental. The property boasts a well-designed layout, featuring a spacious lounge/diner that is perfect for entertaining, complete with double doors that open onto a lovely rear garden, allowing for a seamless indoor-outdoor living experience.

The kitchen is equipped with modern conveniences, including a built-in oven, hob, and extractor fan, making it a practical space for culinary enthusiasts. Additionally, the ground floor benefits from a convenient downstairs WC, enhancing the overall functionality of the home.

Upstairs, you will find two generously sized double bedrooms, providing ample space for relaxation and rest. The bathroom is well-appointed, catering to the needs of the household with ease.

Outside, the property features a driveway that offers off-road parking, a valuable asset in today's busy world. The rear garden is a true highlight, featuring a patio area ideal for al fresco dining, a decking area perfect for sunbathing, and a timber fence surround that ensures privacy and security.

This end terrace house on Dale Crescent is not only a comfortable home but also a wonderful opportunity to enjoy the peaceful surroundings of Barton Seagrave. With its blend of modern amenities and outdoor space, it is sure to appeal to a variety of buyers and renters alike.

Price £230,000



2



1



1



GROUND FLOOR

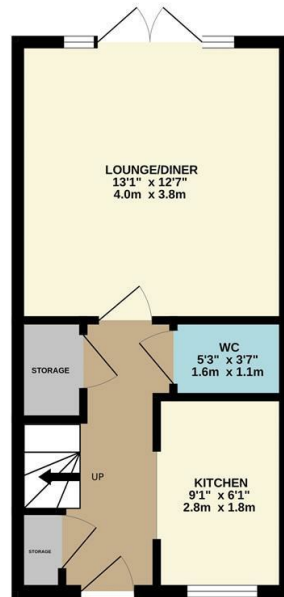

1ST FLOOR

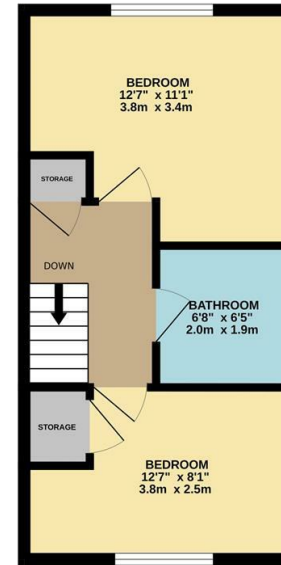

Whilst every attempt has been made to ensure the accuracy of the floorplan contained here, measurements of doors, windows, rooms and any other items are approximate and no responsibility is taken for any error, omission or mis-statement. This plan is for illustrative purposes only and should be used as such by any prospective purchaser. The services, systems and appliances shown have not been tested and no guarantee as to their operability or efficiency can be given.  
Made with Metropack (2020).



Energy Efficiency Rating

	Current	Potential
Very energy efficient - lower running costs		
(92 plus) <b>A</b>		
(81-91) <b>B</b>	86	87
(69-80) <b>C</b>		
(55-68) <b>D</b>		
(39-54) <b>E</b>		
(21-38) <b>F</b>		
(1-20) <b>G</b>		
Not energy efficient - higher running costs		
<b>England &amp; Wales</b>	EU Directive 2002/91/EC	



When you buy with Simpson and Partners, you know **you'll be in safe hands**. From the moment you walk through our doors, we'll make you **feel truly welcome**. Our sales consultants and financial advisors will take you through **every step of the process**, offering **free expert advice** along the way, from help choosing the right mortgage and insurance through to finding your conveyancer. And if you need help selling your home too, **with over 20 years of local experience, you can trust us to get you moving**.



**Simpson  
& Partners**

Making Every  
Journey Personal



01536 518200

[kettering@simpsonandpartners.co.uk](mailto:kettering@simpsonandpartners.co.uk)

<https://www.simpsonandpartners.co.uk/>

1 Silver Street, Kettering, Northants, NN16 0BN