



67 Oakfields, Tiverton, EX16 6XE

Asking Price £210,000

- No Onward Chain!
- Main bedroom with en-suite
- Kitchen with ample storage
- Allocated parking space
- Ideal for first-time buyers
- Two double bedrooms with wardrobes
- Light-filled dual aspect sitting room
- South-facing private garden
- Close to countryside views
- Quiet no-through road location

Sales, Lettings, Mortgages:

Bampton 01398 332006 | Cullompton 01884 32100 | Tiverton 01884 253500



67 Oakfields, Tiverton EX16 6XE

A well-presented two-bedroom home tucked away towards the end of a quiet no-through road on the edge of Tiverton, enjoying a south-facing garden, countryside views and well-balanced accommodation throughout.



Council Tax Band: B



Situated towards the end of a quiet no-through road on the edge of Tiverton, this well-presented two-bedroom home enjoys a peaceful setting with very little passing traffic and an attractive outlook to the front.

The property has been well cared for and offers comfortable, well-balanced accommodation throughout, making it an ideal first home, investment or downsize opportunity.

The entrance hall provides access to a useful downstairs cloakroom, while the kitchen is positioned at the rear of the house and fitted with a range of storage cupboards and generous worktop space.

The sitting room is a particularly light room, benefiting from a dual aspect with space for both seating and dining. Double doors open directly onto the rear garden.

Upstairs, there are two double bedrooms, both with fitted wardrobes. The main bedroom benefits from an en-suite shower room, whilst the second bedroom is served by the family bathroom. One of the bedrooms also enjoys views towards the surrounding countryside and fields beyond.

Outside, the rear garden enjoys a good degree of privacy and a south-facing aspect, making it a pleasant space to sit out throughout the day.

To the front of the property there is an allocated parking space, along with additional unrestricted roadside parking nearby.

Estate management charges for 2025, £96.95, 6 monthly in advance.

Local Authority
Mid Devon District Council 01884 255 255

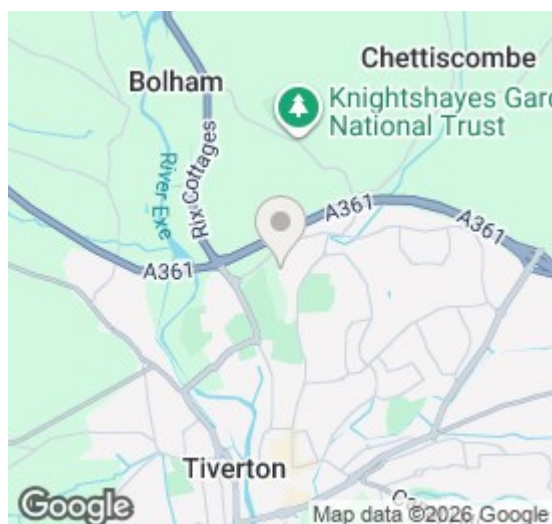

Directions

What3words, wire.gown.worked Google Maps Code, WG77+F4M Tiverton

Viewings

Viewings by arrangement only. Call 01884 253500 to make an appointment.

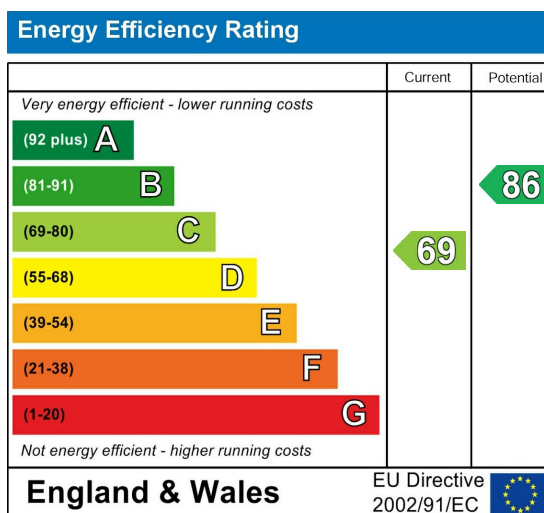

EPC Rating: C

67 Oakfields

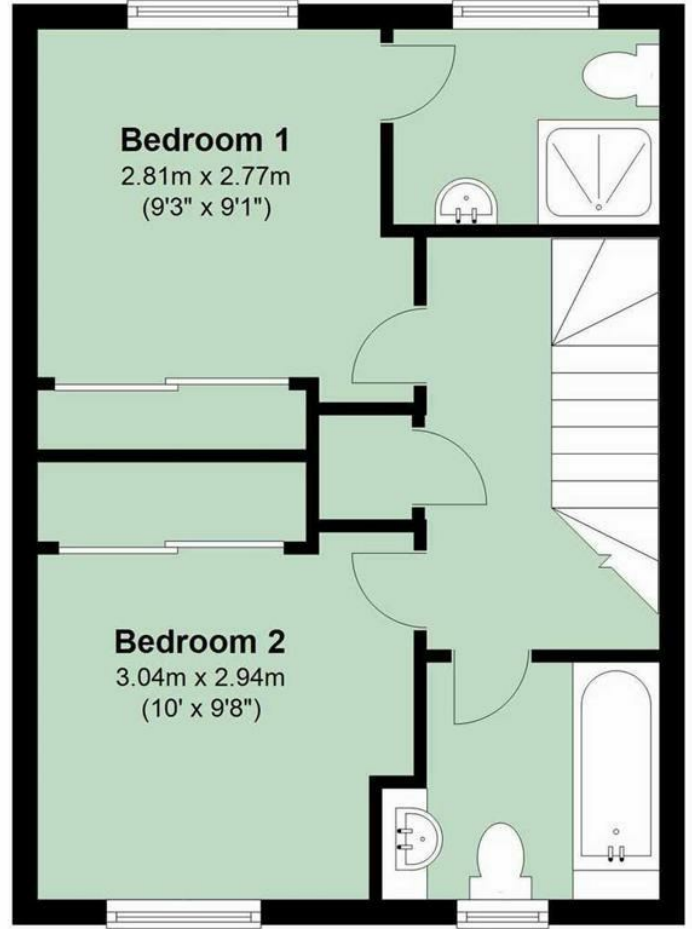
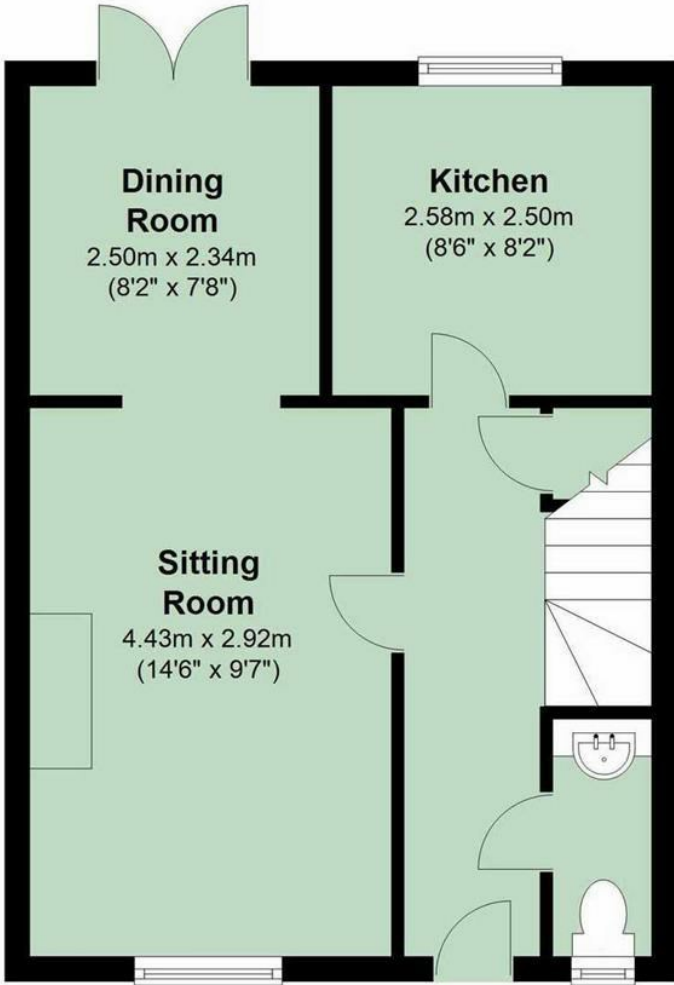

Total Area Approx 70.7sq/m 759.5sq/ft