



**Hilder Street
Leybourne Chase
West Malling
ME19 5ST**





Welcome to *Hilder Street*, a charming and intimate row of mews-style homes built by Taylor Wimpey in 2019. Set within Phase 5 of the ever-popular Leybourne Chase development in West Malling, this limited collection offers a peaceful, modern lifestyle in a beautifully established setting.

With accommodation approaching 1,100 square feet, this home delivers generous, versatile living across three well-proportioned bedrooms, each adaptable to suit your lifestyle. The open-plan kitchen and dining room flows seamlessly to the enclosed rear garden, creating a bright, social hub ideal for sunny gatherings and relaxed entertaining. A spacious living room, enhanced by a striking feature window that frames a charming view of the historic clock tower and the *juliet* balcony with views over the walled garden. A modern family bathroom completes the internal layout.

Another standout feature of this beautiful home - beyond its enviable position beside the charming secret walled garden, is the exceptional convenience of a tandem driveway, providing ample parking for a minimum of two vehicles.

Positioned on the edge of the development, this home offers peaceful living just moments from exceptional local amenities. Enjoy nearby sports facilities, scenic trails, and the much loved Average Doughs Bakery at the village pavilion. With respected schools close by and the vibrant market town of West Malling, complete with boutiques, restaurants and a mainline station only minutes away, this location delivers a truly desirable setting.

Ground Floor

Entrance Hallway

Cloakroom

Kitchen / Dining Room - 19'9 x 10'2
reducing to 8'5

Bedroom / Study - 10'2 x 7'2

First Floor

Galleried landing

Living Room - 21 x 14'5 max

Bedroom - 14'4 x 7'8

Bedroom - 10'2 x 7'2

Bathroom- 10'3 x 6'4

Exterior

Enclosed Garden

Tandem Car Port

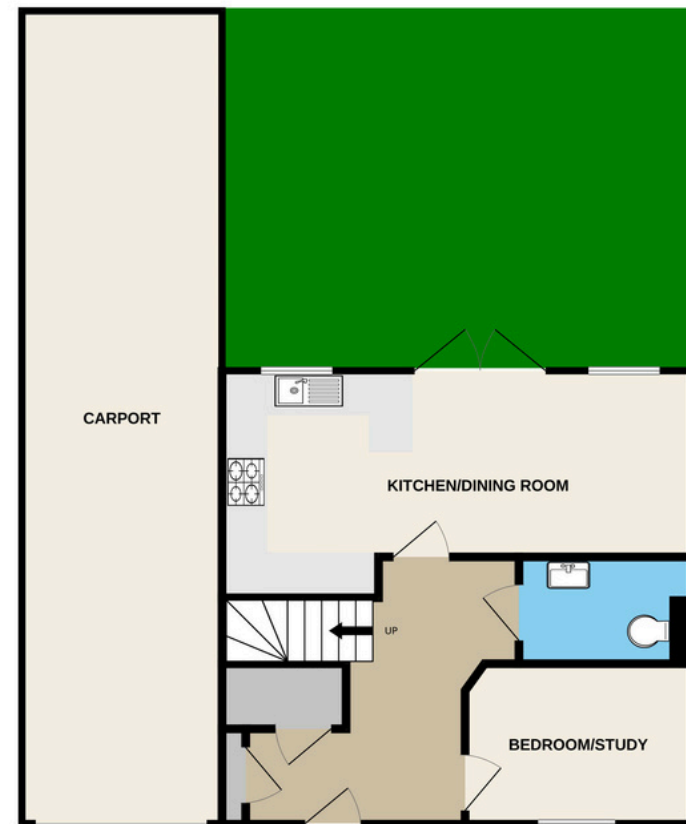

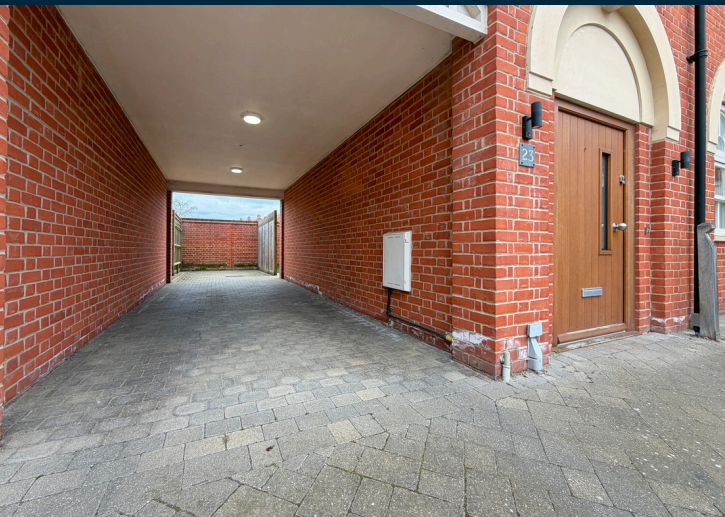



01732 647009



@sreynoldsrealestate