



Upper Wickham Lane, Welling

2  1  1  

£250,000

Open to offers. This TWO bedroom first floor balcony flat. Internally the accommodation comprises of two sizeable bedrooms, a modern fitted kitchen, bathroom and balcony overlooking open farmland. Offered to market with no forward chain we strongly recommend an internal viewing. Bexley Council tax band D. EPC tbc.



Upper Wickham Lane, DA16

Approximate Gross Internal Area = 684 sq ft / 63.5 sq m

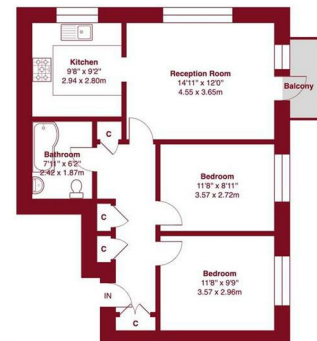

Westmount Estates

First Floor

This floor plan was produced using RICS measurements standards 2nd edition. For layout guidance only and not drawn to scale unless stated. Window and door openings are approximate. Whilst every care is taken in the preparation of this plan, we would advise interested parties to check all dimensions, shapes and compass bearings prior to making any decisions reliant upon them. No liability is accepted for any errors. By www.primisearchphotography.com Copyright 2020