



SCAN ME

11 Willow Herb Close, Locks Heath, Southampton,  
Hampshire, SO31 6XB.



For more information

**01489 570019**  
[www.sbk4homes.com](http://www.sbk4homes.com)

# 11 Willow Herb Close

Locks Heath, Southampton, SO31 6XB.

£1,250 PCM

- Stunning Two Bedroom Home
- Immaculately Presented Throughout
- Re-Fitted Kitchen and Bathroom
- Two Bedrooms
- Allocated Parking Nearby
- Nice Sized Rear Garden
- Lounge With Doors to Garden
- Quiet Cul De Sac Location
- Long Term Let
- Available Mid April Onwards



11 Willow Herb Close, Locks Heath, Southampton, Hampshire, SO31 6XB. £1,250 PCM

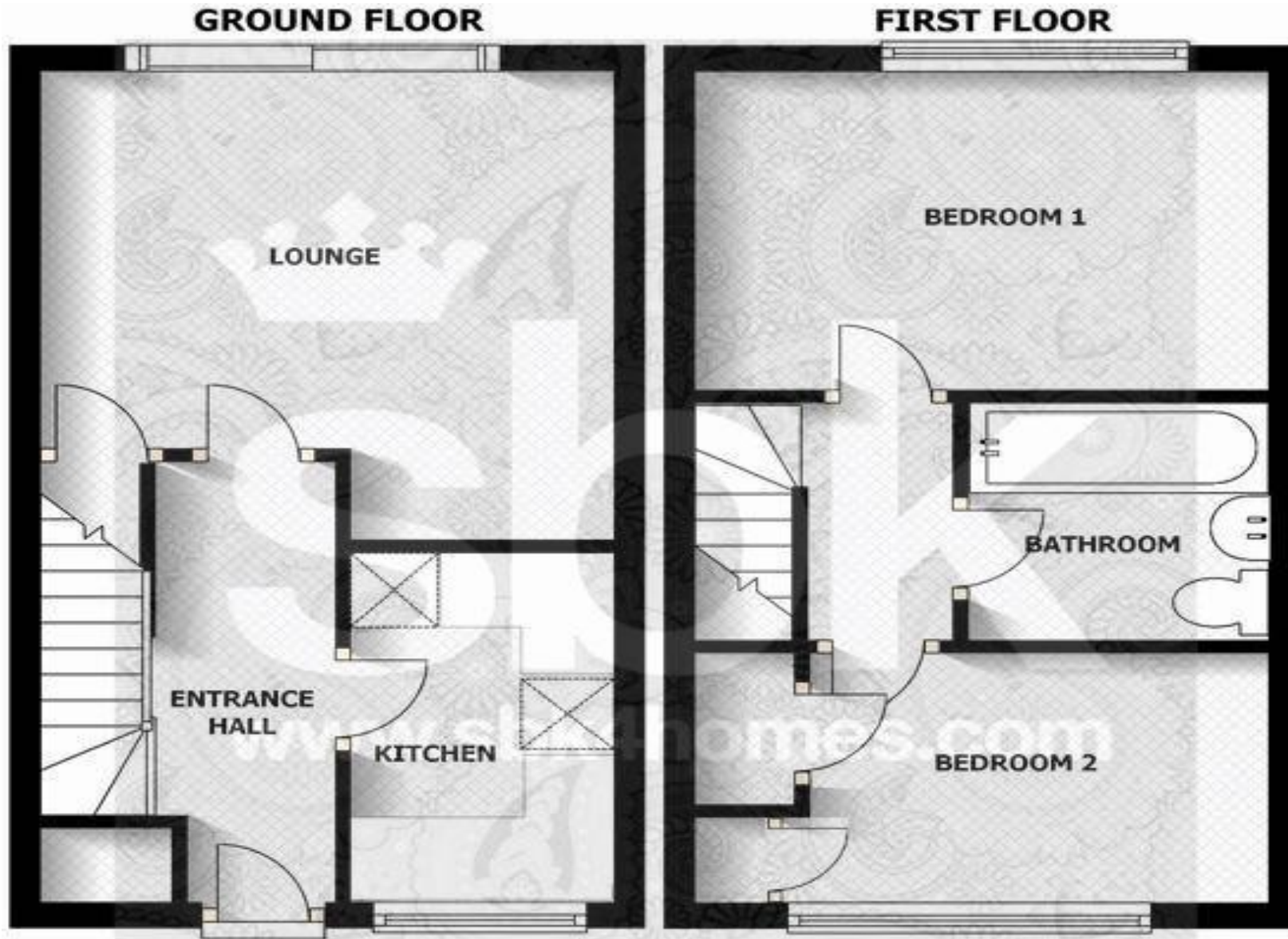



#### ADDITIONAL INFORMATION

Council Tax Band

Band B which is payable to Fareham Borough Council.

The charge for this is £1,765.98

Availability Date

The property is available from mid April onwards

Length of Let

The landlords intentions are for the property to be let on a long term basis.

Pets

The landlord for this property has specified that pets are not permitted.

Energy Performance Certificate

The rating for the property is C. To obtain a full report of the EPC please contact SBK.

Parking

The property has allocated parking nearby.



For more information

**01489 570019**

[www.sbk4homes.com](http://www.sbk4homes.com)