



 **2**
Bedrooms

 **1**
Bathroom

 **1**
Reception



- IDEAL FOR FIRST-TIME BUYERS AND INVESTORS
- WELL-PRESENTED FIRST-FLOOR GEM IN A POPULAR NORTON LOCATION
- BRIGHT AND SPACIOUS OPEN-PLAN LIVING, DINING AND KITCHEN AREA
- GENEROUS LOUNGE SPACE WITH ROOM TO RELAX AND ENTERTAIN
- FULLY FITTED KITCHEN WITH AMPLE STORAGE AND WORKTOP SPACE
- LOVELY GREEN VIEWS FROM THE MAIN LIVING AREA
- TWO WELL-PROPORTIONED BEDROOMS
- SLEEK, CONTEMPORARY SHOWER ROOM
- ALLOCATED PARKING WITH LOCAL SHOPS JUST A SHORT WALK AWAY
- LEASEHOLD PROPERTY

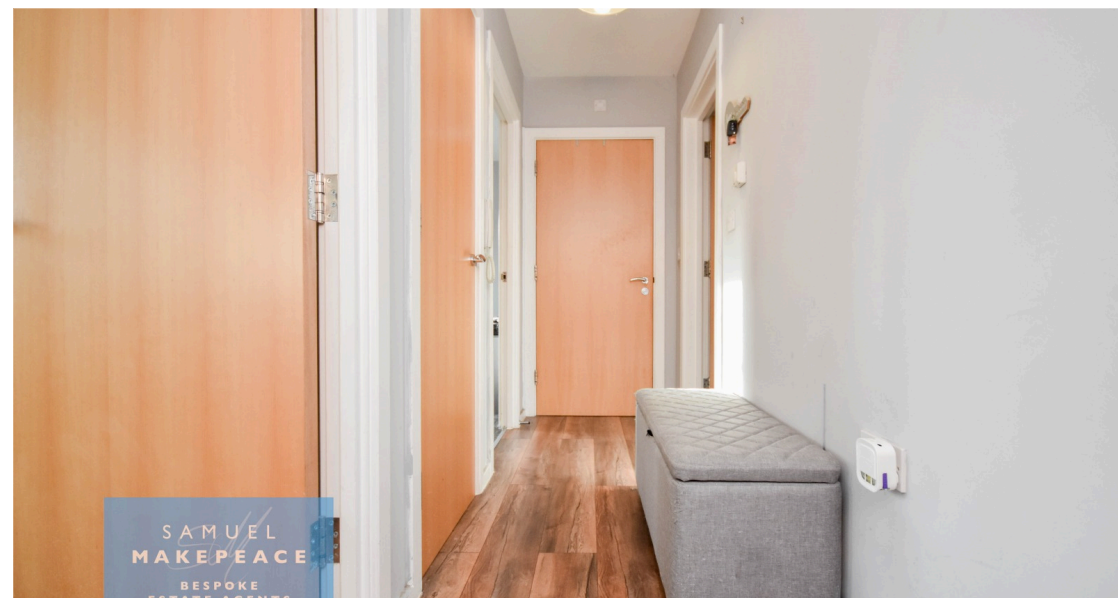

ASKING for more? This Norton Heights apartment delivers, this **first-floor gem** at **Moorefields View** is ready to answer the call. It's ideal for first-time buyers and investors who don't want to wait around for their moment to shine.

Step inside and you'll find a bright, spacious **open-plan living area** boasting a generous lounge, dining space, and a **fully fitted kitchen** with room for all your essentials. With lovely green views from the main living space, it's the perfect setting to host, unwind, and let every evening feel like centre stage. The property offers two well-proportioned bedrooms and a sleek, contemporary shower room to complete the layout.

Outside, you'll enjoy the ease of an **allocated parking** space and the convenience of local shops just a short stroll away. So if you've been calling out for a home that delivers comfort, style, and a brilliant Norton location... Moorefields View is ready to answer.

Contact Samuel Makepeace Bespoke Estate Agents!

Ground Floor

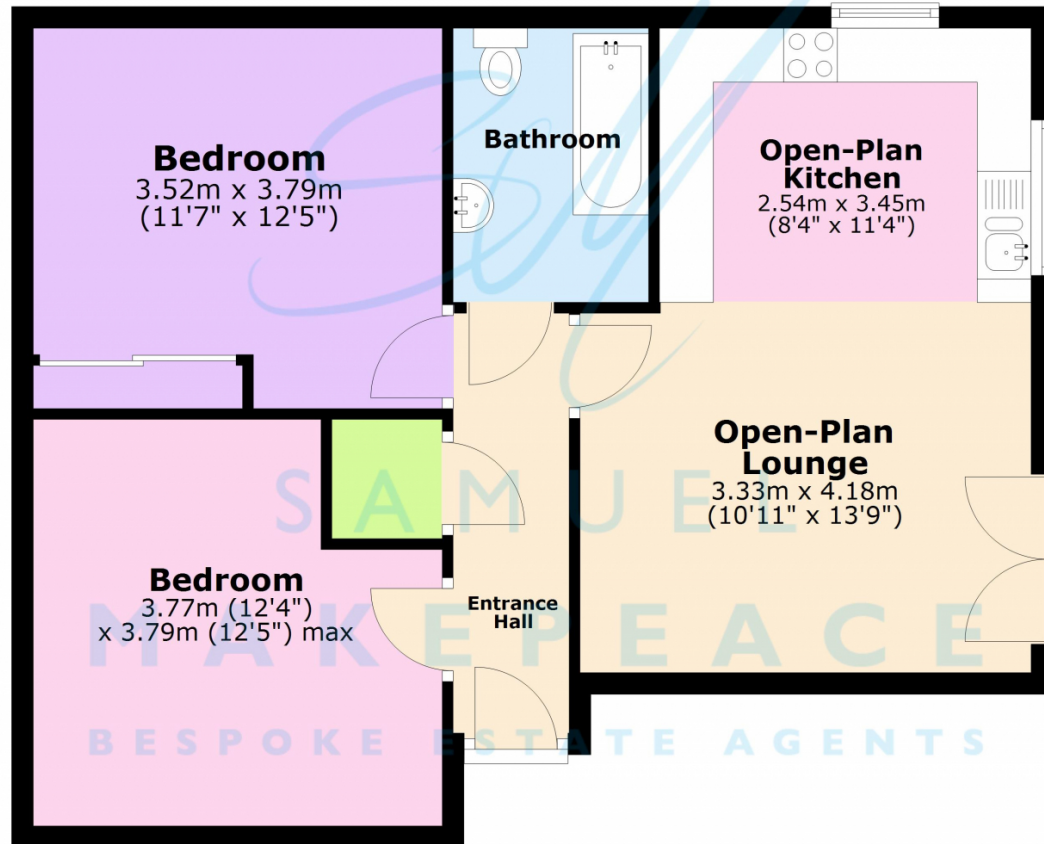

Energy Efficiency Rating		
	Current	Potential
Very energy efficient - lower running costs		
(92+) A		
(81-91) B		
(69-80) C	79	81
(55-68) D		
(39-54) E		
(21-38) F		
(1-20) G		
Not energy efficient - higher running costs		
England, Scotland & Wales		
EU Directive 2002/91/EC		

Address: 45 Moorefields View, ST6

Scan me for more info

