



Connells

Elmridge Court
Emerson Valley Milton Keynes

Elmridge Court

Emerson Valley Milton Keynes MK4 2JJ

for sale
£225,000



Property Description

Connells Oxley Park are delighted to present 16 Elmridge Court to the market, a one-bedroom semi-detached home located in the highly sought-after area of Emerson Valley.

Elmridge Court is arranged over two floors. The ground floor offers a spacious living area and a fitted kitchen, while the first floor boasts a generous double bedroom with an airing cupboard, a bathroom, and convenient access to the loft.

Externally, the home benefits from a front wrap around garden and an allocated parking space.

Emerson Valley provides excellent leisure facilities, including Furzton Lake, Emerson Valley Park, Windmill Hill Golf Club, Milton Keynes Rugby Club, and a selection of local shops. The property is also ideally situated close to Central Milton Keynes shopping centre, Central Milton Keynes railway station, and offers easy access to Junction 13 of the M1 and the A5.

Ground Floor

Lounge

11' 11" x 10' 7" (3.63m x 3.23m)

Side aspect double glazed bay window. Stairs rising to the first floor. Two wall mounted radiators.

Kitchen

8' 9" x 6' 7" (2.67m x 2.01m)

Side aspect double glazed window. Stainless steel sink. Space for appliances and plenty of storage options. Storage cupboard.

First Floor

Landing

Leads to the bedroom, bathroom, and the loft.

Bedroom

12' x 9' (3.66m x 2.74m)

Front and side aspect double glazed windows. Airing cupboard. Wall mounted radiator.

Bathroom

Side aspect double glazed window. Comprises of a wash hand basin, WC and bath. Partly tiled. Wall mounted radiator.

Outside

Front Garden

Wrap around garden mainly laid to lawn.

Parking

One allocated parking space.





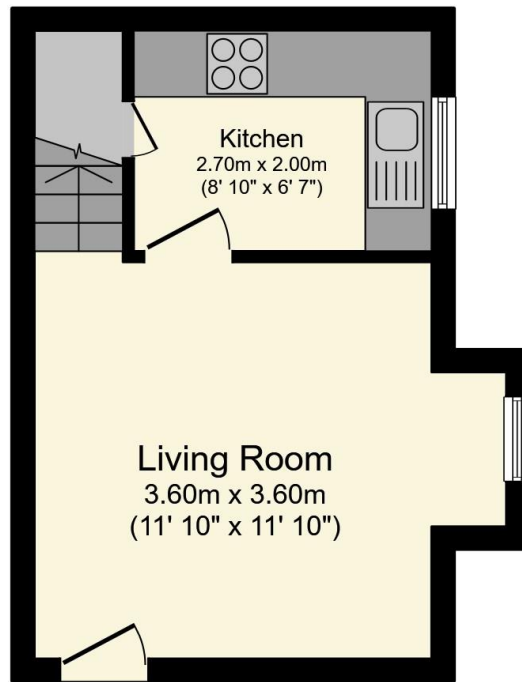

Ground Floor

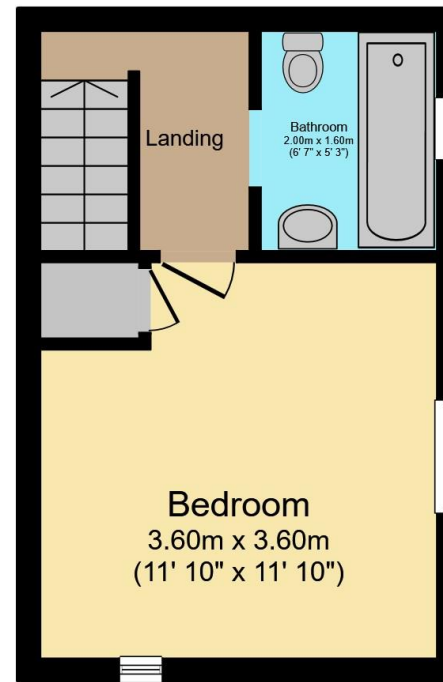

First Floor

Total floor area 42.0 m² (452 sq.ft.) approx

This floor plan is for illustrative purposes only. It is not drawn to scale. Any measurements, floor areas (including any total floor area), openings and orientation are approximate. No details are guaranteed, they cannot be relied upon for any purpose and they do not form part of any agreement. No liability is taken for any error, omission or misstatement. A party must rely upon its own inspection(s). Powered by www.propertybox.io

Connells

To view this property please contact Connells on

T 01908 330751

E oxleypark@connells.co.uk

Unit 10 64 Redgrave Drive Oxley Park
MILTON KEYNES MK4 4TB

EPC Rating: C Council Tax
Band: A

Tenure: Freehold

view this property online connells.co.uk/Property/EXP106655



1. MONEY LAUNDERING REGULATIONS Intending purchasers will be asked to produce identification documentation at a later stage and we would ask for your co-operation in order that there will be no delay in agreeing the sale. 2. These particulars do not constitute part or all of an offer or contract. 3. The measurements indicated are supplied for guidance only and as such must be considered incorrect. Potential buyers are advised to recheck measurements before committing to any expense. 4. We have not tested any apparatus, equipment, fixtures, fittings or services and it is in the buyers interest to check the working condition of any appliances.

Connells Residential is registered in England and Wales under company number 1489613, Registered Office is Cumbria House, 16-20 Hockliffe Street, Leighton Buzzard, Bedfordshire, LU7 1GN. VAT Registration Number is 500 2481 05.

See all our properties at www.connells.co.uk | www.rightmove.co.uk | www.zoopla.co.uk

Property Ref: OXP106655 - 0003