

## Hatton Garden, EC1N

£3,250 Per calendar month

This two bedroom apartment boasts stylish interiors throughout. Situated on a high floor, the apartment benefits from a private balcony with amazing City views.

Jeygrove Court is ideally located on Hatton Garden and close to Farringdon Station with multiple transport links. There are several supermarkets on the door step as well as the many shops and amenities of nearby Chancery Lane

### Features

- Two Bedrooms
- Open Plan Living
- Private Balcony
- Amazing City Views

Hatton Garden,  
London, EC1N

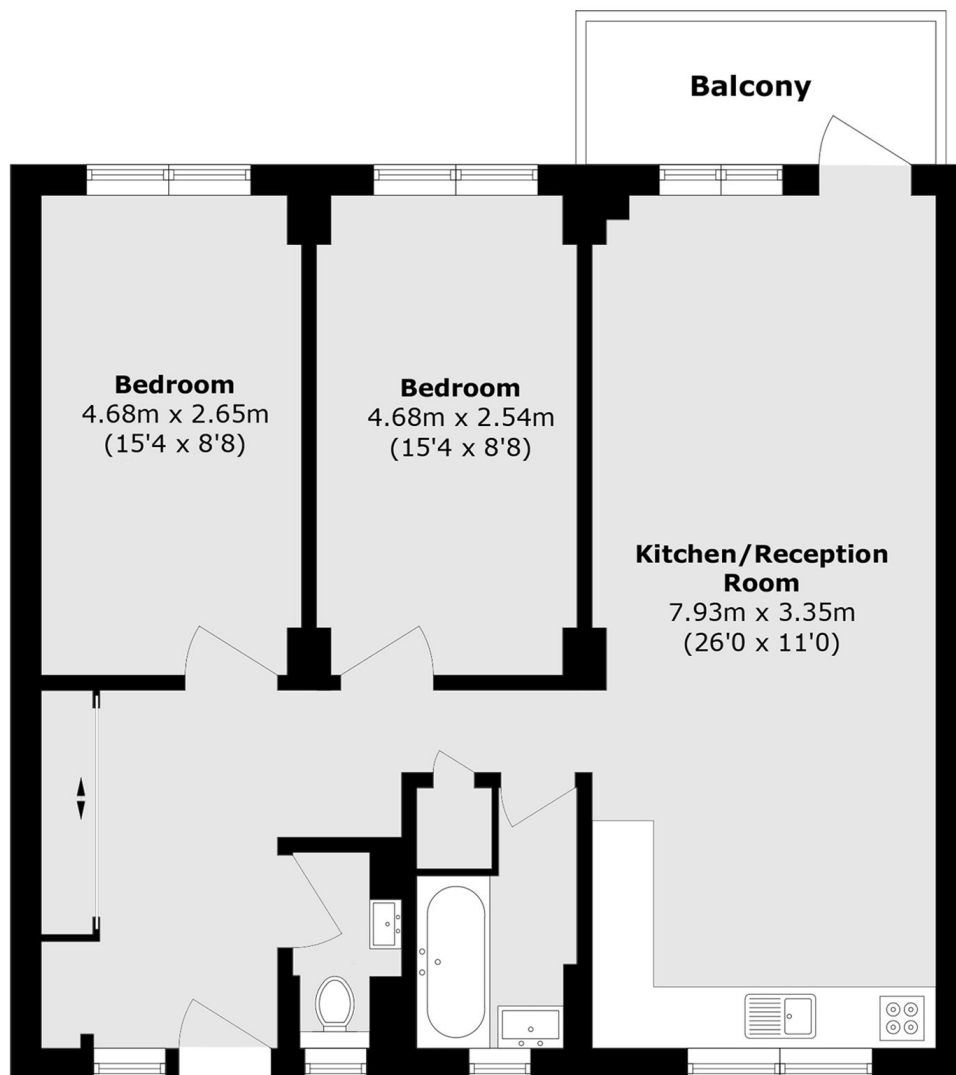

### **Eighth Floor**

Total area (approx.): 72.5 sq. m (780.3 sq. ft)

Balcony area (approx.): 4.7 sq. m (50.5 sq. ft)