

Rounthwaite **R&W** Woodhead

53 MARKET PLACE, MALTON, NORTH YORKSHIRE, YO17 7LX Tel: (01653) 600747

SEPTEMBER COTTAGE GREAT HABTON, MALTON, YO17 6TU



- Pretty village property
- Dining kitchen and good sized living room
- Off street parking
- Two double bedrooms
- Decked seating area
- No forward chain

GUIDE PRICE £200,000

Also at: 26 Market Place, Kirkbymoorside Tel: (01751) 430034 & Market Place, Pickering Tel: (01751) 472800

Email: malton@rounthwaite-woodhead.co.uk www.rounthwaite-woodhead.com

Description

This charming two-bedroom property is set in a popular, well-connected village location. Great Habton is approximately five miles from the market town of Malton and offers all the benefits of rural location with surrounding open countryside and a popular village pub yet is well positioned for access to good road links including those to the coast, York and beyond.

Well-presented and maintained throughout, the accommodation includes a good-sized kitchen which has been thoughtfully fitted with a range of units, integrated appliances and offers ample space for a dining table. The living room is also a great proportioned room and benefits from a multi fuel burner. To the first floor are two bedrooms, both of which are double-sized rooms and a modern bathroom with bath and shower above.

Externally, the benefits include a pretty, decked seating area and off-street parking.

General Information

Council Tax Band B - Registered as holiday cottage

Services - LPG Gas, Mains Drains

Viewing - By appointment, contact Rounthwaite and Woodhead



Accommodation

September Cottage, Great Habton, Malton, YO17

Approximate Area = 678 sq ft / 63 sq m

For identification only - Not to scale

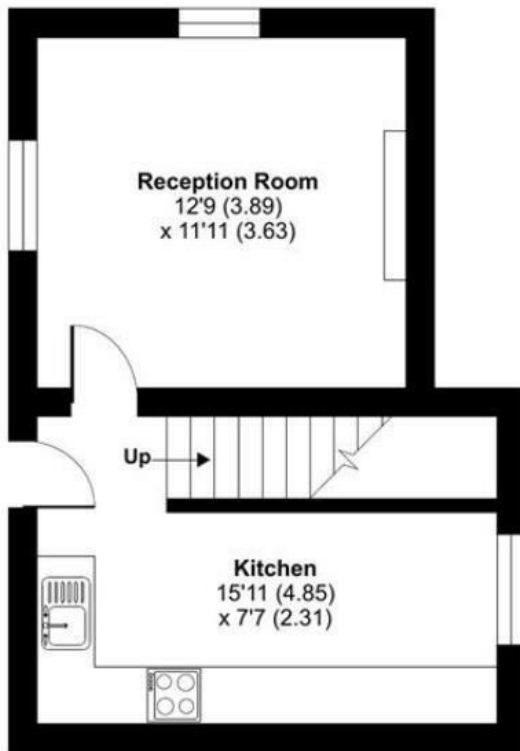

GROUND FLOOR



FIRST FLOOR

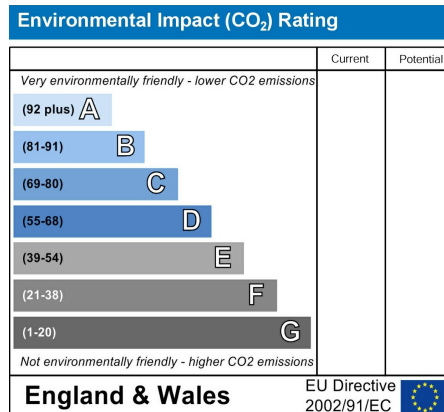
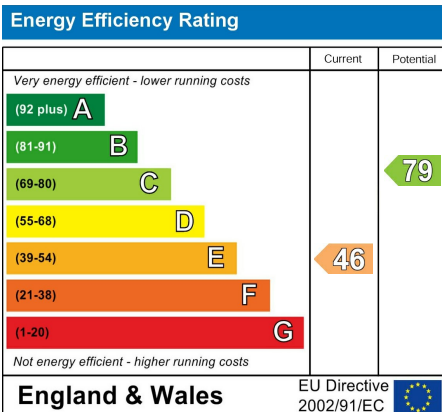



Messrs Rounthwaite & Woodhead for themselves and their vendors and lessors whose agents they are give notice that these particulars are produced in good faith, set out as a general guide only and do not constitute any part of a contract. No person employed by Messrs Rounthwaite & Woodhead has any authority to make or give any representation or warranty whatsoever in relation to this property. The dimensions in the sales particulars are approximate only and the accuracy of any description cannot be guaranteed. Reference to machinery, services and electrical goods does not indicate that they are in good or working order. All reference to prices and rents etc. exclude VAT which may apply in some cases.

Covering Ryedale through offices in Malton, Pickering and Kirkbymoorside
www.rounthwaite-woodhead.com

Rounthwaite **R&W** Woodhead