



**Connells**

Stevenage Road  
Hitchin





## Property Description

Offered to the market on a chain-free basis is this beautifully renovated two bedroom terraced home that has been thoughtfully updated throughout. The ground floor provides excellent living space with a bright separate lounge at the front of the home and a stylish kitchen diner to the rear. The light and airy kitchen diner has French doors that open directly onto the low maintenance, landscaped private rear garden. The first floor accommodation comprises two double bedrooms and a modern family bathroom. This lovely home also benefits from off-street parking for two spaces to the rear.

Hitchin town centre is within walking distance and offers an array of local shops, restaurants and more. This home is an ideal purchase for first-time buyers and offers fantastic transport links into London and Cambridge via the Great Northern Line and the A1(M).

## Ground Floor

Door to front, stairs leading to first floor, herringbone flooring and radiator.

## Lounge

Double glazed bay window to front aspect, herringbone flooring and radiator.

## Kitchen

Fully fitted kitchen with double glazed window to rear aspect, a range of wall and base units, stainless steel sink and drainer, electric Hotpoint oven, hob with cooker hood over, space for fridge/freezer. Understairs storage cupboard housing washing machine. Double glazed patio doors to rear.

## Landing

Loft access.

## Bedroom One

Double glazed window to front aspect, storage cupboard and radiator.

## Bedroom Two

Double glazed window to rear aspect, storage cupboard and radiator.

## Bathroom

Double glazed window to rear aspect, wash hand basin, vanity, bath with shower over, WC, partly tiled, vinyl flooring and heated towel rail.

## Rear Garden

Laid to lawn.

## Agent's Note

The Land Registry title has yet to be updated with the Vendor's details. Please ask the branch for more details.











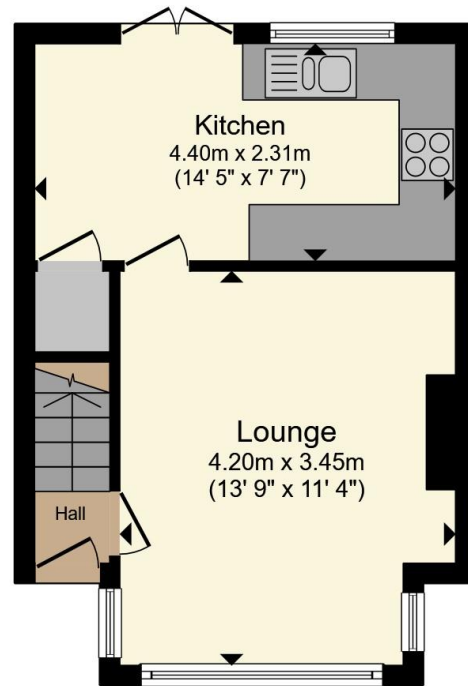

**Ground Floor**

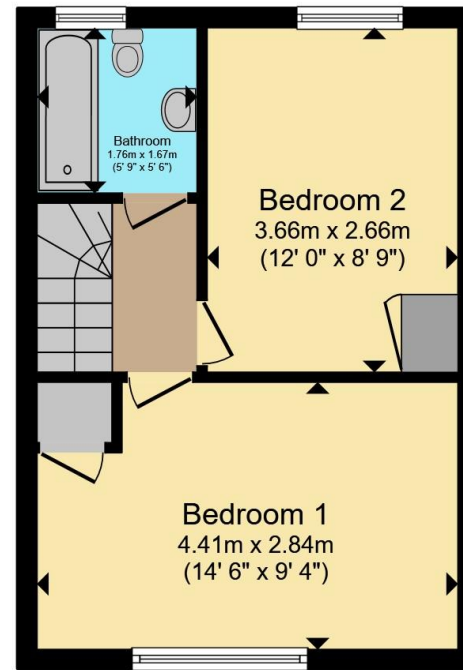

**First Floor**

Total floor area 57.3 m<sup>2</sup> (617 sq.ft.) approx

This floor plan is for illustrative purposes only. It is not drawn to scale. Any measurements, floor areas (including any total floor area), openings and orientation are approximate. No details are guaranteed, they cannot be relied upon for any purpose and they do not form part of any agreement. No liability is taken for any error, omission or misstatement. A party must rely upon its own inspection(s). Powered by [www.propertybox.io](http://www.propertybox.io)

**Connells**

To view this property please contact Connells on

**T 01462 437 666**  
**E [hitchin@connells.co.uk](mailto:hitchin@connells.co.uk)**

14 High Street  
HITCHIN SG5 1AT

EPC Rating: E Council Tax  
Band: C

Tenure: Freehold

**view this property online [connells.co.uk/Property/HIT308403](http://connells.co.uk/Property/HIT308403)**



1. MONEY LAUNDERING REGULATIONS Intending purchasers will be asked to produce identification documentation at a later stage and we would ask for your co-operation in order that there will be no delay in agreeing the sale. 2. These particulars do not constitute part or all of an offer or contract. 3. The measurements indicated are supplied for guidance only and as such must be considered incorrect. Potential buyers are advised to recheck measurements before committing to any expense. 4. We have not tested any apparatus, equipment, fixtures, fittings or services and it is in the buyers interest to check the working condition of any appliances.

Connells Residential is registered in England and Wales under company number 1489613, Registered Office is Cumbria House, 16-20 Hockliffe Street, Leighton Buzzard, Bedfordshire, LU7 1GN. VAT Registration Number is 500 2481 05.

**See all our properties at [www.connells.co.uk](http://www.connells.co.uk) | [www.rightmove.co.uk](http://www.rightmove.co.uk) | [www.zoopla.co.uk](http://www.zoopla.co.uk)**

Property Ref: HIT308403 - 0004