



£1,500 pcm  
Charcot Road, Colindale



1

Bedroom



1

Bathroom

211 Edgware Rd, London, NW9 6LP |  
colindale@warrenbradleystates.co.uk

020 8200 7007

£1,500 pcm  
Charcot Road, Colindale



**Warren Bradley Estates are pleased to offer for rent this spacious studio/ 1 bedroom apartment with a seperate bedroom.**

**Located on the fourth floor with lift access, this property is situated in the popular Pulse Development, close to Colindale tube station.**

**Benefitting from a large separate sleeping area, fully fitted kitchen with fridge/freezer, washing machine, oven and dishwasher, a fully tiled bathroom double glazing and an allocated parking space.**

**Offered furnished the property is available now.**



### Crawford Court

Approx. 34.6 sq. metres (372.9 sq. feet)

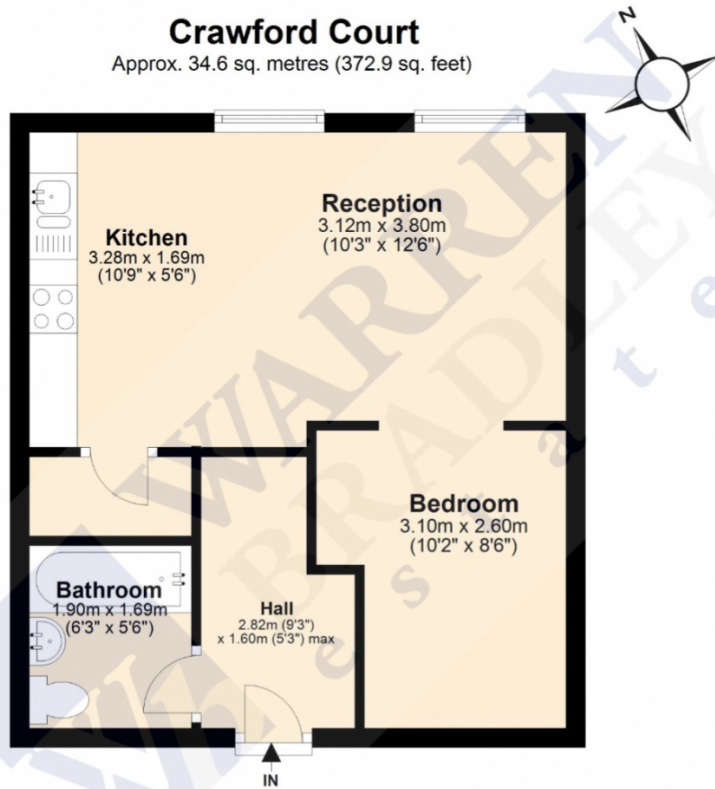

Disclaimer: Please note this floor plan is for marketing purposes and is to be used as a guide only.  
Plan produced using PlanUp.

Energy Efficiency Rating		Current	Potential
Very energy efficient - lower running costs			
(92-100) <b>A</b>			
(81-91) <b>B</b>		83	83
(69-80) <b>C</b>			
(55-68) <b>D</b>			
(39-54) <b>E</b>			
(21-38) <b>F</b>			
(1-20) <b>G</b>			
Not energy efficient - higher running costs			
England, Scotland & Wales		EU Directive 2002/91/EC	

Environmental Impact (CO <sub>2</sub> ) Rating		Current	Potential
Very environmentally friendly - lower CO <sub>2</sub> emissions			
(92-100) <b>A</b>		97	97
(81-91) <b>B</b>			
(69-80) <b>C</b>			
(55-68) <b>D</b>			
(39-54) <b>E</b>			
(21-38) <b>F</b>			
(1-20) <b>G</b>			
Not environmentally friendly - higher CO <sub>2</sub> emissions			
England, Scotland & Wales		EU Directive 2002/91/EC	

