



The Crossways, Coulsdon, CR5 1LF

Guide Price **£525,000**

- THREE BEDROOM SEMI- DETACHED PROPERTY
- REAR EXTENSION TO THE KITCHEN
- DRIVEWAY FOR MULTIPLE VEHICLES
- LARGE EXTENDED GARDEN
- COUNCIL TAX BAND - D

- MODERNISATION AND RENNOVATION POTENTIAL
- FAMILY BATHROOM
- GAS CENTRAL HEATING
- EPC -

Bedrooms: 3 | Bathrooms: 1 | Receptions: 1

Property Type: Semi Detached House

**Approximate Gross Internal Area 909 sq ft - 85 sq m
(Excluding Garage)**

Ground Floor Area 536 sq ft – 50 sq m

First Floor Area 373 sq ft – 35 sq m

Garage Area 142 sq ft – 13 sq m

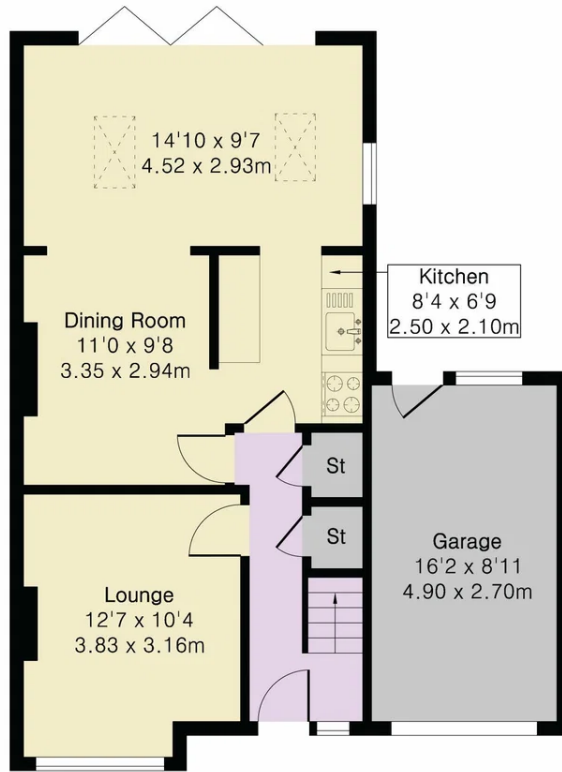

Ground Floor

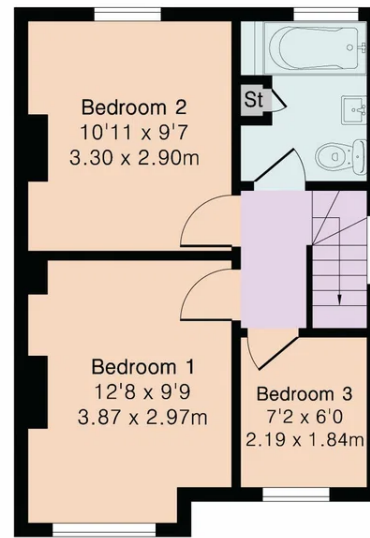

First Floor



Floor plan produced in accordance with RICS Property Measurement 2nd Edition. Although Pink Plan Ltd ensures the highest level of accuracy, measurements of doors, windows and rooms are approximate and no responsibility is taken for error, omission or misstatement. These plans are for representation purposes only and no guarantee is given on the total square footage of the property within this plan. The figure icon is for initial guidance only and should not be relied on as a basis of valuation.



John Brown & Mark Youll - Sales

105 Coulsdon Road, Old Coulsdon, Surrey CR5 1EH

01737 551111 | hello@johnbrownmarkyoull.co.uk | <https://www.johnbrownmarkyoull.co.uk/>