



CUTTER LANE, SE10

£450,000

Modern apartment
Two double bedrooms
Private balcony
Large communal roof terrace
Overlooking the O2
Energy rating: b

@marshandparsons
marshandparsons.co.uk

MARSH &
PARSONS



ABOUT THE PROPERTY

A beautifully presented fifth floor modern apartment, located next to the river Thames and overlooking the world famous O2 centre. Inside the apartment, you will find a very bright and airy living room, an open plan kitchen, two double bedrooms, one of which benefits from a tall fitted wardrobe and the former, direct access to a private balcony, directly overlooking the O2 centre with beautiful river views and a modern bathroom suite.

North Greenwich tube station, which is on the Jubilee line is moments away on foot. The cable cars at Greenwich Peninsula is just moments away too and buses are frequent from the O2 transporting commuters into local areas and towards central London.



STEP INSIDE CUTTER LANE

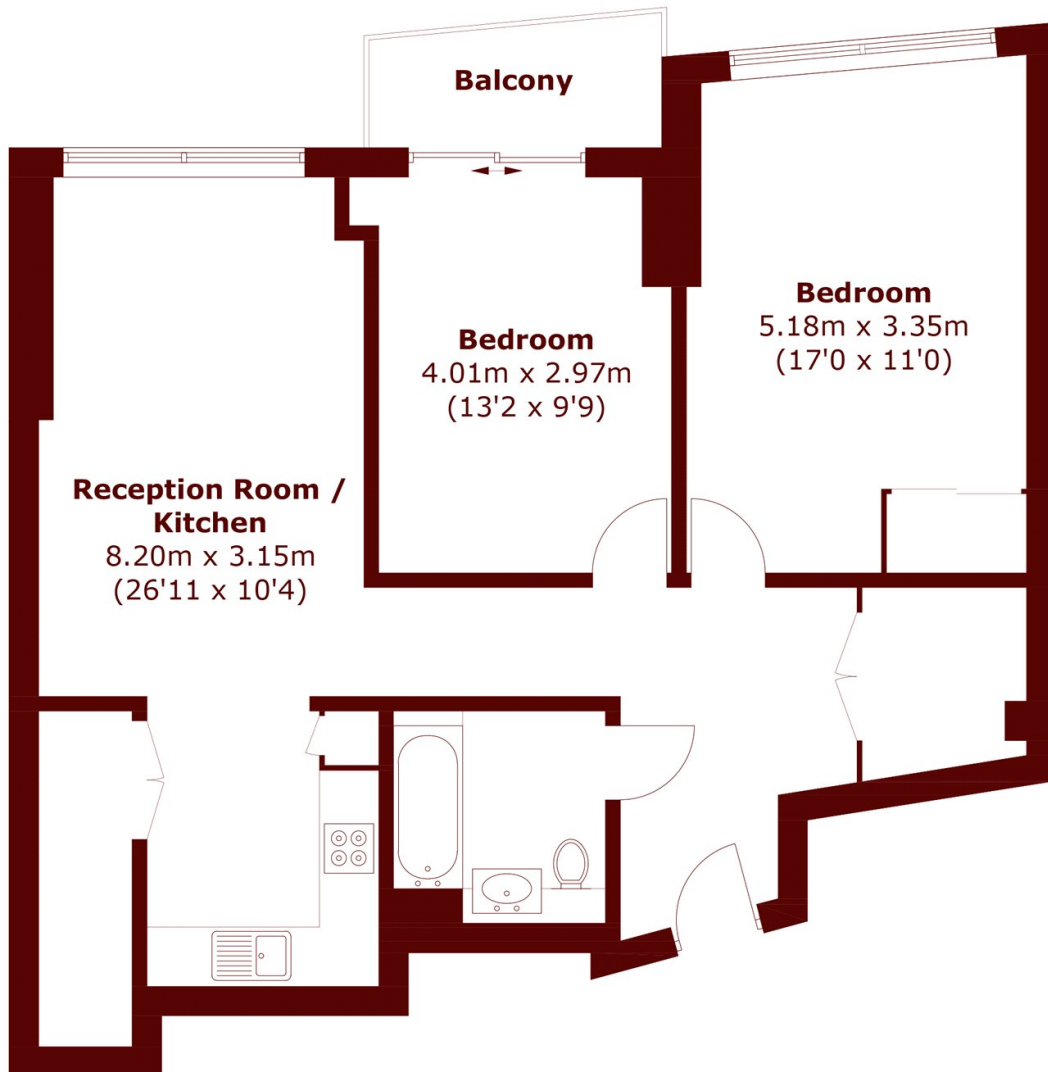

Approx Internal Area: 77.7 sq. m (836.0 sq. ft)

Balcony: 3.6 sq. m (38.7 sq. ft)

Greenwich
020 8312 8312

Energy Rating: B We aim to make our particulars both accurate and reliable. However, they are not guaranteed; nor do they form part of an offer or contract. If you require clarification on any points then please contact us, especially if you're traveling some distance to view. Please note that appliances and heating systems have not been tested and therefore no warranties can be given as to their good working order

**MARSH &
PARSONS**