



# 52 HOWE PARK

Swanston, Edinburgh, EH10 7HG



2

Public Room



3

Bedrooms



1

Bathroom



## 52 HOWE PARK

This spacious three-bedroom family home enjoys a tranquil residential setting on the southern fringes of Edinburgh, boasting stunning views towards the Pentland Hills and lying just a 20-minute commute from the city centre, with convenient proximity to the City Bypass. The modern semi-detached house is presented in tasteful neutral tones and benefits from a desirable south-facing rear aspect, enjoyed from the interconnected living/dining room, conservatory, and well-appointed kitchen, as well as the attractive enclosed rear garden, which features a summer house and shed. A further garden lies to the front, alongside a generous private driveway providing ample off-street parking.





C  
EPC  
RATING

E  
COUNCIL  
TAX BAND

**VIEWING**  
By appointment only  
with Gilson Gray on  
**0131 516 5366**

## Features

- Tranquil setting with Pentland Hill views
- Tasteful neutral interiors with a south-facing rear aspect
- Spacious semi-detached family home
- Entrance hall
- Generous living/dining room connected to:
- Multi-use conservatory
- Stylish, well-appointed kitchen with access to the reception space and garden
- Two double bedrooms with fitted storage
- One well-proportioned single bedroom
- Bright bathroom with shower-over-bath
- Attractive gardens, secure to the rear with a summer house and shed
- Generous private driveway









Extras: All fitted floor coverings, window coverings, and light fittings are included in the sale.



# SWANSTON, EDINBURGH

Swanston is an established residential area situated just a few miles south of Edinburgh city centre. The area benefits from good local amenities in the vicinity, including shops, a bank, and a Post Office, while larger supermarkets can be found a short drive away. Fairmilehead and Colinton Mains Public Parks are both nearby and offer lovely green areas for walking or picnics. The Pentland Hills, located less than a mile away, offer a snowsports centre, outstanding walking and cycling trails, and pony trekking. For the golf enthusiast, there are a number of courses in the area, including Swanston Golf Club, Mortonhall Golf Club, and Baberton Golf Club. Swanston falls within the catchment area for the highly regarded primary and secondary schools. It is also well located for access to Napier University and the prestigious George Watson's and George Heriot's schools. The area enjoys a good public transport system with regular buses to the city centre, and with the close proximity of the City Bypass, commuting by car couldn't be easier.

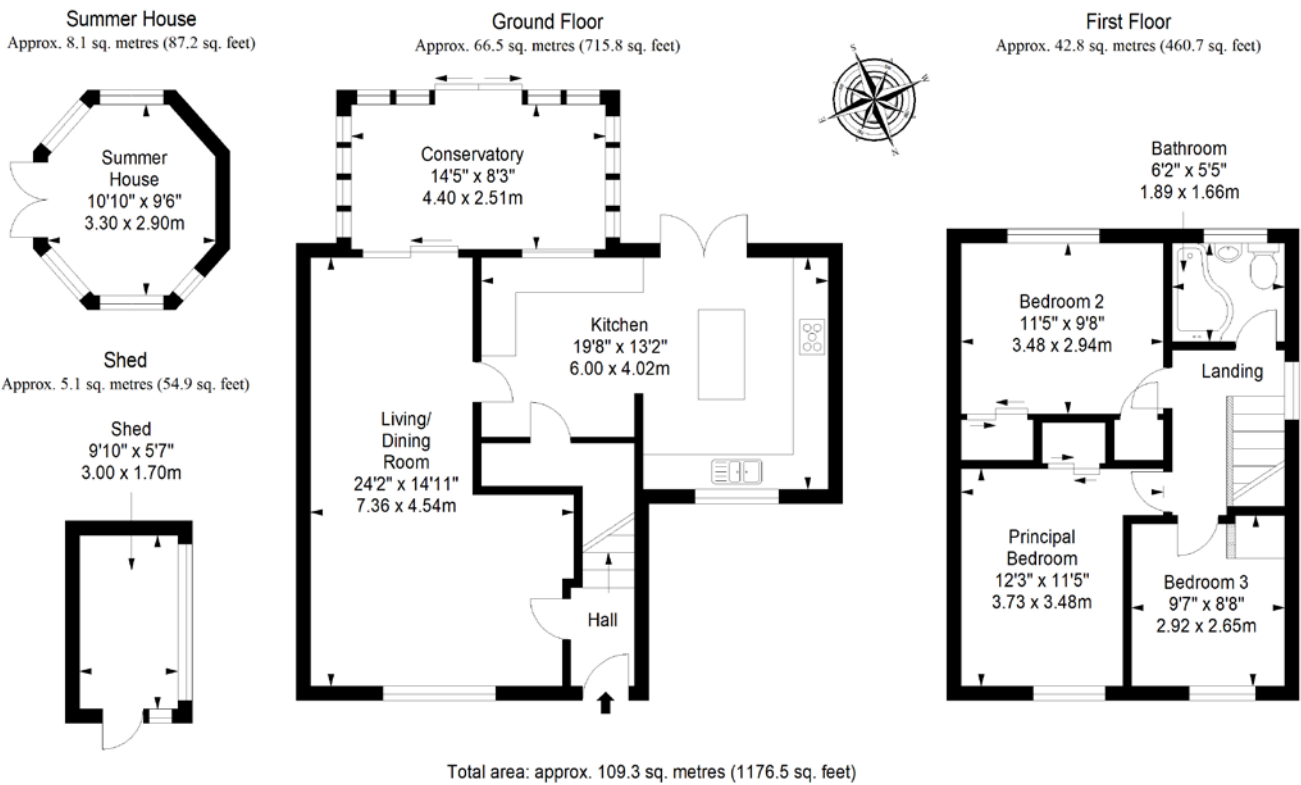

@gilsongrayprop gilson gray property gilson gray property @gilsongrayprop



These particulars were prepared on the basis of our own knowledge of the local area and, in respect of the property itself, information supplied to us by our clients; all reasonable steps were taken at the time of preparing these particulars to ensure that all details contained in them were accurate. All statements contained in the particulars are for information only and all parties should not rely upon them as statements or representations of fact. In particular, (a) descriptions, measurements and dimensions, which may be quoted in these particulars are approximate only and (b) all references to conditions, planning permission, services, usage, constructions, fixtures and fittings and movable items contained in the property are for guidance only. Our clients may instruct us to set a closing date for offers at short notice and therefore if you wish to pursue interest in this property, you should immediately instruct your solicitor to note interest with us. Our clients reserve the right to conclude a bargain for the sale of the above subjects or any part thereof ahead of a notified closing date and will not be obliged to accept either the highest or indeed any offer for the above subjects or any part thereof. All measurements have been taken using a sonic tape and cannot be regarded as guaranteed given the limitations of the device. Services and/or appliances referred to in these particulars have not been tested and no warranty is given that they are in full working order.